

MAP
ANNEXATION AN09-005
11.457 acres in Prairie Township
James M. Phillippi et al 5 and James Phillippi Trust

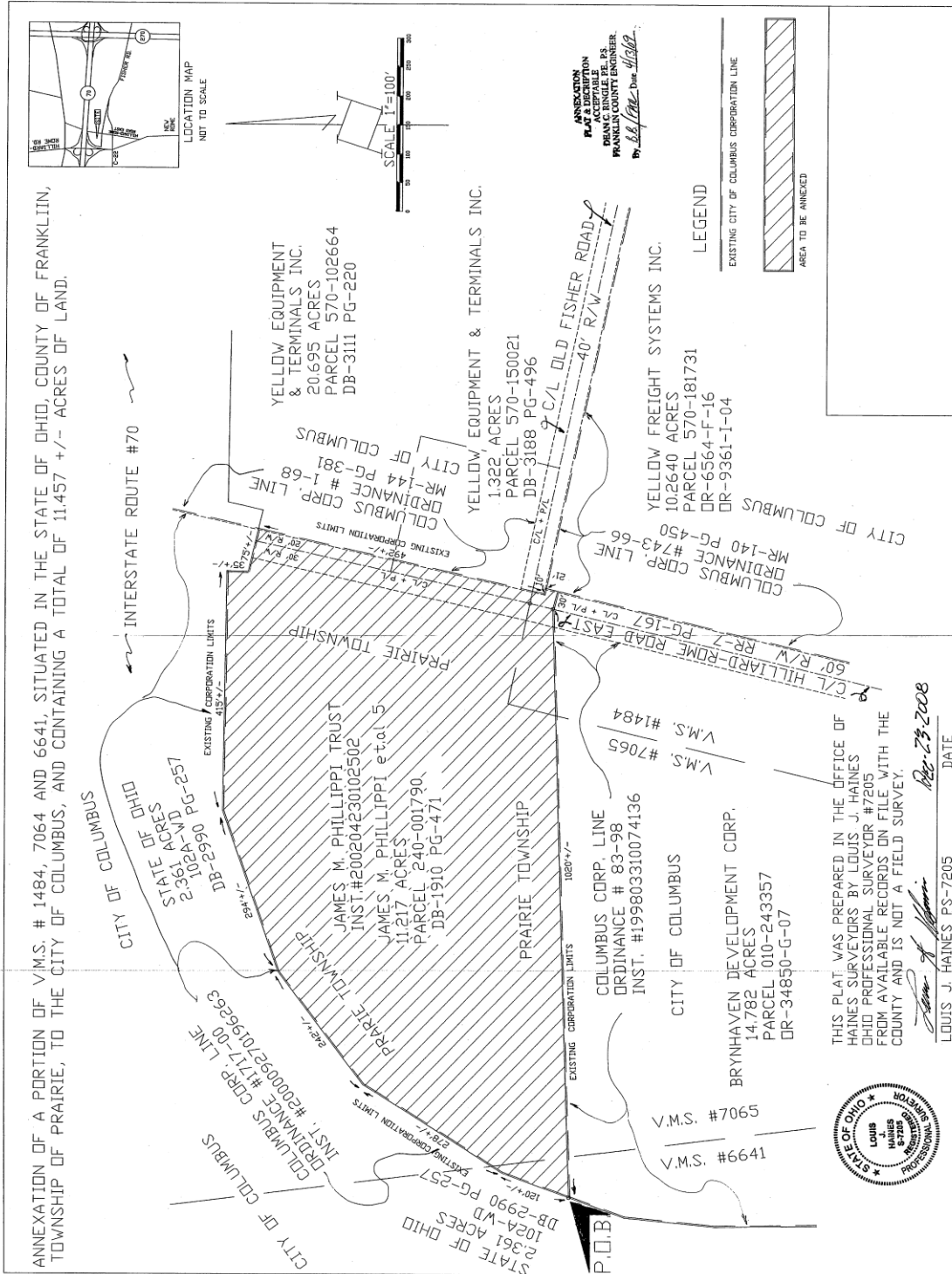

ANNEXATION OF A PORTION OF V.M.S. # 1484, 7064 AND 6641, SITUATED IN THE STATE OF OHIO, COUNTY OF FRANKLIN, TOWNSHIP OF PRAIRIE, TO THE CITY OF COLUMBUS, AND CONTAINING A TOTAL OF 11.457 +/- ACRES OF LAND.

**ANNEXATION
 PLAN & DESCRIPTION
 PREPARED BY
 LOUIS J. HAINES
 PRAIRIE COUNTY ENGINEER
 By *L. J. Haines* Date *11/23/08***

THIS PLAT WAS PREPARED IN THE OFFICE OF HAINES SURVEYORS BY LOUIS J. HAINES, OHIO PROFESSIONAL SURVEYOR #7205. FROM AVAILABLE RECORDS ON FILE WITH THE COUNTY AND IS NOT A FIELD SURVEY.

L. J. Haines **11/23/2008**
 LOUIS J. HAINES PS-7205 DATE

