

MAP ANNEXATION AN05-003 1.219 Acres in Perry Township Friendship Village of Dublin, Ohio, Inc.

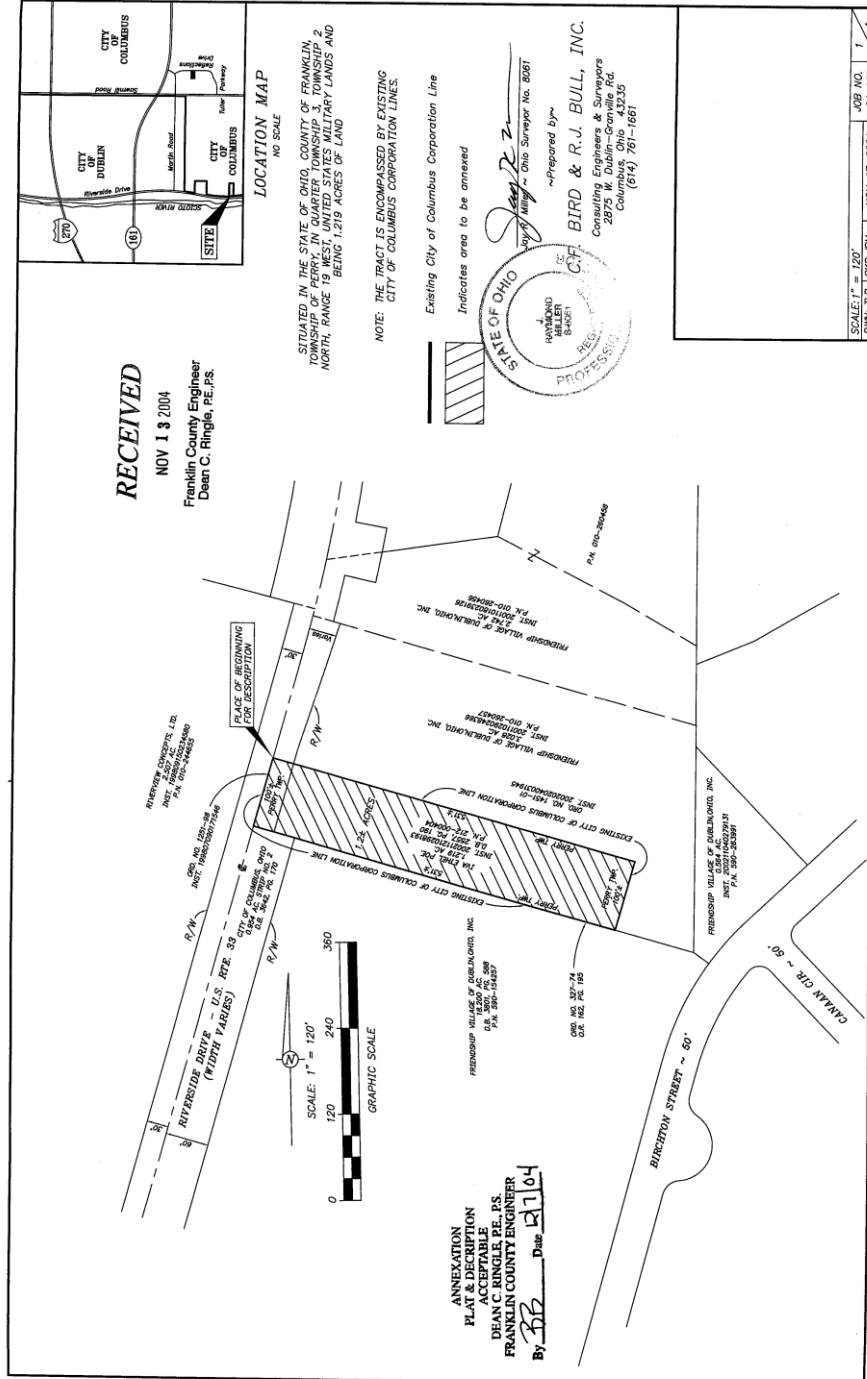

RECEIVED
NOV 13 2004
Franklin County Engineer
Dean C. Ringle, P.E., P.S.

LOCATION MAP
NO SCALE
SITUATED IN THE STATE OF OHIO, COUNTY OF FRANKLIN, TOWNSHIP OF PERRY, RANGES 19 WEST, UNITED STATES MILITARY LANDS AND BEING 1.219 ACRES OF LAND

NOTE: THE TRACT IS DISCOMPASSED BY EXISTING CITY OF COLUMBUS CORPORATION LINES.

Existing City of Columbus Corporation Line

Indicates area to be annexed

STATE OF OHIO
HARMOND MILLER
REGISTERED PROFESSIONAL SURVEYOR
No. 8067
Prepared by:
C.T. BIRD & R.J. BULL, INC.
Consulting Engineers & Surveyors
2875 W. Dublin-Granville Rd.
Columbus, Ohio 43235
(614) 741-1661

SCALE: 1" = 120'	JOB NO. 04-137
DWG. T.R. LCKD-RM	NOV. 17, 2004
	1