

Tract 1
Released Easement Area: 0.0524 Acre +/-

Situated in the State of Ohio, County of Franklin, City of Columbus, located in Section 13, Township 11, Range 21, Congress Lands, being a portion of a 0.145 acre sanitary easement consisting of Two (2) strips through an original 63.576 acre tract of land deeded to Henrietta L. Pfeifer in Instrument #200111020253526, said sanitary easement being more particularly bounded and described as follows:

Beginning in an easterly line of said original 63.576 acre tract, in a westerly line of an original 60.00 acre tract deeded to Tiger Construction, Inc. in Instrument #200008070156831, said point being N 04°07'10" E a distance of 90.24 feet from a southeast corner of said original 63.576 acre tract, a northwest corner of said original 60.00 acre tract, said point also being the **TRUE PLACE OF BEGINNING** for Strip 1 of the easement herein to be described;

Thence across and through said original 63.576 acre tract the following five (5) courses and distances:

N 49° 09' 21" W a distance of 156.56 feet to a point;
N 04° 06' 10" E a distance of 8.76 feet to a point on a proposed parcel split line;
S 85° 53' 50" E along said proposed parcel split line a distance of 15.00 feet to a point;
S 04° 06' 10" W leaving said proposed parcel split line a distance of 1.24 feet to a point;
S 49° 09' 21" E a distance of 137.85 feet to a point in a westerly line said original 60.00 acre tract;
Thence S 04° 07' 10" W a distance of 18.71 feet to the **TRUE PLACE OF BEGINNING** for Strip I.

This release is all of Strip I as the same is depicted and described in Instrument number 200511070234537 Recorder's Office, Franklin County, Ohio.

Tract 2
Released Easement Area: 0.019 Acre +/-

Situated in the State of Ohio, County of Franklin, City of Columbus, Northeast Quarter of Section 13, Township 11, Range 21, Congress Lands, being in a 15.751 acre tract in the name of The Greene II, Ltd, as described in IN. 201405270065192, and being part of a 15-foot wide sanitary sewer easement in the name of City of Columbus as described in IN. 200511070234564, all records contained herein are recorded at the Recorder's Office, Franklin County, Ohio, and being more particularly described as follows:

Beginning for reference at a southerly corner of a 14.311 acre tract in the name of The Greene II, Ltd, as described in IN. 201405270065193 being South 85°51'40" East, with the southerly line of said 14.311 acre tract a distance of 331.77 feet from the easterly right of way line of Gender Road;

Thence North 04°08'20" East, a distance of 90.24 feet to the southerly line of an existing City of Columbus sanitary sewer easement as shown of record in IN. 200511070234537 being the **True Place of Beginning** for the tract herein being described;

Thence North 04°08'20" East, continuing with said southerly line a distance of 18.71 feet;

Thence through said 15.751 acre tract the following 4 courses:

1. South 49°08'11" East, along the northerly line of said sanitary sewer easement a distance of 55.05 feet;
2. South 02°24'52" West, through said sanitary sewer easement a distance of 19.15 feet;
3. North 49°08'11" West, with the southerly line of said sanitary sewer easement a distance of 55.77 feet to the **True Place of Beginning**, containing 0.019 acres more or less.

This legal description of the Released Easement Area is depicted on the one (1) page attachment, **Exhibit-A**.

Tract 3
Released Easement Area: 0.096 Acre +/-

Situated in the State of Ohio, County of Franklin, City of Columbus, Northeast Quarter of Section 13, Township 11, Range 21, Congress Lands, being part in a 14.311 acre tract in the name of The Greene II, Ltd, as described in IN. 201405270065193, and being part of a 25-foot wide sanitary sewer easement in the name of City of Columbus as described in IN. 200611130226621, all records contained herein are recorded at the Recorder's Office, Franklin County, Ohio, and being more particularly described as follows:

Beginning for reference at the southwesterly corner of a 3.369 acre tract in the name of GBS, Gender LLC as described in IN. 201107250091730;

Thence South 85°54'42" East with the southerly line of said 3.369 acre tract, a distance of 309.29 feet to the northeasterly corner of an existing 25' sanitary sewer easement as described in IN. 200611130226621;

Thence through said 14.311 acre tract with the easterly line of said sanitary sewer easement the following 2 courses:

1. South 02°35'06" West, a distance of 103.30 feet to a point;
2. South 02°33'27" East, a distance of 60.70 feet to the **True Place of Beginning**, for the tract herein being described;

Thence continuing through said 14.311 acre tract with the easterly line of said sanitary sewer easement the following 2 courses:

1. South 02°33'27" East, a distance of 19.10 feet;
2. South 04°05'18" West, a distance of 158.70 feet to the northerly line of an existing sanitary sewer as described in IN. 200511070234537;

Thence North 49°10'13" West, with the northerly line of said sanitary sewer a distance of 31.20 feet to a point;

Thence through said 14.311 acre tract with the westerly line of said sanitary sewer easement the following 2 courses:

1. North 04°05'18" East, a distance of 138.58 feet;
2. North 02°33'27" West, a distance of 17.65 feet;

Thence North 87°26'33" East through said 14.311 acre tract and through said existing 25' sanitary sewer easement a distance of 25.00 feet to the **True Place of Beginning**, containing 0.096 acres more or less.

This legal description of the Released Easement Area is depicted on the one (1) page attachment, **Exhibit-B**.

EXHIBIT-A (Pg. 1/1)

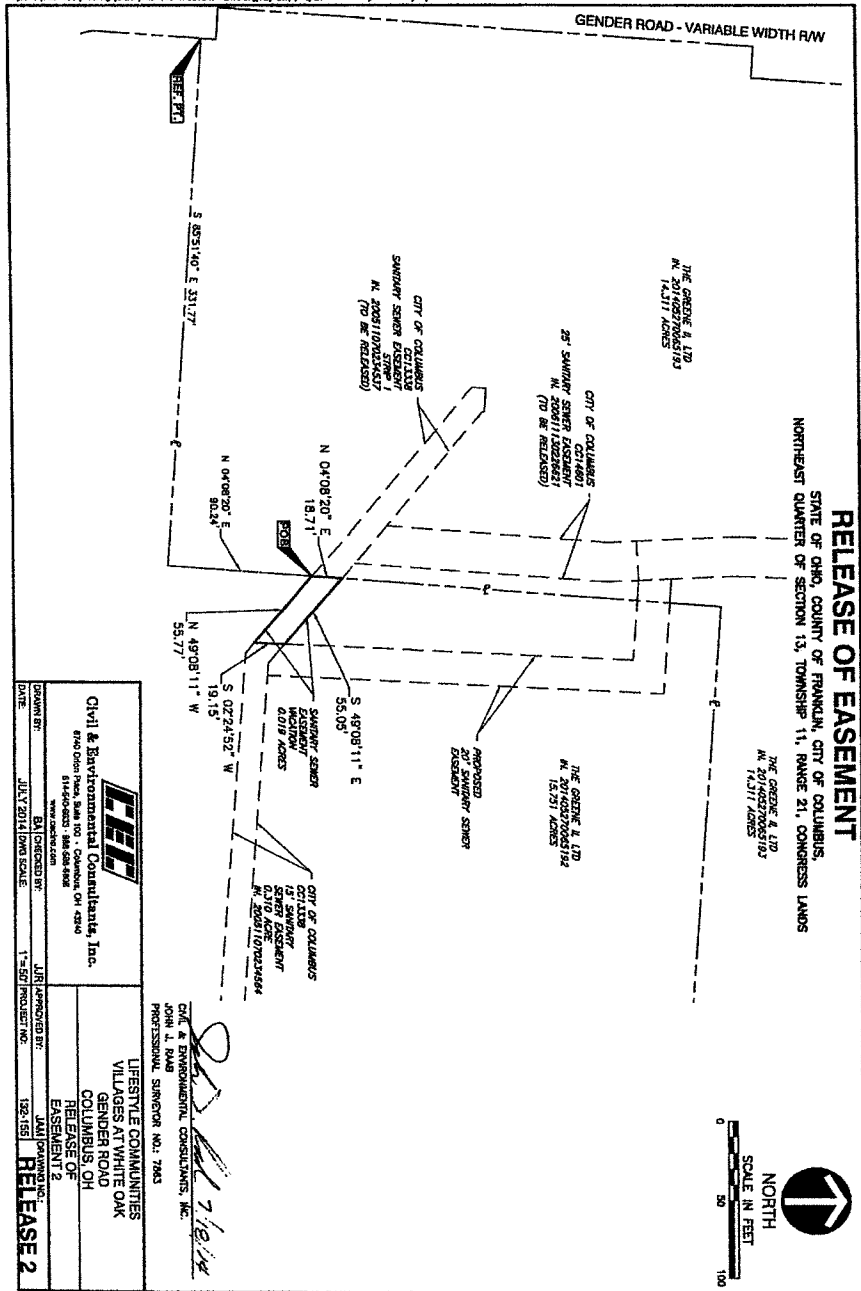

CEFC
Civil & Environmental Consultants, Inc.
 6740 Oak Park, Suite 100, Columbus, OH 43240
 614-462-2222 FAX 614-462-2222

DATE: JULY 2011 DRAWN SCALE: 1"=50' PROJECT NO.: 132-155

PROJECT NO.: 132-155
 DATE: JULY 2011
 SCALE: 1"=50'

DATE: JULY 2011
 SCALE: 1"=50'

DATE: JULY 2011
 SCALE: 1"=50'

[Signature]
 JOHN L. VAND
 PROFESSIONAL SURVEYOR NO. 7263

Civil & Environmental Consultants, Inc.
 LIFESTYLE COMMUNITIES
 VILLAGES AT WHITE OAK
 GENDER ROAD
 COLUMBUS, OH
 RELEASE OF
 EASEMENT 2

EXHIBIT-B (Pg. 1/1)

