

# MAP

## ANNEXATION AN06-007

### 1.4 Acres in Jefferson Township

### Annis L. Brake

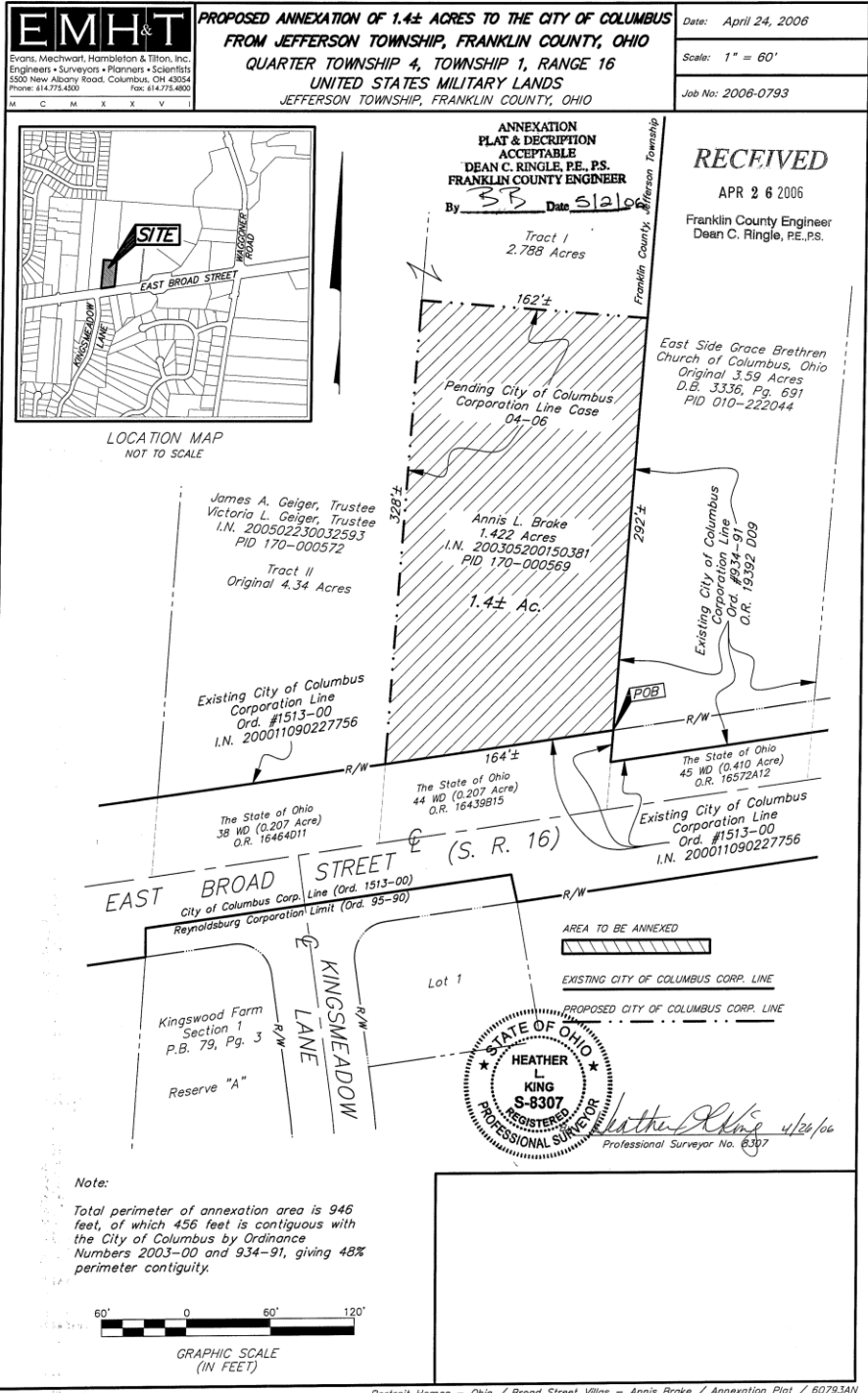

**Note:**

Total perimeter of annexation area is 946 feet, of which 456 feet is contiguous with the City of Columbus by Ordinance Numbers 2003-00 and 934-91, giving 48% perimeter contiguity.

GRAPHIC SCALE  
(IN FEET)

Professional Surveyor No. 8307