



LOCATION MAP

No Scale



ANNEXATION 1" = 150'
PLAT & DESCRIPTION
ACCEPTABLE

CORNELL R. ROBERTSON, P.E., P.S.
FRANKLIN COUNTY ENGINEER

By FR Date 4/12/18

19.24± Ac.

Length of Contiguity: ±872.0 feet
Total Length of Perimeter: ±4545.2 feet
Percentage of Contiguity : ±19.2%

No islands of township property are created by this annexation.

19.24± ACRE ANNEXATION
FROM THE TOWNSHIP OF
PERRY TO THE CITY OF
COLUMBUS

Township of Perry,
Franklin County, Ohio
Quarter Township 3, Township 2
Range 19, U.S.M.L.

Legend



Area to be Annexed



Existing City of Columbus Corp Line



Proposed City of Columbus Corp Line

TPOB

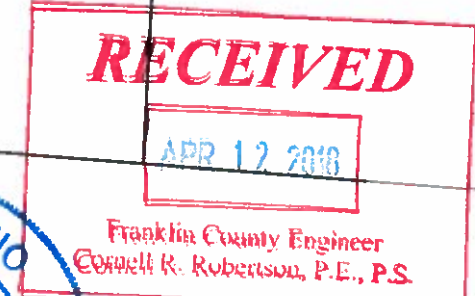
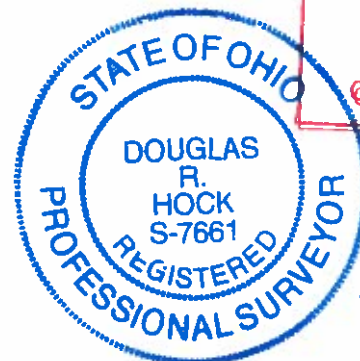

Douglas R. Hock, P.S. 7661 Date: 4/12/18
Advanced Civil Design, Inc
422 Beecher Road
Gahanna, OH 43230
Phone 614-428-7750
Job No.: 17-0027-149
Date: 4/12/2018

