

# MAP ANNEXATION AN04-009 55.9 Acres in Prairie Township Cypress Wesleyan Church

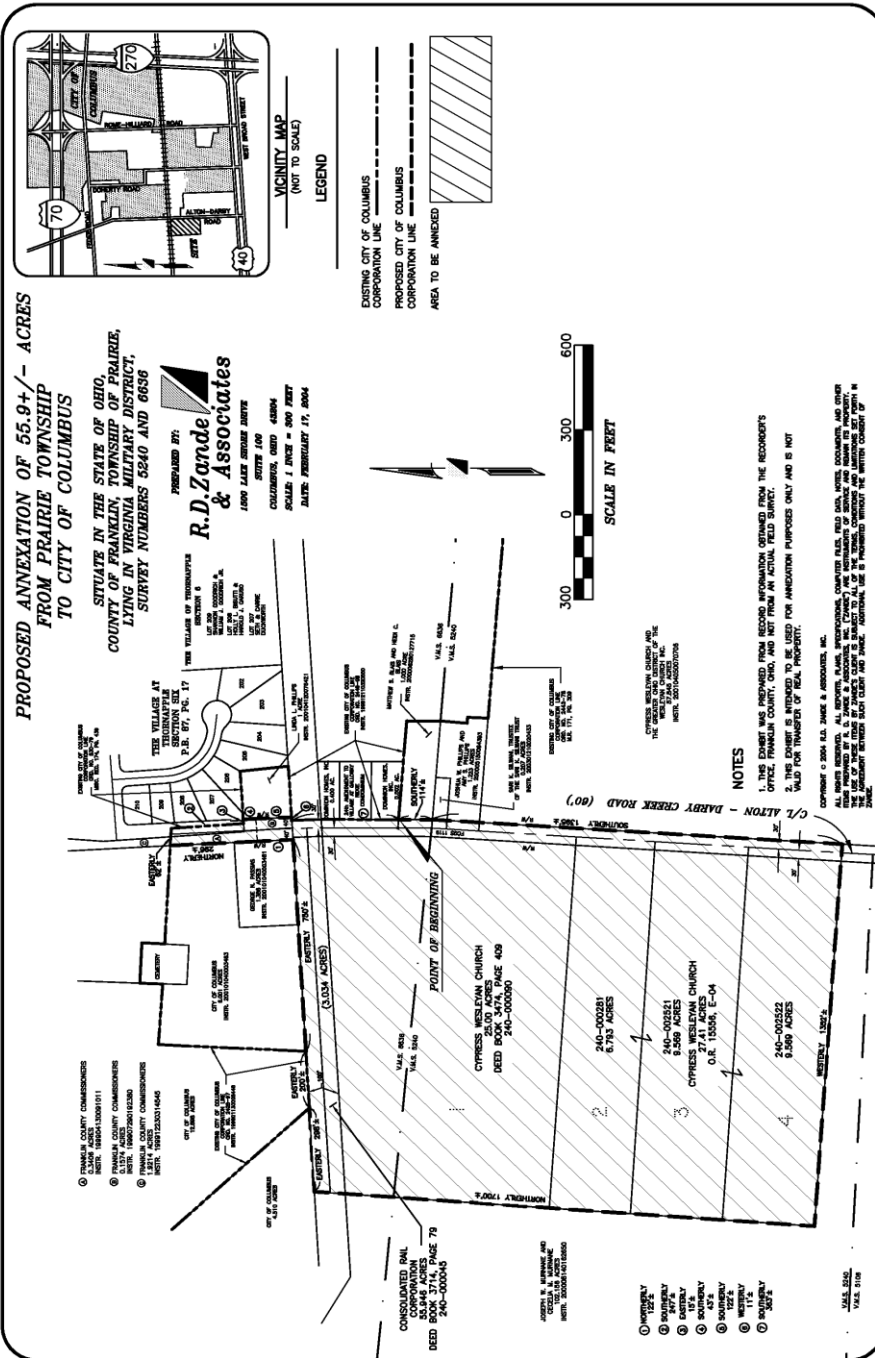

**PROPOSED ANNEXATION OF 55.9+/- ACRES  
FROM PRAIRIE TOWNSHIP  
TO CITY OF COLUMBUS**

SITUATE IN THE STATE OF OHIO,  
 COUNTY OF FRANKLIN, TOWNSHIP OF PRAIRIE,  
 LYING IN VIRGINIA MILITARY DISTRICT,  
 SURVEY NUMBERS 6240 AND 6639

**R.D. Zande & Associates**  
 PREPARED BY:  
 1800 LAKE SHELBOURNE DRIVE  
 SUITE 100  
 COLUMBUS, OHIO 43240  
 SCALE: 1 INCH = 200 FEET  
 DATE: FEBRUARY 17, 2004



**NOTES**  
 1. THIS EXHIBIT WAS PREPARED FROM RECORD INFORMATION OBTAINED FROM THE RECORDER'S OFFICE, FRANKLIN COUNTY, OHIO, AND NOT FROM AN ACTUAL FIELD SURVEY.  
 2. THIS EXHIBIT IS INTENDED TO BE USED FOR ANNEXATION PURPOSES ONLY AND IS NOT VALID FOR PURPOSES OF REAL PROPERTY.

COPYRIGHT © 2004 R.D. ZANDE & ASSOCIATES, INC.  
 ALL RIGHTS RESERVED. ALL RIGHTS, PLANS, SPECIFICATIONS, COMPUTED PLATS, FIELD BOOKS, DOCUMENTS, AND OTHER INFORMATION ARE THE PROPERTY OF R.D. ZANDE & ASSOCIATES, INC. NO PART OF THIS EXHIBIT MAY BE REPRODUCED OR TRANSMITTED IN ANY FORM OR BY ANY MEANS, ELECTRONIC OR MECHANICAL, INCLUDING PHOTOCOPYING, RECORDING, OR BY ANY INFORMATION STORAGE AND RETRIEVAL SYSTEM, WITHOUT THE WRITTEN CONSENT OF R.D. ZANDE & ASSOCIATES, INC.

FRANKLIN COUNTY COMMISSIONERS  
 MET: FEBRUARY 12, 2004  
 FRANKLIN COUNTY COMMISSIONERS  
 MET: FEBRUARY 12, 2004  
 FRANKLIN COUNTY COMMISSIONERS  
 MET: FEBRUARY 12, 2004

CITY OF COLUMBUS  
 MET: FEBRUARY 12, 2004  
 CITY OF COLUMBUS  
 MET: FEBRUARY 12, 2004

CONSOLIDATED RAIL  
 DEED BOOK 3714, PAGE 79  
 55.94 ACRES  
 240-00000

CYPRESS WESLEYAN CHURCH  
 DEED BOOK 3476, PAGE 409  
 240-00000

240-00001  
 6.793 ACRES

240-00002  
 8.269 ACRES

240-00003  
 8.269 ACRES

240-00004  
 8.269 ACRES

240-00005  
 8.269 ACRES

240-00006  
 8.269 ACRES