

5667 Renner Road  
 Approximately 1.69 acres  
 RR, L-AR-12, L-C-4 to NE & NG

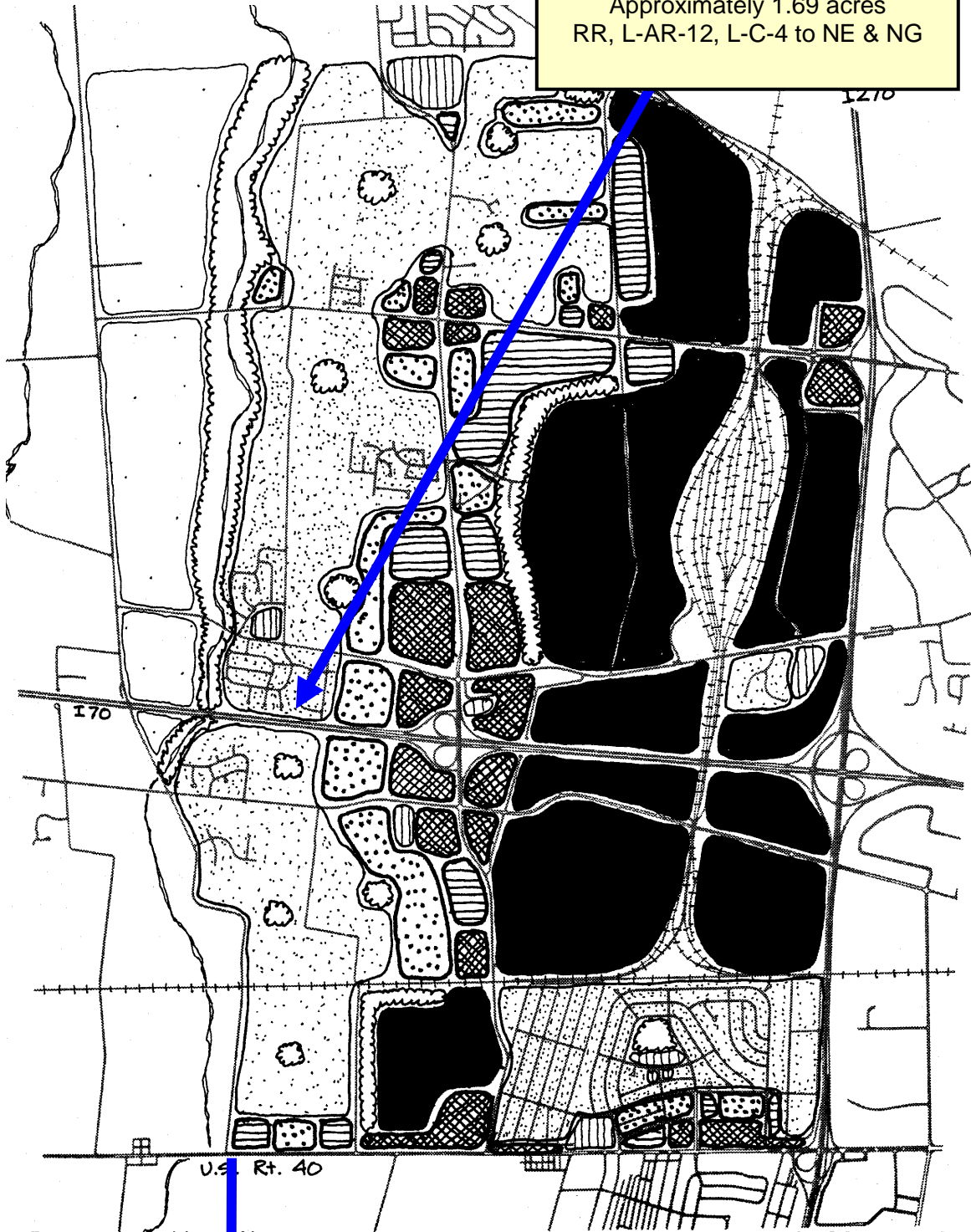

- Recommended Land Use WEST COLUMBUS
- |                       |                      |                     |                   |
|-----------------------|----------------------|---------------------|-------------------|
| Residential SFD (low) | Residential Multi-F. | Institutional       | Commercial        |
| Residential SFD       | Open Space/Park      | Office/Transitional | Industrial/Manuf. |