

**PARCEL 126-WD  
JOYCE AVENUE IMPROVEMENTS  
IN THE NAME AND FOR THE USE OF THE CITY OF COLUMBUS**

Situated in the State of Ohio, County of Franklin, City of Columbus and being in Quarter Township 4, Township 1, Range 18 of the United States Military Lands and being part of a tract of land conveyed to Charles Condiff by deed of record in OR 12593 C16 (all references to the Recorder's Office, Franklin County, Ohio) also being part of lot 90 of Duxberry Park Subdivision in Plat Book 20, Page 21 and being more particularly described as follows:

Beginning at an iron pin set at the intersection of the existing easterly right of way of Joyce Avenue (60' RW) and the existing southerly right of way of 26th Avenue (50' RW), said point being the grantor's northwest corner and being 30.00 feet right of station 106+99.40 on Joyce Avenue;

thence S 86°32'15" E along said right of way of 26th Avenue a distance of 54.99 feet to an iron pin set, being 84.13 feet right of station 107+09.08;

thence S 84°43'56" W across the grantor's tract a distance of 46.64 feet to an iron pin set, being 40.00 feet right of station 106+94.40;

thence S 13°35'41" W across the grantor's tract a distance of 29.60 feet to an iron pin set on the said existing easterly right of way of Joyce Avenue, being 40.00 feet right of station 106+64.40;

thence N 76°24'19" W along the said existing easterly right of way of Joyce Avenue a distance of 10.00 feet to an iron pin set, being 30.00 feet right of station 106+64.40;

thence N 13°35'41" E along said right of way of Joyce Avenue a distance of 35.00 feet to the point of beginning.

The above described area is contained within the Franklin County Auditor's Parcel Numbers 010-098738. Within said boundary is 0.012 acres, more or less, of which 0.000 acres is in the present road occupied, for a net take of 0.012 acres, more or less.

This description and survey was prepared from field observations made in March 2009 and reviewed on June 18, 2014 by Robert A. Bosworth, Registered Surveyor #7750.

All iron pins set are 5/8" rebar (30" long) with a yellow plastic cap stamped "R/W DYNOTEC, INC" and are to be placed at the completion of construction.

The basis of bearings in this description is based on GPS observations using the Ohio CORS Network (Ohio South Zone) to determine a grid bearing in the NAD83 (96CORS adjustment) state plane coordinate system. The Columbus, Mount Vernon, and McConnelville CORS stations were used in determining the grid bearing, and establishing a bearing along the centerline of Joyce Avenue to be N 13°32'54"E (north of 17<sup>th</sup> Avenue).

All stations and offsets are referenced to the centerline of right-of-way and construction as filed with the City of Columbus and designated as "2906- E".

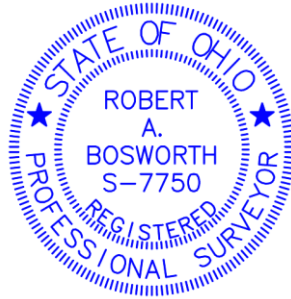

---

Robert A. Bosworth, P.S.  
Reg. Surveyor No. 7750

---

Date