

PROPOSED ANNEXATION OF 63.851 ACRES FROM MADISON TOWNSHIP TO THE CITY OF COLUMBUS

SECTION 14, TOWNSHIP 11, RANGE 21
CONGRESS LANDS
TOWNSHIP OF MADISON, COUNTY OF FRANKLIN, STATE OF OHIO

ANNEXATION
PLAT & DESCRIPTION
ACCEPTABLE
CORNELL R. ROBERTSON, P.E., P.S.
FRANKLIN COUNTY ENGINEER
By JCH/FBA Date 03/23/23

RECEIVED

MAR 23 2023

Franklin County Engineer
Cornell R. Robertson, P.E., P.S.

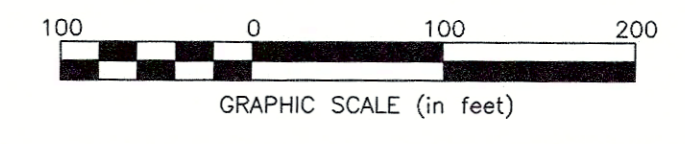

AREA TO BE ANNEXED
FROM MADISON TOWNSHIP TO THE CITY OF COLUMBUS

PROPOSED CITY OF COLUMBUS CORPORATION LINE
EXISTING CITY OF COLUMBUS CORPORATION LINE

Contiguity Note - 63.851 Acres:
Total perimeter of annexation area is 7,505 feet, of which
1,135 feet is contiguous with the City of Columbus by
Ordinance Number 1509-00, giving 15% perimeter
contiguity.

Note:
This annexation does not create islands of unincorporated
areas within the limits of the area to be annexed.



By Matthew A. Kirk Date 23 March 23
Matthew A. Kirk
Professional Surveyor No. 7865
mkirk@emht.com

EMHT		Date: March 23, 2023	
Evans, Mechwart, Hambleton & Tilton, Inc. Engineers • Surveyors • Planners • Scientists 5500 New Albany Road, Columbus, OH 43054 Phone: 614.775.4500 • Toll Free: 888.775.3648 emht.com		Scale: 1" = 100'	Job No: 2021-1307
		Sheet: 1 of 1	
REVISIONS			
MARK	DATE	DESCRIPTION	

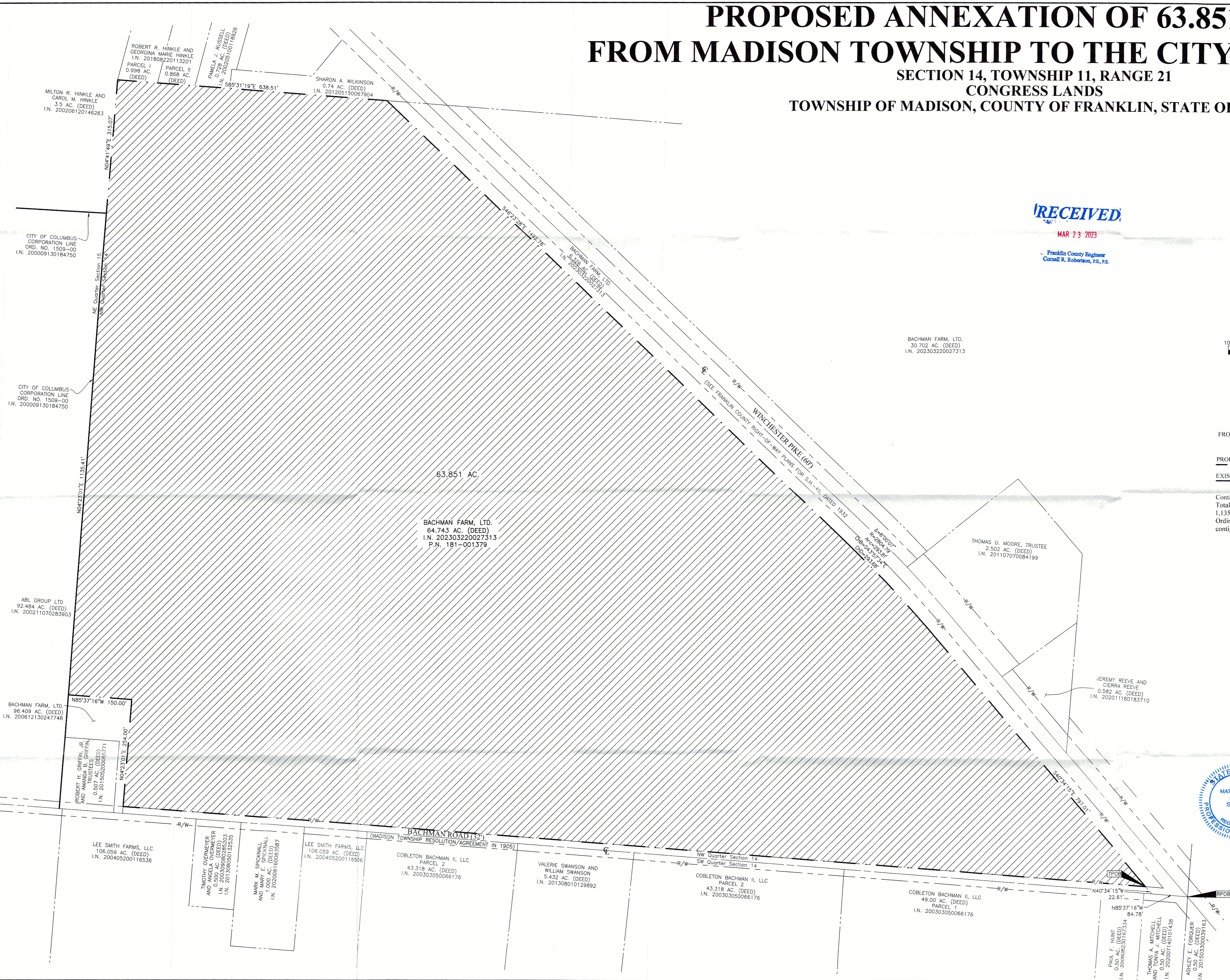

A:\2021\1307\EMHT\20210323\1307-01-ANNEX-01.DWG, plotted by: MKIRK, on: 3/23/2023 10:00:00 AM