

ANNEXATION
PLAT & DESCRIPTION
ACCEPTABLE
CORNELL R. ROBERTSON, P.E., P.S.
FRANKLIN COUNTY ENGINEER

By FR Date 9/8/17

PROPOSED ANNEXATION
20.2± ACRES

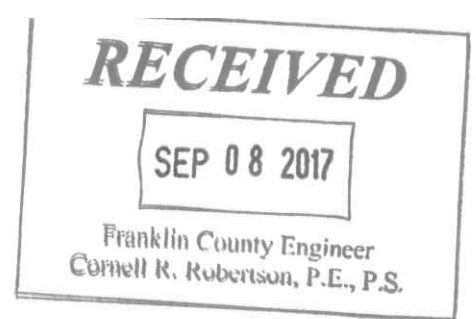

FROM: TOWNSHIP OF PERRY

TO: CITY OF COLUMBUS

Situated in the State of Ohio, County of Franklin, Township of Perry, in Lot 14, Quarter Township 3, Township 2, Range 19, United States Military Lands, being comprised of a part of each of those tracts of land conveyed to Kerre A. Kammerer by deed of record in Instrument Number 201005280066723, Randy Walker and Christine K. Walker by deed of record in Instrument Number 201103250040929, Majda M. Horn and Gerald Horn by deed of record in Instrument Number 201701230011507 and Epcon Riverside, LLC by deeds of record in Instrument Numbers 201707050090534 and 201707280103348 (all references are to the records of the Recorder's Office, Franklin County, Ohio) and more particularly bounded and described as follows:

BEGINNING, for reference, at the southwesterly corner of Lot 739 of the subdivision entitled "Riverside Green South, Section 20" of record in Plat Book 63, Page 43, in the easterly line of that 5 acre tract conveyed to The Harmeet Chawla First Family Limited Partnership by deed of record in Instrument Number 199810060255399;

Thence northerly, with the westerly line of said 739, a distance of 87'± to the TRUE POINT OF BEGINNING for this description;

Thence westerly, with the northerly line of said 5 acre tract, a distance of 1494'± to a point in the easterly right of way line of Riverside Drive (U.S. 33);

Thence northerly, with said easterly right of way line, a distance of 579'± to a point in the southerly line of that 2.563 acre tract conveyed to Steven R. Kerber and Phyllis E. Kerber by deed of record in Official Record 5081H16;

Thence easterly, with said southerly line and the southerly line of that 5 acre tract conveyed to David J. Baddour by deed of record in Instrument Number 200804280064638, a distance of 1625'± feet to a point in the westerly line of the subdivision entitled "Riverside Hills, Section 8, of record in Plat Book 57, Page 87, in the existing City of Columbus corporation line as established by Ordinance Number 391-73 and recorded in Miscellaneous Volume 159, Page 73;

Thence southerly, with the westerly line of said "Riverside Hills, Section 8", said existing corporation line, and the existing City of Columbus corporation line as established in Ordinance Number _____ and recorded in Miscellaneous Volume 163, Page 656, a distance of 568'± feet to the TRUE POINT OF BEGINNING, containing 20.2± acres of land, more or less.

This description is for annexation purposes only and is not to be used for transfer.

EVANS, MECHWART, HAMBLETON & TILTON, INC.

John C. Dodgion
Professional Surveyor No. 8069

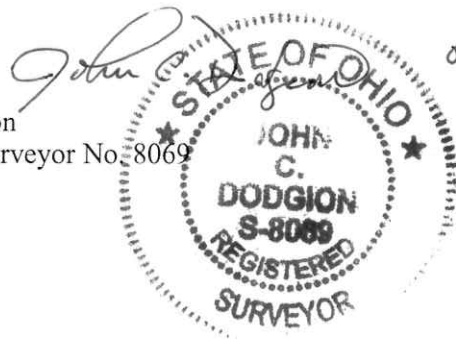

09/08/2017
Date