

ANNEXATION AN12-014

+ 8.5 Acres in Franklin Township

Unique Leasing, Inc. / Jim Lincoln

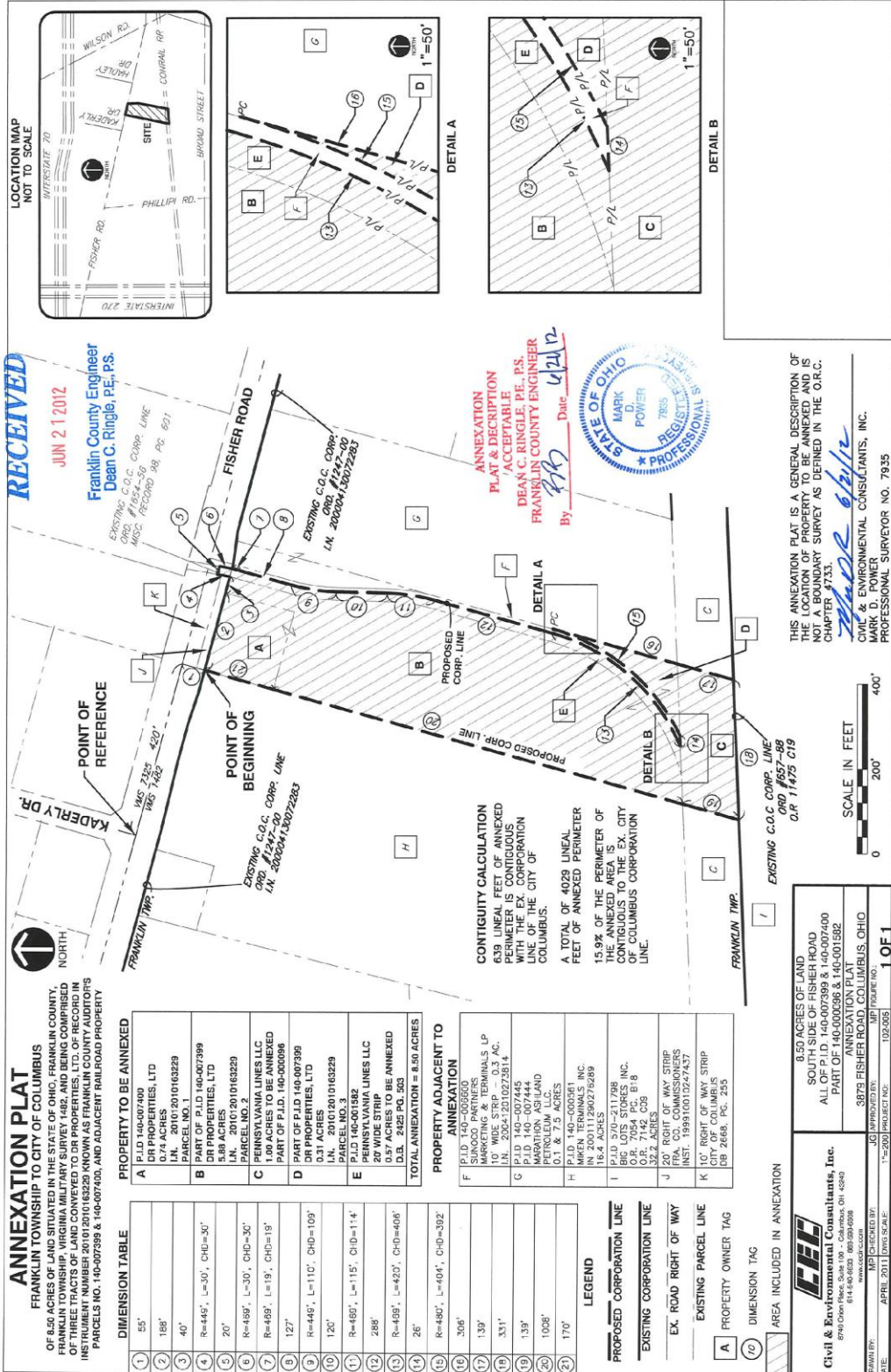

ANNEXATION PLAT
FRANKLIN TOWNSHIP TO CITY OF COLUMBUS

OF 8.50 ACRES OF LAND SITUATED IN THE STATE OF OHIO, FRANKLIN COUNTY, FRANKLIN TOWNSHIP, VIRGINIA MILITARY SURVEY 1482, AND BEING COMPRISED OF THREE TRACTS OF LAND CONVEYED TO DR PROPERTIES, LTD. OF RECORD IN INSTRUMENT NUMBER 201012010163229 KNOWN AS FRANKLIN COUNTY AUDITORS' PARCELS NO. 140-007399 & 140-007400, AND ADJACENT RAILROAD PROPERTY

PROPERTY TO BE ANNEXED

A	PLD 140-007400 DR PROPERTIES, LTD 0.74 ACRES I.N. 201012010163229 PARCEL NO. 1
B	PART OF PLD 140-007399 DR PROPERTIES, LTD 5.81 ACRES I.N. 201012010163229 PARCEL NO. 2
C	PENNSYLVANIA LINES LLC 1.00 ACRES TO BE ANNEXED PART OF PLD. 140-000098 DR PROPERTIES, LTD 0.31 ACRES I.N. 201012010163229 PARCEL NO. 3
D	PART OF PLD 140-007399 DR PROPERTIES, LTD 0.31 ACRES I.N. 201012010163229 PARCEL NO. 3
E	PLD 140-001582 PENNSYLVANIA LINES LLC 0.37 ACRES TO BE ANNEXED D.B. 2, 2422 PG. 503

TOTAL ANNEXATION = 8.50 ACRES

PROPERTY ADJACENT TO ANNEXATION

F	PLD 140-000600 MARKETING & TERMINALS LP 10' WIDE STRIP - 0.3 AC. I.N. 200422010272814
G	PLD 140-007444 MARATHON-AHLAND I.N. 2006004130072283 0.1 & 7.5 ACRES
H	PLD 140-000961 M&EN TERMINALS INC. I.N. 20011135 15, 200 & 29027289
I	PLD 370-211708 BIG LOTS STORES INC. O.R. 7054 PG. B18 I.N. 199910010247437 32.2 ACRES
J	20' RIGHT OF WAY STRIP FRA. CO. COMMISSIONERS I.N.S. 199910010247437
K	10' RIGHT OF WAY STRIP FRA. CO. COMMISSIONERS O.R. 2668, PG. 255

LEGEND

PROPOSED CORPORATION LINE

EXISTING CORPORATION LINE

EX. ROAD RIGHT OF WAY

EXISTING PARCEL LINE

A. PROPERTY OWNER TAG

70 DIMENSION TAG

AREA INCLUDED IN ANNEXATION

8.50 ACRES OF LAND
SOUTH OF FISHER ROAD
ALL OF PLD. 140-007399 & 140-007400
PART OF 140-000098 & 140-001582
ANNEXATION PLAT
3875 FISHER ROAD, COLUMBUS, OHIO

DRAWN BY: JG
CHECKED BY: JG
DATE: APRIL 2011 (DWG SCALE: 1"=200') PROJECT NO: 102-005

CONTIGUITY CALCULATION
639 LINEAL FEET OF ANNEXED PERIMETER IS CONTIGUOUS WITH THE EX. CORPORATION LINE TO THE CITY OF COLUMBUS.

A TOTAL OF 4029 LINEAL FEET OF ANNEXED PERIMETER 15.9% OF THE PERIMETER OF THE ANNEXED AREA IS CONTIGUOUS TO THE EX. CITY OF COLUMBUS CORPORATION LINE.

POINT OF BEGINNING
Existing C.O.C. CORP. LINE
O.R. 11247-00
I.N. 2006004130072283

POINT OF REFERENCE
KADERLY DR.
I.M.S. 7242
I.M.S. 1482

EXISTING C.O.C. CORP. LINE
O.R. #1852-39
M.S. RECORD 98, PG. 801

EXISTING C.O.C. CORP. LINE
O.R. #147-00
I.N. 200004130072283

P1010102-0051-SURVEY102-005 ANNEXATION PLAT - WORKING DWG (ANNEXATION PLAT) (WORKER) - APR 13, 2011 - 15240