

P & L SYSTEMS, INC.
 SURVEYORS & ENGINEERS
 171 CHARRING CROSS DRIVE
 WESTERVILLE, OHIO 43081

FOR: RON'S EXPRESS CAR WASH & LUBE
 LOCATION: COLUMBUS, OHIO
 SCALE: 1"=50'
 DATE: 4 MAY, 2004

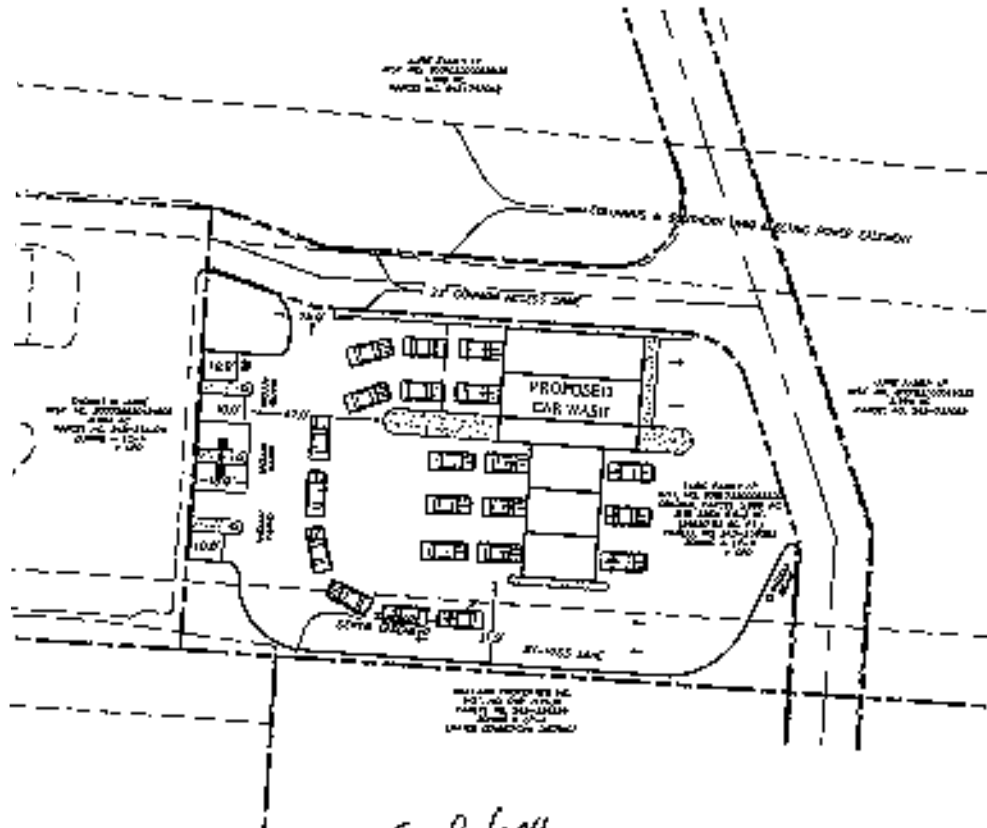
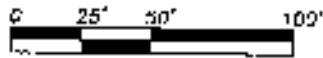

*Final Copy
 Don Ber
 9-29-04*

CV03-047 Site Plan
 4831 Chestnut Hill Drive
 Columbus, Ohio

Jeffrey L. Brown, Attorney for the Applicant

[Signature]
 September 29, 2004