

7909 Station Street
Approximately 2.0 acres
R to L-M

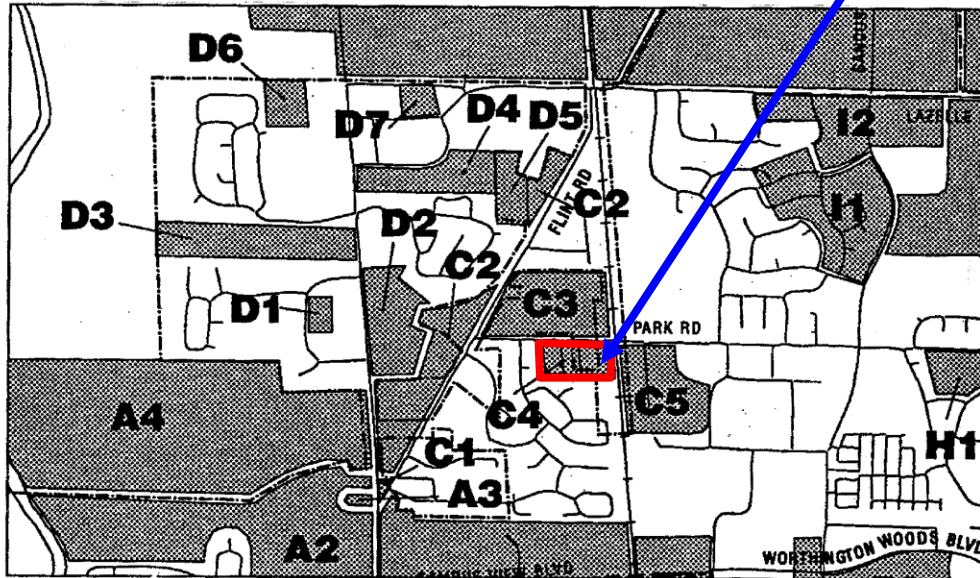

Subarea C.4: This subarea is mostly developed with a mixture of incompatible land uses including large lot single-family homes, a tavern/carry out, and veterinarian. Subarea is controlled by two jurisdictions, the city of Columbus and Sharon Township. City of Columbus land is zoned Limited Commercial (LC4) and Rural (R) and Sharon Township land is zoned Neighborhood Commercial (NC) under the Franklin County Zoning Resolution.

- Limit development and redevelopment to neighborhood-scale commercial uses that service the immediate area. Appropriate uses include bakery, dry cleaner, pizza restaurant or delicatessen, beauty shop, and day care facility.