

PARCEL 112A-WD1
JOYCE AVENUE IMPROVEMENTS
IN THE NAME AND FOR THE USE OF THE CITY OF COLUMBUS
(without limitation of existing access rights)

Situated in the State of Ohio, County of Franklin, City of Columbus and being in Quarter Township 4, Township 1, Range 18 of the United States Military Lands and being part of a tract of land conveyed to Plaskolite Inc. by deed of record in Instrument Numbers 200009050177756 and 200803210043190 (all references to the Recorder's Office, Franklin County, Ohio) also being part of lots 62 and 63 of Casita Park Subdivision in Plat Book 17, Page 178 and being a parcel of land located on the right side of the centerline of construction for Joyce Avenue made for the City of Columbus by Dynotec, Inc., and recorded in Plat Book _____, Page _____, and being further bounded and described as follows:

Beginning at an iron pin set at the intersection of the existing easterly right of way of Joyce Avenue (60' RW) and the existing northerly right of way of 23rd Avenue (50' RW), said point being the grantor's southwest corner and being 30.00 feet right of station 98+37.96 on Joyce Avenue;

thence N 13°35'41" E along said right of way of Joyce Avenue a distance of 63.04 feet to an iron pin set, being 30.00 feet right of station 99+01.00;

thence S 6°17'21" W across the grantor's tract a distance of 39.32 feet to an iron pin set, being 35.00 feet right of station 98+62.00;

thence S 33°45'11" E across the grantor's tract a distance of 28.55 feet to an iron pin set in the said northerly right of way of 23rd Avenue, being 56.00 feet right of station 98+42.65;

thence N 86°38'20" W along the said right of way of 23rd Avenue a distance of 26.42 feet to the point of beginning.

The above described area is contained within the Franklin County Auditor's Parcel Numbers 010-098596 (0.010 acres gross take, 0.000 acres in the present road occupied, resulting in a net take of 0.010 acres) and 010-098597 (0.001 acres gross take, 0.000 acres in the present road occupied, resulting in a net take of 0.001 acres) and a total gross take of 0.011 acres, more or less, of which 0.000 acres is in the present road occupied, for a total net take of 0.011 acres, more or less.

This description and survey was prepared from field observations made in March 2009 and reviewed on April 16, 2014 by Robert A. Bosworth, Registered Surveyor #7750.

All iron pins set are 5/8" rebar (30" long) with a yellow plastic cap stamped "R/W DYNOTEC, INC" and are to be placed at the completion of construction.

The basis of bearings in this description is based on GPS observations using the Ohio CORS Network (Ohio South Zone) to determine a grid bearing in the NAD83 (96CORS adjustment) state plane coordinate system. The Columbus, Mount Vernon, and McConnelville CORS stations were used in determining the grid bearing, and establishing a bearing along the centerline of Joyce Avenue to be N 13°32'54"E (north of 17th Avenue).

All stations and offsets are referenced to the centerline of right-of-way and construction as filed with the City of Columbus and designated as "2906- E".

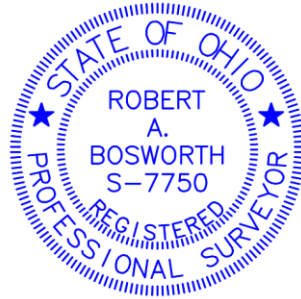

Robert A. Bosworth, P.S.
Reg. Surveyor No. 7750

Date