

Bethel Road Culvert Rehabilitation Project

August 22, 2017

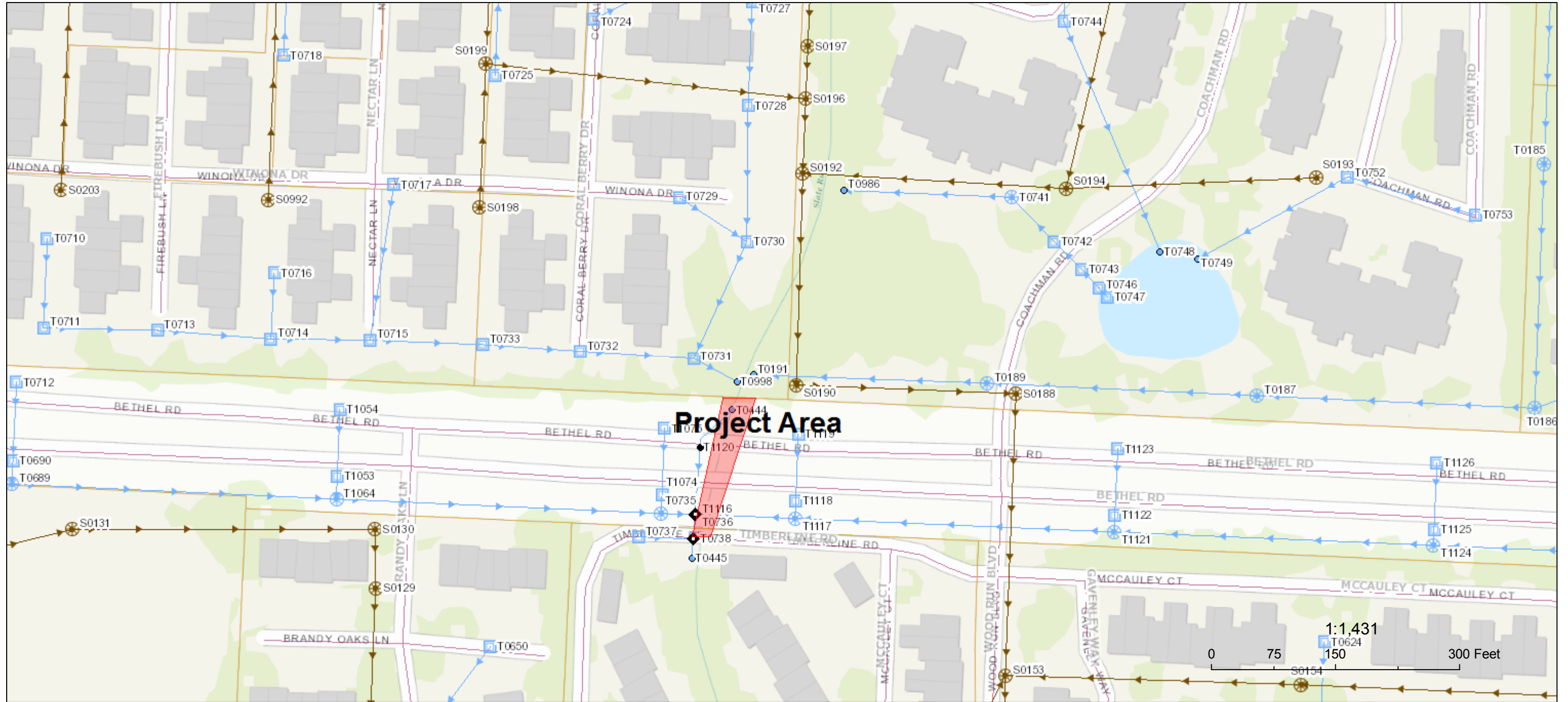

- | | | | | | | | |
|--|--|---|--|---|---|---|---|
| POWER <ul style="list-style-type: none">Service Point - Multiple Meter - CriticalService Point - Multiple MeterService Point - Single Meter - CriticalService Points - Single MeterService Point - Primary MeterCapacitor Bank - FixedCapacitor Bank - SwitchedFuse - OverheadFuse - UndergroundCircuit BreakerRecloserSectionalizerTransformer - OverheadTransformer - PowerTransformer - StepTransformer - UndergroundRegulator BankSwitch Bank - Normally OpenSwitch Bank - Normally ClosedLighting ControllerJunction BoxPadPedestalSwitch Cabinet | <ul style="list-style-type: none">Pole - H-FramePole - TowerPole - Streetlight - WoodPole - Streetlight - Non-WoodPole - Power - WoodPole - Power - Non-WoodHandholeManholeVaultStreetlightSubstationSingle Phase Secondary OverheadThree Phase Secondary OverheadSingle Phase Secondary UndergroundThree Phase Secondary UndergroundSingle Phase Primary OverheadSubstation Bus BarThree Phase Primary OverheadTwo Phase Primary OverheadSingle Phase Primary UndergroundSwitch Cabinet Bus BarThree Phase Primary UndergroundTwo Phase Primary UndergroundOverhead Streetlight ConductorUnderground Lighting Conductor | SEWER <ul style="list-style-type: none">Main ChangeStructureBlind ConnectSanitary Sewer: ExistingClean OutFlap GateSluice GatePipe End - SanitaryPipe End - CombinedPipe End - StormBulkheadInletManhole - CombinedManhole - StormManhole - SanitaryPump Station - Combined | <ul style="list-style-type: none">Duct - Not OccupiedDuct - OccupiedDuct BankConduit: Duct BankConduit: TrenchUFM FloorUFM WallPump Station - StormPump Station - SanitaryFlow RegulatorTreatment PlantOpen Channel: ExistingOpen Channel: ProposedOpen Channel: AbandonedCustomer TapCustomer CleanoutCustomer LateralCustomer Lateral - PseudoSewer Main: OtherSanitary Sewer: ExistingStorm Sewer: ExistingCombined Sewer: ExistingSanitary Sewer: ProposedStorm Sewer: ProposedCombined Sewer: ProposedSanitary Sewer: AbandonedStorm Sewer: AbandonedCombined Sewer: AbandonedHSTSDry Basement ValveSanitary SewershedContract Service Area - County | <ul style="list-style-type: none">Contract Service Area - MunicipalSewer Maintenance AreaManhole - Suburban SanitaryMain - Suburban SanitaryFlow MetersSewer Relief StructuresSewer Relief OutfallsEPM Power Cleaning MainsSCREAM: Other ValuesSCREAM: Not ScoredSCREAM: 90 - 100SCREAM: 80 - 89SCREAM: 70 - 79SCREAM: 0 - 70PreTreatment Inspection MHPreTreatment Industrial CustomerPreTreatment LateralFloodwall - ClosureFloodwallLeveeHydrant - OthersHydrant - ColumbusHydrant - OtherValve - System Valves | <ul style="list-style-type: none">Valve - Left HandedValve - HydrantValve - BoundryValve - Pressure ReducingFitting - OtherCorporation StopChangeElbow; BendCrossReducerTeeEnd of MainTapping SleeveVenturiWyeWater: OtherMain: In ServiceMain: Emerg ConnectMain: Out of ServiceMain: AbandonedMain: ProposedHydrant Lateral: In ServiceHydrant Lateral: AbandonedRaw: In ServiceRaw: Out of Service | <ul style="list-style-type: none">Raw: AbandonedSludge: In ServiceCurb StopMeter - OtherMeter - No BackflowMeter - BackflowMeter - MasterService - OtherService - DepartmentService - OwnerTreatment PlantPump StationStorage TankPlant Service Area - Dublin RdPlant Service Area - Hap CremeanPlant Service Area - Parsons AvePressure DistrictContract AreaWellValve VaultCisternAir ReleaseAssessment | <ul style="list-style-type: none">WQAL Sample Site - AWQAL Sample Site - BWQAL Sample Site - CWQAL Sample Site - DWQAL Sample Site - DRWPWQAL Sample Site - EWQAL Sample Site - FWQAL Sample Site - GWQAL Sample Site - HWQAL Sample Site - HCWPWQAL Sample Site - KWQAL Sample Site - PAWPABAN_HYDRANTABAN_VALVEABAN_FITTINGABAN_WATER_MAINABAN_PUMP_STATIONABAN_STORAGE_TANKABAN_SERVICEABAN_CURB_STOPABAN_METERABAN_WELLABAN_VALVE_VAULTABAN_CISTERNABAN_AIR_RELEASE |
|--|--|---|--|---|---|---|---|

Bethel Road Culvert Rehabilitation Site 2 Project

August 22, 2017

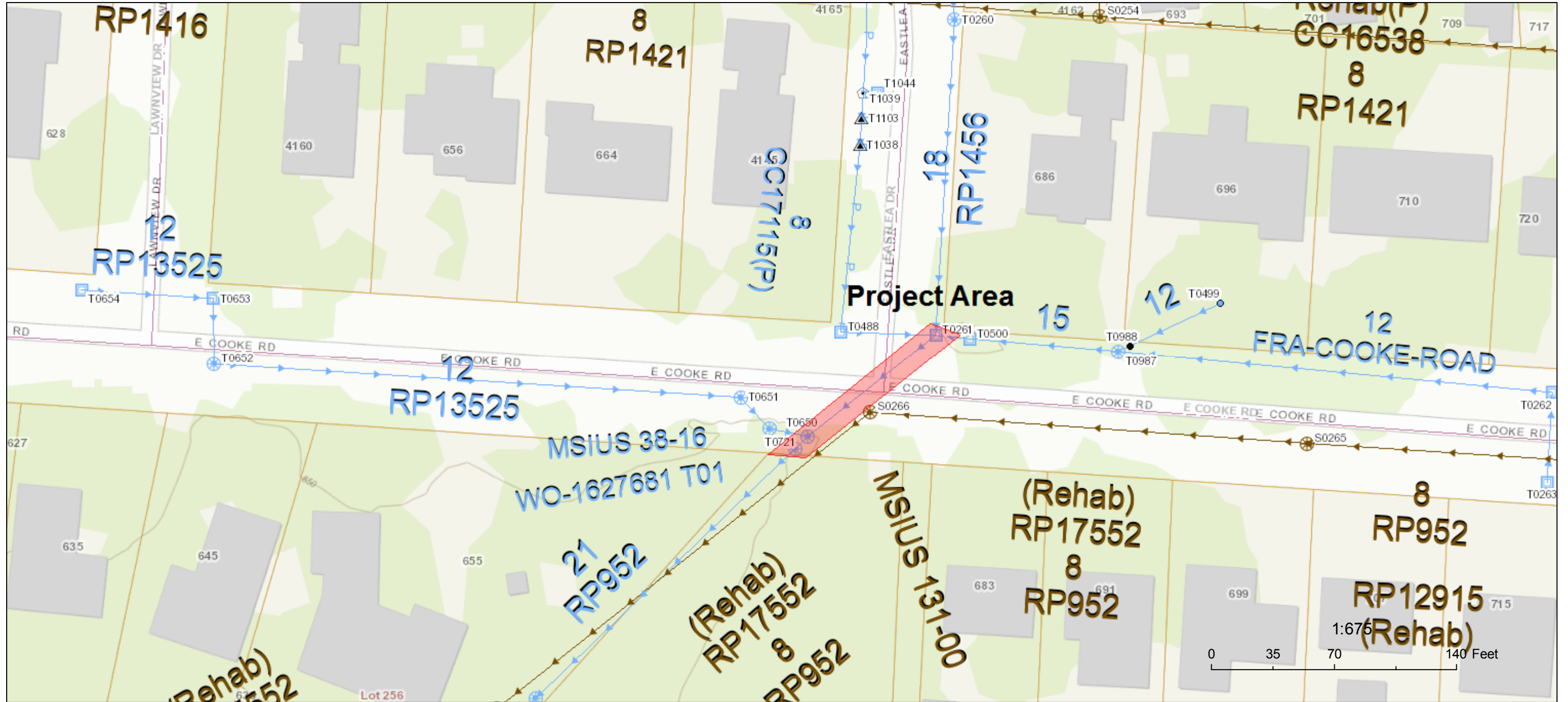

- | | | | | |
|---|--|---|--|--|
| <p>POWER</p> <ul style="list-style-type: none"> Service Point - Multiple Meter - Critical Service Point - Multiple Meter Service Point - Single Meter - Critical Service Point - Single Meter Service Point - Primary Meter Capacitor Bank - Fixed Capacitor Bank - Switched Fuse - Overhead Fuse - Underground Circuit Breaker Recloser Sectionalizer Transformer - Overhead Transformer - Power Transformer - Step Transformer - Underground Regulator Bank Switch Bank - Normally Open Switch Bank - Normally Closed Lighting Controller Junction Box Pad Pedestal Switch Cabinet | <ul style="list-style-type: none"> Pole - H-Frame Pole - Tower Pole - Streetlight - Wood Pole - Streetlight - Non-Wood Pole - Power - Wood Pole - Power - Non-Wood Handhole Manhole Vault Streetlight Substation Single Phase Secondary Overhead Three Phase Secondary Overhead Single Phase Secondary Underground Three Phase Secondary Underground Single Phase Primary Overhead Substation Bus Bar Three Phase Primary Overhead Two Phase Primary Overhead Single Phase Primary Underground Switch Cabinet Bus Bar Three Phase Primary Underground Two Phase Primary Underground Overhead Streetlight Conductor Underground Lighting Conductor | <p>SEWER</p> <ul style="list-style-type: none"> Duct - Not Occupied Duct - Occupied Duct Bank Conduit: Duct Bank Conduit: Trench UFM Floor UFM Wall Main Change Structure Blind Connect Outfall Clean Out Flap Gate Sluice Gate Pipe End - Sanitary Pipe End - Combined Pipe End - Storm Bulkhead Inlet Manhole - Combined Manhole - Storm Manhole - Sanitary Pump Station - Combined Pump Station - Storm Pump Station - Sanitary Flow Regulator Treatment Plant Open Channel: Existing Open Channel: Proposed Open Channel: Abandoned Customer Tap Customer Cleanout Customer Lateral Customer Lateral - Pseudo Sewer Main: Other Sanitary Sewer: Existing Storm Sewer: Existing Combined Sewer: Existing Sanitary Sewer: Proposed Storm Sewer: Proposed Combined Sewer: Proposed Sanitary Sewer: Abandoned Storm Sewer: Abandoned Combined Sewer: Abandoned HSTS Dry Basement Valve Sanitary Sewershed Contract Service Area - County | <p>WATER</p> <ul style="list-style-type: none"> Contract Service Area - Municipal Sewer Maintenance Area Manhole - Suburban Sanitary Main - Suburban Sanitary Flow Meters Sewer Relief Structures Sewer Relief Outfalls EPM Power Cleaning Mains SCREAM: Other Values SCREAM: Not Scored SCREAM: 90 - 100 SCREAM: 80 - 89 SCREAM: 70 - 79 SCREAM: 0 - 70 PreTreatment Inspection MH PreTreatment Industrial Customer PreTreatment Lateral Floodwall - Closure Floodwall Levee Hydrant - Others Hydrant - Columbus Valve - Other Valve - System Valves Valve - Left Handed Valve - Hydrant Valve - Boundary Valve - Pressure Reducing Fitting - Other Corporation Stop Change Elbow; Bend Cross Reducer Tee End of Main Tapping Sleeve Venturi Wye Water: Other Main: In Service Main: Emerg Connect Main: Out of Service Main: Abandoned Main: Proposed Hydrant Lateral: In Service Hydrant Lateral: Abandoned Hydrant: In Service Raw: Out of Service | <ul style="list-style-type: none"> Raw: Abandoned Sludge: In Service Curb Stop Meter - Other Meter - No Backflow Meter - Backflow Meter - Master Service - Other Service - Department Service - Owner Treatment Plant Pump Station Storage Tank Plant Service Area - Dublin Rd Plant Service Area - Hap Cremean Plant Service Area - Parsons Ave Pressure District Contract Area Well Valve Vault Cistern Air Release Assessment WQAL Sample Site - A WQAL Sample Site - B WQAL Sample Site - C WQAL Sample Site - D WQAL Sample Site - DRWP WQAL Sample Site - E WQAL Sample Site - F WQAL Sample Site - G WQAL Sample Site - H WQAL Sample Site - HCWP WQAL Sample Site - K WQAL Sample Site - PAWP ABAN_HYDRANT ABAN_VALVE ABAN_FITTING ABAN_WATER_MAIN ABAN_PUMP_STATION ABAN_STORAGE_TANK ABAN_SERVICE ABAN_CURB_STOP ABAN_METER ABAN_WELL ABAN_VALVE_VAULT ABAN_CISTERN ABAN_AIR_RELEASE |
|---|--|---|--|--|