

EXHIBIT "A" PREPARED BY:
 CENTRAL SURVEYING CO. LTD
 7563 EAST MAIN ST.
 REYNOLDSBURG, OHIO 43068
 614-864-1100

EXHIBIT "A"

LINE	BEARING	DISTANCE
L1	N 85°20'15" W	10.08'
L2	N 11°55'27" E	0.77'
L3	N 06°09'00" E	44.50'
L4	S 83°51'00" E	10.00'
L5	S 06°09'00" W	45.00'

CITY OF COLUMBUS, OHIO
 WILLIS PARK
 P.B. 28 PGS. 22-24

EASEMENT AREA
 CONTAINING 0.010± ACRES

TATIANA KHOROCHILOVA
 INST.# 201104260054418
 LOT 474
 PID: 010-105954-00

MARY M. HART
 INST.# 201012090168087
 LOT 475
 PID: 010-105955-00

THE LIBERTY CHRISTIAN ACADEMY
 INST.# 201012090168087
 5.878 ACRES
 PID: 010-210602-00

CITY OF COLUMBUS, OHIO
 INST.# 201009130118316
 PID: 010-105987-00

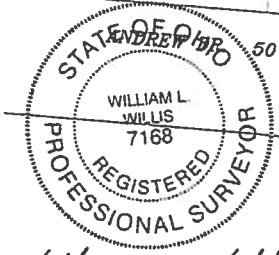

William L. Willis
 WILLIAM L. WILLIS 10/31/2013
 P.S. NO. 7168



SCALE IN FEET
 SCALE: 1 INCH = 60 FEET

XXXXXXXXXX EASEMENT AREA

BASIS OF BEARINGS:
 BEARINGS ARE BASED ON THE EASTERLY LINE
 OF WILLIS PARK AS BEING S 06° 09' 00" W
 AS SHOWN ON PLAT OF RECORD

SITUATE:
 SITUATED IN THE STATE OF OHIO, COUNTY
 OF FRANKLIN, CITY OF COLUMBUS, OHIO,
 AND BEING PART WILLIS PARK IN WILLIS
 PARK #2, AND BEING THE SAME LANDS
 CONVEYED TO CITY OF COLUMBUS, AS
 RECORDED IN PLAT BOOK 28, PAGES
 22-24. ALL REFERENCES CONTAINED HEREIN
 ARE TO FRANKLIN COUNTY RECORDER'S
 RECORDS, FRANKLIN COUNTY, OHIO.

AMERICAN ELECTRIC POWER

EASEMENT ACROSS THE LANDS OF
 THE CITY OF COLUMBUS, OHIO -
 WILLIS PARK
 CONTAINING 0.010± ACRES

Drawn By: DS	Checked By: WW
Scale: 1"=60'	Date: 10/29/13
File Name: 20090807-EAS.DWG	Drawing Number:
Revisions: -	2013-0613

DESCRIPTION OF 0.010 ACRE EASEMENT AREA

FOR

AMERICAN ELECTRIC POWER

Situated in the State of Ohio, County of Franklin, City of Columbus, being part of Willis Park in Willis Park #2, and being part of the same lands conveyed to City of Columbus, Ohio, as recorded in Plat Book 28, Pages 22-24. All references contained herein are to the Franklin County Recorder's records, Franklin County, Ohio and being shown on Exhibit "A" attached hereto and being made a part thereof and being more particularly described as follows:

Beginning at the northeast corner of a 5.878 acre tract of land conveyed to The Liberty Christian Academy, as recorded in Instrument number 201012090168087;

thence, N 85°20'15" W, 10.08 feet running along the northerly line of said Liberty Christian Academy lands to a point;

thence, running within said Willis Park the following three (3) courses and distances:

- 1) N 11°55' 27" E, 0.77 feet to a point;
- 2) N 06°09' 00" E, 44.50 feet to a point;
- 3) S 83°51' 00" E, 10.00 feet to a point on the westerly line of Lot 474 conveyed to Tatiana Khrorochilova, as recorded in Instrument number 201104260054418;

thence, S 06°09' 00" W, 45.00 feet to the point of beginning and containing 0.010 acres of land, more or less, being subject to all legal streets, highways, right-of-ways, alleys, easements, agreements and/or conditions of record, if any.

Bearings are based on the easterly line of said Willis Park as being S 06° 09' 00" W, as shown in Plat Book 28, page 23.



WILLIAM L. WILLIS, P.S. #7168

Central Surveying Co., Ltd.
7563 E. Main Street
Reynoldsburg, OH 43068