

SIMULATION TEXT

1. **GENERAL NOTES:**

2. **EXISTING ZONING:**

3. **PROPOSED ZONING:**

4. **AREA TO BE REZONED:**

5. **BOUNDARIES:**

6. **UTILITIES:**

7. **ADJACENT PROPERTIES:**

8. **ADJACENT ZONING:**

9. **ADJACENT LAND USES:**

10. **ADJACENT OWNERS:**

11. **ADJACENT DISTANCES:**

12. **ADJACENT AREAS:**

13. **ADJACENT VOLUMES:**

14. **ADJACENT HEIGHTS:**

15. **ADJACENT SETBACKS:**

16. **ADJACENT EASEMENTS:**

17. **ADJACENT ENCUMBRANCES:**

18. **ADJACENT EASEMENTS:**

19. **ADJACENT ENCUMBRANCES:**

20. **ADJACENT EASEMENTS:**

21. **ADJACENT ENCUMBRANCES:**

22. **ADJACENT EASEMENTS:**

23. **ADJACENT ENCUMBRANCES:**

24. **ADJACENT EASEMENTS:**

25. **ADJACENT ENCUMBRANCES:**

26. **ADJACENT EASEMENTS:**

27. **ADJACENT ENCUMBRANCES:**

28. **ADJACENT EASEMENTS:**

29. **ADJACENT ENCUMBRANCES:**

30. **ADJACENT EASEMENTS:**

31. **ADJACENT ENCUMBRANCES:**

32. **ADJACENT EASEMENTS:**

33. **ADJACENT ENCUMBRANCES:**

34. **ADJACENT EASEMENTS:**

35. **ADJACENT ENCUMBRANCES:**

36. **ADJACENT EASEMENTS:**

37. **ADJACENT ENCUMBRANCES:**

38. **ADJACENT EASEMENTS:**

39. **ADJACENT ENCUMBRANCES:**

40. **ADJACENT EASEMENTS:**

41. **ADJACENT ENCUMBRANCES:**

42. **ADJACENT EASEMENTS:**

43. **ADJACENT ENCUMBRANCES:**

44. **ADJACENT EASEMENTS:**

45. **ADJACENT ENCUMBRANCES:**

46. **ADJACENT EASEMENTS:**

47. **ADJACENT ENCUMBRANCES:**

48. **ADJACENT EASEMENTS:**

49. **ADJACENT ENCUMBRANCES:**

50. **ADJACENT EASEMENTS:**

51. **ADJACENT ENCUMBRANCES:**

52. **ADJACENT EASEMENTS:**

53. **ADJACENT ENCUMBRANCES:**

54. **ADJACENT EASEMENTS:**

55. **ADJACENT ENCUMBRANCES:**

56. **ADJACENT EASEMENTS:**

57. **ADJACENT ENCUMBRANCES:**

58. **ADJACENT EASEMENTS:**

59. **ADJACENT ENCUMBRANCES:**

60. **ADJACENT EASEMENTS:**

61. **ADJACENT ENCUMBRANCES:**

62. **ADJACENT EASEMENTS:**

63. **ADJACENT ENCUMBRANCES:**

64. **ADJACENT EASEMENTS:**

65. **ADJACENT ENCUMBRANCES:**

66. **ADJACENT EASEMENTS:**

67. **ADJACENT ENCUMBRANCES:**

68. **ADJACENT EASEMENTS:**

69. **ADJACENT ENCUMBRANCES:**

70. **ADJACENT EASEMENTS:**

71. **ADJACENT ENCUMBRANCES:**

72. **ADJACENT EASEMENTS:**

73. **ADJACENT ENCUMBRANCES:**

74. **ADJACENT EASEMENTS:**

75. **ADJACENT ENCUMBRANCES:**

76. **ADJACENT EASEMENTS:**

77. **ADJACENT ENCUMBRANCES:**

78. **ADJACENT EASEMENTS:**

79. **ADJACENT ENCUMBRANCES:**

80. **ADJACENT EASEMENTS:**

81. **ADJACENT ENCUMBRANCES:**

82. **ADJACENT EASEMENTS:**

83. **ADJACENT ENCUMBRANCES:**

84. **ADJACENT EASEMENTS:**

85. **ADJACENT ENCUMBRANCES:**

86. **ADJACENT EASEMENTS:**

87. **ADJACENT ENCUMBRANCES:**

88. **ADJACENT EASEMENTS:**

89. **ADJACENT ENCUMBRANCES:**

90. **ADJACENT EASEMENTS:**

91. **ADJACENT ENCUMBRANCES:**

92. **ADJACENT EASEMENTS:**

93. **ADJACENT ENCUMBRANCES:**

94. **ADJACENT EASEMENTS:**

95. **ADJACENT ENCUMBRANCES:**

96. **ADJACENT EASEMENTS:**

97. **ADJACENT ENCUMBRANCES:**

98. **ADJACENT EASEMENTS:**

99. **ADJACENT ENCUMBRANCES:**

100. **ADJACENT EASEMENTS:**

101. **ADJACENT ENCUMBRANCES:**

102. **ADJACENT EASEMENTS:**

103. **ADJACENT ENCUMBRANCES:**

104. **ADJACENT EASEMENTS:**

105. **ADJACENT ENCUMBRANCES:**

106. **ADJACENT EASEMENTS:**

107. **ADJACENT ENCUMBRANCES:**

108. **ADJACENT EASEMENTS:**

109. **ADJACENT ENCUMBRANCES:**

110. **ADJACENT EASEMENTS:**

111. **ADJACENT ENCUMBRANCES:**

112. **ADJACENT EASEMENTS:**

113. **ADJACENT ENCUMBRANCES:**

114. **ADJACENT EASEMENTS:**

115. **ADJACENT ENCUMBRANCES:**

116. **ADJACENT EASEMENTS:**

117. **ADJACENT ENCUMBRANCES:**

118. **ADJACENT EASEMENTS:**

119. **ADJACENT ENCUMBRANCES:**

120. **ADJACENT EASEMENTS:**

121. **ADJACENT ENCUMBRANCES:**

122. **ADJACENT EASEMENTS:**

123. **ADJACENT ENCUMBRANCES:**

124. **ADJACENT EASEMENTS:**

125. **ADJACENT ENCUMBRANCES:**

126. **ADJACENT EASEMENTS:**

127. **ADJACENT ENCUMBRANCES:**

128. **ADJACENT EASEMENTS:**

129. **ADJACENT ENCUMBRANCES:**

130. **ADJACENT EASEMENTS:**

131. **ADJACENT ENCUMBRANCES:**

132. **ADJACENT EASEMENTS:**

133. **ADJACENT ENCUMBRANCES:**

134. **ADJACENT EASEMENTS:**

135. **ADJACENT ENCUMBRANCES:**

136. **ADJACENT EASEMENTS:**

137. **ADJACENT ENCUMBRANCES:**

138. **ADJACENT EASEMENTS:**

139. **ADJACENT ENCUMBRANCES:**

140. **ADJACENT EASEMENTS:**

141. **ADJACENT ENCUMBRANCES:**

142. **ADJACENT EASEMENTS:**

143. **ADJACENT ENCUMBRANCES:**

144. **ADJACENT EASEMENTS:**

145. **ADJACENT ENCUMBRANCES:**

146. **ADJACENT EASEMENTS:**

147. **ADJACENT ENCUMBRANCES:**

148. **ADJACENT EASEMENTS:**

149. **ADJACENT ENCUMBRANCES:**

150. **ADJACENT EASEMENTS:**

151. **ADJACENT ENCUMBRANCES:**

152. **ADJACENT EASEMENTS:**

153. **ADJACENT ENCUMBRANCES:**

154. **ADJACENT EASEMENTS:**

155. **ADJACENT ENCUMBRANCES:**

156. **ADJACENT EASEMENTS:**

157. **ADJACENT ENCUMBRANCES:**

158. **ADJACENT EASEMENTS:**

159. **ADJACENT ENCUMBRANCES:**

160. **ADJACENT EASEMENTS:**

161. **ADJACENT ENCUMBRANCES:**

162. **ADJACENT EASEMENTS:**

163. **ADJACENT ENCUMBRANCES:**

164. **ADJACENT EASEMENTS:**

165. **ADJACENT ENCUMBRANCES:**

166. **ADJACENT EASEMENTS:**

167. **ADJACENT ENCUMBRANCES:**

168. **ADJACENT EASEMENTS:**

169. **ADJACENT ENCUMBRANCES:**

170. **ADJACENT EASEMENTS:**

171. **ADJACENT ENCUMBRANCES:**

172. **ADJACENT EASEMENTS:**

173. **ADJACENT ENCUMBRANCES:**

174. **ADJACENT EASEMENTS:**

175. **ADJACENT ENCUMBRANCES:**

176. **ADJACENT EASEMENTS:**

177. **ADJACENT ENCUMBRANCES:**

178. **ADJACENT EASEMENTS:**

179. **ADJACENT ENCUMBRANCES:**

180. **ADJACENT EASEMENTS:**

181. **ADJACENT ENCUMBRANCES:**

182. **ADJACENT EASEMENTS:**

183. **ADJACENT ENCUMBRANCES:**

184. **ADJACENT EASEMENTS:**

185. **ADJACENT ENCUMBRANCES:**

186. **ADJACENT EASEMENTS:**

187. **ADJACENT ENCUMBRANCES:**

188. **ADJACENT EASEMENTS:**

189. **ADJACENT ENCUMBRANCES:**

190. **ADJACENT EASEMENTS:**

191. **ADJACENT ENCUMBRANCES:**

192. **ADJACENT EASEMENTS:**

193. **ADJACENT ENCUMBRANCES:**

194. **ADJACENT EASEMENTS:**

195. **ADJACENT ENCUMBRANCES:**

196. **ADJACENT EASEMENTS:**

197. **ADJACENT ENCUMBRANCES:**

198. **ADJACENT EASEMENTS:**

199. **ADJACENT ENCUMBRANCES:**

200. **ADJACENT EASEMENTS:**

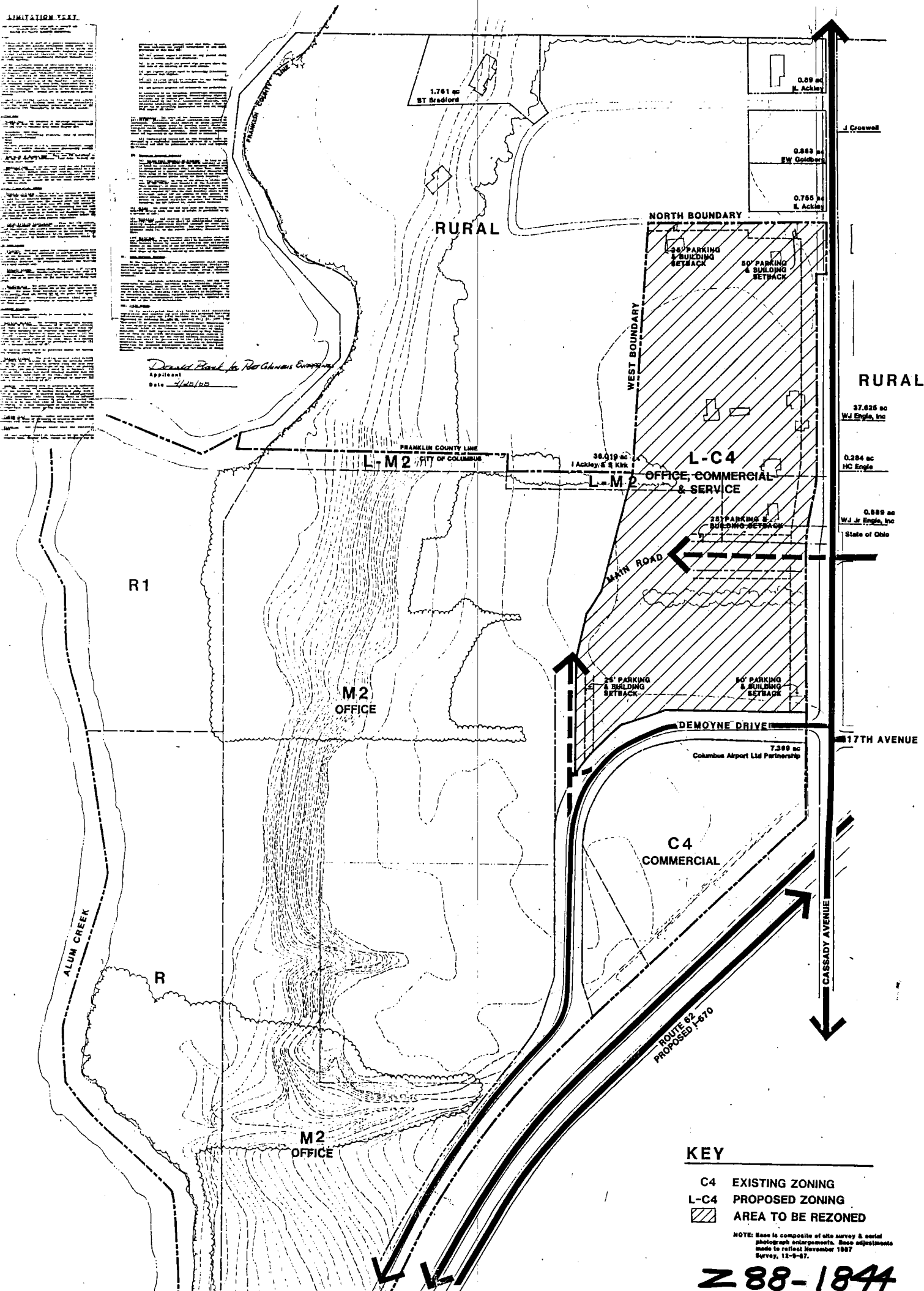

Böhm-NBBJ
 10 Newswide Blvd
 Columbus, Ohio 43216
 614-224-7445
 Architecture
 Planning
 Landscape Architecture

Port Columbus Executive Park

L-C4 ZONING PLAN

date 12-10-97
 rev. 1-25-98
 1-24-98

proj. 87185.00
 dwg.

0 100 200 300 north



Z88-1844A
1463 North Cassady Avenue



"Together We Can Make a World of Difference"

North East Area Commission

July 9, 2014

Ms. Shannon Pine
Department of Development
Building & Development Services
757 Carolyn Ave
Columbus, OH 43224

Ms. Pine:

Subject: Z88-1844A/14335-00000-00170, property known as, 1463 No. Cassady/1521 No. Cassady Ave, Columbus, OH 43219. The North East Area Commission at a public meeting on July 3, 2014 voted to approve the above application with the following conditions.

- A. Temporary curb cut proposed for property known as 1521 No. Cassady Ave, shall be abandoned in its entirety once the new road, Plaza Properties Blvd., is developed. This new road shall be used to accommodate right and left turns.
- B. Absolutely no reduction in the stacking lane on Cassady Ave.

Sincerely,

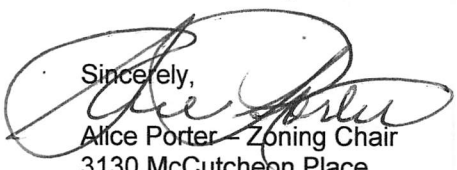
Alice Porter - Zoning Chair
3130 McCutcheon Place
Columbus, OH 43219

Cc: Elwood Rayford- NEAC Chair
William Loveland - Attorney



REZONING APPLICATION

City of Columbus, Ohio • Department of Building & Zoning Services
757 Carolyn Avenue, Columbus, Ohio 43224 • Phone: 614-645-7433 • www.columbus.gov

PROJECT DISCLOSURE STATEMENT

Parties having a 5% or more interest in the project that is the subject of this application.
THIS PAGE MUST BE FILLED OUT COMPLETELY AND NOTARIZED. Do not indicate 'NONE' in the space provided.

APPLICATION # 288-1844A

STATE OF OHIO
COUNTY OF FRANKLIN

Being first duly cautioned and sworn (NAME) Keith Atieh
of (COMPLETE ADDRESS) 308 Windcroft Drive Westerville, Ohio 43081
deposes and states that (he/she) is the APPLICANT, AGENT or DULY AUTHORIZED ATTORNEY FOR SAME and the following is a list of all persons, other partnerships, corporations or entities having a 5% or more interest in the project which is the subject of this application in the following format:

Name of business or individual
Business or individual's address
Address of corporate headquarters
City, State, Zip
Number of Columbus based employees
Contact name and number

| | |
|---|----|
| 1. Airport Business Center, LLC 1640 E. Fifth Avenue Columbus, Ohio 43219 Keith Atieh 614-253-7000 | 2. |
| 3. | 4. |

Check here if listing additional parties on a separate page.

SIGNATURE OF AFFIANT

Subscribed to me in my presence and before me this 4 day of February, in the year 2014

SIGNATURE OF NOTARY PUBLIC

My Commission Expires:

This Project Disclosure Statement expires 01/01/2015 date of 01/01/2015 **LOVELAND**

Notary Seal Here



LOVELAND
Attorney At Law
Notary Public, State of Ohio
My commission has no expiration date
Sec. 147.03 R.C.

PLEASE NOTE: incomplete information will result in the rejection of this submittal.
Applications must be submitted by appointment. Call 614-645-4522 to schedule.
Please make all checks payable to the Columbus City Treasurer