

MAP ANNEXATION AN03-034R 7.1 Acres in Prairie Township Timothy E. Fritchen, et al.

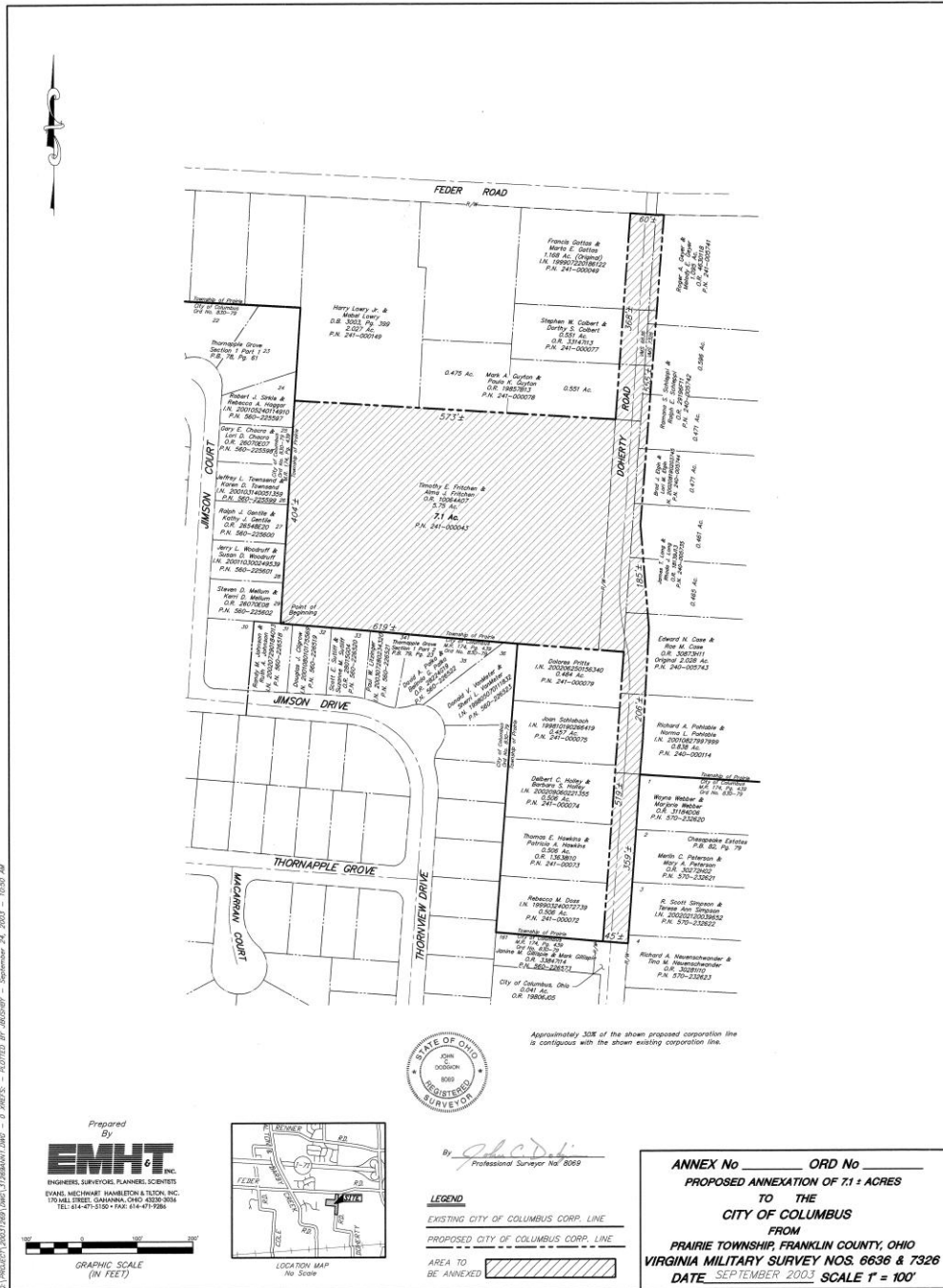

Approximately 33% of the shown proposed corporation line is contiguous with the shown existing corporation line.

Prepared By
EMHT & INC.
ENGINEERS, SURVEYORS, PLANNERS, SCIENTISTS
EVANS, MICHAEL, HAMILTON & TOLSON, INC.
170 HILL STREET, COLUMBUS, OHIO 43206-3004
TEL: 614-471-5150 • FAX: 614-471-9284



By *J. G. C. D.*
Professional Surveyor No. 8069

LEGEND
EXISTING CITY OF COLUMBUS CORP. LINE
PROPOSED CITY OF COLUMBUS CORP. LINE
AREA TO BE ANNEXED

ANNEX No _____ ORD No _____
PROPOSED ANNEXATION OF 7.1 ± ACRES
TO THE
CITY OF COLUMBUS
FROM
PRAIRIE TOWNSHIP, FRANKLIN COUNTY, OHIO
VIRGINIA MILITARY SURVEY NOS. 6636 & 7326
DATE SEPTEMBER, 2003 SCALE 1" = 100'

© PROJECT 2003 JAMES T. PARNELL, D.M.P. - 0 PROTS. - PLATTED BY JAMES T. PARNELL, D.M.P. - September 24, 2003 - 10:59 AM