

**PROPOSED ANNEXATION OF 34.9 +/- ACRES  
FROM MADISON TOWNSHIP TO THE CITY OF COLUMBUS**

Located in State of Ohio, County of Franklin, Township of Madison,  
Section 15, Township 11, Range 21, Congress Lands

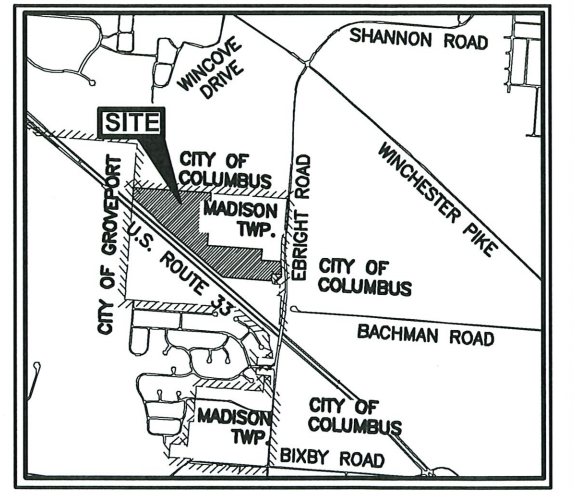

**VICINITY MAP**  
N.T.S.

- (A) SHIRLEY A ADKINS  
O.R.V. 10613 PG. G02  
PAR. 180-000859-00  
1.05 AC. (D)
- (B) SHIRLEY A ADKINS  
O.R.V. 17292 PG. C03  
PAR. 180-000859-00  
0.66 AC. (D)
- (C) WILLIAM R & ANGELA G LUTZ  
INST. 201301090004938  
PAR. 180-005101-00  
4.954 AC. (D)
- (D) ROBERT C & JUDITH A JOHNSON  
INST. 201305080076169  
PAR. 180-000002-00  
REMAINDER OF 9.954 AC. (D)
- (E) BRENT E & JODIE S CONRAD  
O.R.V. 34394 PG. G15  
PAR. 180-005242-00  
5.00 AC. (D)
- (F) PAULA S SMITH  
INST. 199902030027902  
PAR. 180-000190-00  
13.00 AC. (D)
- (G) CVETA NASTEV TR  
INST. 200601130009208  
PAR. 010-264986-00  
19 AC. (D) (TRACT 1)  
28 AC. (D) (TRACT 2)

Ex. City of Columbus  
Corporation Line  
Ord. No. 1351-02  
Inst. No. 200212260331534

Ex. City of Groveport  
Corporation Line  
Ord. No. 532  
Misc. Record 137-404

- (H) AMERI-STOR CANAL WINCHESTER LLC  
INST. 201504170049672  
PAR. 180-000271-00  
9.84 AC. (D)  
EXCEPTING  
0.185 AC. (D)
- (I) THOMAS M DIXON  
INST. 200807250114217  
PAR. 535-300435-00  
0.75 AC. (D)
- (J) RONALD T. HILL & MARGARET J. SPURLOCK  
D.B. 3363 PG. 495  
O.R.V. 12628 PG. G18  
PAR. 180-000015-00  
REMAINDER OF 32.36 AC. (D)  
REMAINDER OF 28 AC. (D)

- (K) COLUMBUS AND FRANKLIN COUNTY METRO PARKS  
INST. 200803060034647  
PAR. 010-286561-00  
0.346 AC. (D)
- (L) STATE OF OHIO DIRECTOR OF ADMINISTRATIVE SERVICES  
NO DEED RECORD FOUND.  
PAR. 185-000904-00  
154.5265 AC.  
(FRANKLIN CO. AUDITOR)

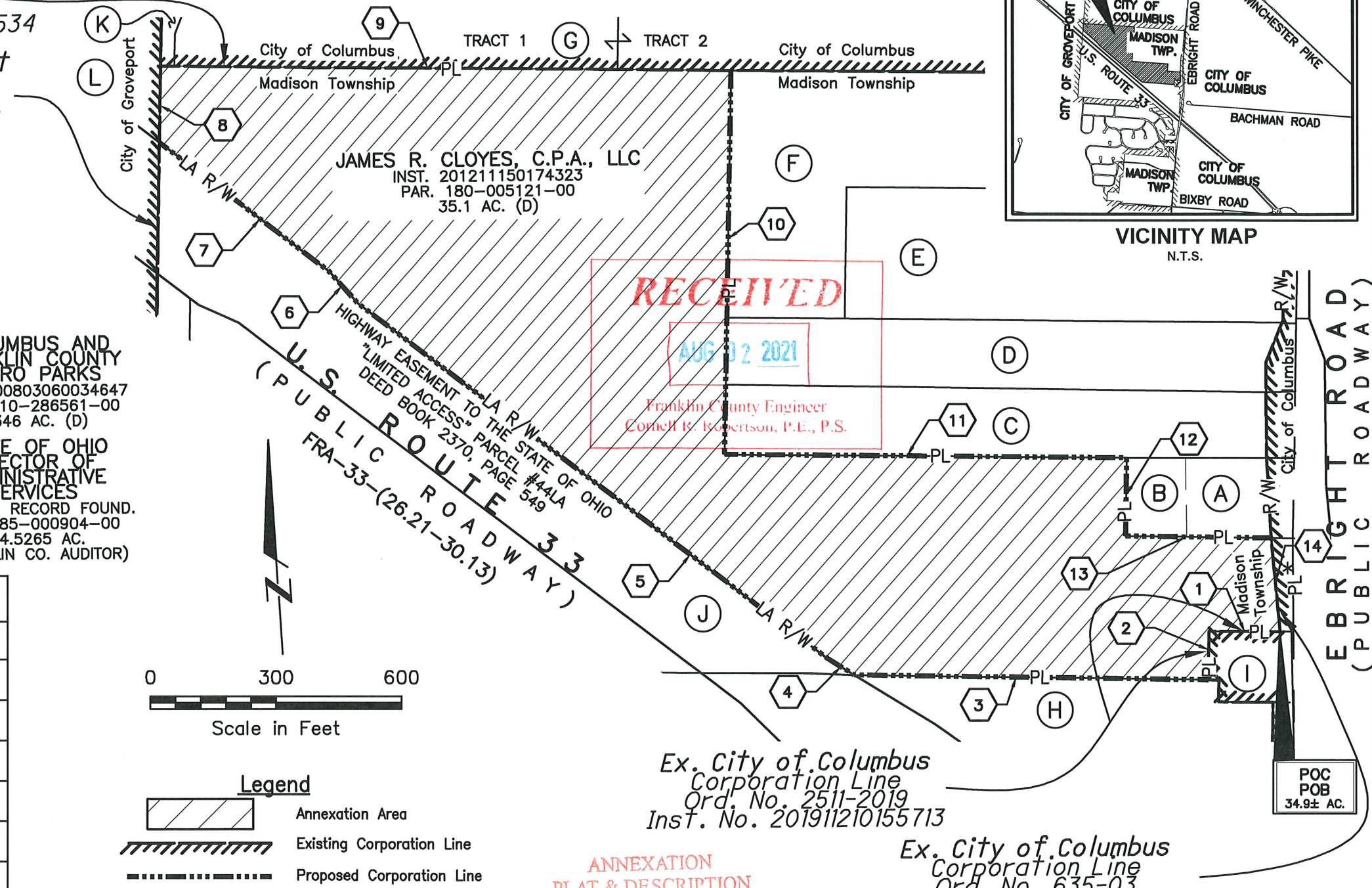

LINE TABLE					
LINE	LENGTH	BEARING	LINE	LENGTH	BEARING
1	167.6±'	N86°07'34"W	8	181.5±'	N04°39'10"E
2	115.3±'	S04°36'26"W	9	1360.3±'	S86°01'03"E
3	844.6±'	N85°42'38"W	10	911.0±'	S04°39'06"W
4	74.5±'	N54°57'02"W	11	959.2±'	S85°59'44"E
5	1400.0±'	N49°25'50"W	12	185.8±'	S04°23'05"W
6	101.8±'	N38°40'21"W	13	345.4±'	S85°44'49"E
7	507.5±'	N49°25'50"W	14	223.1±'	S01°51'48"E

\*STATE HIGHWAY EASEMENT PER  
DEED BOOK 2370, PAGE 547

**BASIS OF BEARINGS**

The bearings shown on this plat are based on a survey of record in Instrument Number 20121150174323. The northerly property line of the proposed annexation area, having a bearing of S86°01'03"E as described in said survey, serves as the designated "basis of bearing" for this plat.

**CONTIGUITY NOTE**

Total Perimeter of Annexation is 7377.8 feet of which 1866.3 feet is contiguous with the City of Columbus by Ordinance Number 1351-02, 2511-2019, and 635-03, giving 25% Perimeter Contiguity.

**NOTE**

This annexation creates an island of unincorporated areas within the limits of the area to be annexed.

This exhibit is for Annexation purposes only and is not to be used for transfer.

**E. P. FERRIS**  
AND ASSOCIATES  
INC

880 KING AVENUE  
COLUMBUS, OHIO 43212  
(614) 299-2999  
(614) 299-2992 (Fax)  
www.EPFERRIS.com



ANNEXATION  
PLAT & DESCRIPTION  
ACCEPTABLE  
CORNELL R. ROBERTSON, P.E., P.S.  
FRANKLIN COUNTY ENGINEER  
By: MS Date 08/03/2021

BY: Matthew Lee Sloat 8/3/21  
Matthew Lee Sloat, P.E., P.S.  
Registered Surveyor No. 8342

DRWN BY TKC CHK BY CK DATE 07-22-2021