

**PERMANENT SIDEWALK EASEMENT AND  
TEMPORARY CONSTRUCTION EASEMENT  
EXHIBIT "A"**

Situated in the State of Ohio, County of Franklin, City of Columbus, being part of Lots 501 and 502 of the Camp Chase Heights Addition of record in Plat Book 7, Page 104 conveyed to Philip E. Miller by deed of record in Instrument Number 200609220189725 of the Recorders office, Franklin County, Ohio and being more particularly described as follows:

**Permanent Sidewalk Easement - 0.007 Acre Tract (311.8 S.F.)**

Beginning at the intersection of the northerly right of way of Roland Sunker Place (45' RW) and the westerly right of way of Hague Avenue (60' RW);

Thence westerly, along the said northerly right of way of Roland Sunker Place, S 86°49'53" W a distance of 16.00 feet to a point;

Thence northerly, crossing the said Lot 502, N 2°46'07" W a distance of 4.17 feet to a point;

Thence northeasterly, crossing the said Lot 502, N 49°21'23" E a distance of 11.40 feet to a point;

Thence northerly, crossing the said Lot 502, N 2°46'07" W a distance of 14.00 feet to a point;

Thence northeasterly, crossing the said Lots 501 and 502, N 15°39'59" E a distance of 15.81 feet to a point;

Thence easterly, crossing the said Lot 501, N 87°13'53" E a distance of 2.00 feet to the said westerly right of way of Hague Avenue;

Thence southerly, along the said westerly right of way of Hague Avenue, S 2°46'07" E a distance of 40.05 feet to the point of beginning, containing 0.007 acres (311.8 S.F.), more or less.

**Temporary Construction Easement - 0.008 Acre Tract (350.7 S.F.)**

*Commencing for reference* at the intersection of the northerly right of way of Roland Sunker Place (45' RW) and the westerly right of way of Hague Avenue (60' RW);

Thence westerly, along the said northerly right of way of Roland Sunker Place, S 86°49'53" W a distance of 16.00 feet to the **True Point of Beginning**;

Thence continuing westerly, along the said northerly right of way of Roland Sunker Place, S 86°49'53" W a distance of 4.00 feet to a point;

Thence northerly, crossing the said Lot 502, N 2°46'07" W a distance of 4.19 feet to a point;

Thence northeasterly, crossing the said Lot 502, N 35°53'28" E a distance of 12.81 feet to a point;

Thence northerly, crossing the said Lots 501 and 502, N 2°46'07" W a distance of 35.00 feet to a point;

Thence easterly, crossing the said Lot 501, N 87°13'53" E a distance of 12.00 feet to the said westerly right of way of Hague Avenue;

Thence southerly, along the said westerly right of way of Hague Avenue, S 2°46'07" E a distance of 9.00 feet to a point;

Thence westerly, crossing the said Lot 501, S 87°13'53" W a distance of 2.00 feet to a point;

Thence southwesterly, crossing the said Lots 501 and 502, S 15°39'59" W a distance of 15.81 feet to a point;

Thence southerly, crossing the said Lot 502, S 2°46'07" E a distance of 14.00 feet to a point;

Thence southwesterly, crossing the said Lot 502, S 49°21'23" W a distance of 11.40 feet to a point;

Thence southerly, crossing the said Lot 502, S 2°46'07" E a distance of 4.17 feet to the **True Point of Beginning**, containing 0.008 acres (350.7 S.F.), more or less.

Subject to all legal rights-of-way and/or easements, if any, of previous record.

The above described area is entirely within Franklin County Auditor's Parcel Number 010-008676, according to the Franklin County Auditor's Office.

Bearings are based on the Ohio State Plane Coordinate System, South Zone, NAD83(CORS96) by VRS/GNSS ODOT observations with the Centerline of Hague Avenue having a bearing of N 2°46'07" W.

This description and survey was prepared and reviewed on June 18, 2015 by Robert A. Bosworth, Registered Surveyor #7750 of Dynotec, Inc.

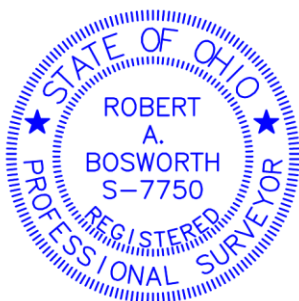

\_\_\_\_\_  
Robert A. Bosworth, P.S.  
Reg. Surveyor No. 7750

\_\_\_\_\_  
Date