

**AN16-001**  
**Madison Township (17.8 ± acres)**  
**Plat Map**

**ANNEXATION OF**  
**17.8 +/- ACRES**  
**From Madison Township, Ohio**  
**to City of Columbus, Ohio**  
 Lying in  
**Section 6, Township 10 North, Range 21 West**  
**Congress Lands**

Scale: 1 inch = 300 Feet

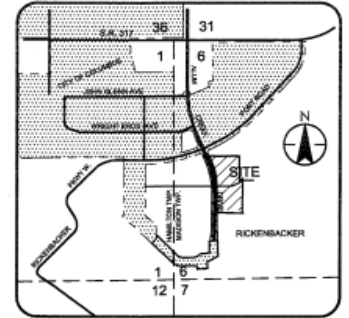

**VICINITY MAP**  
(NOT TO SCALE)

**GENERAL NOTES:**

1. This exhibit is intended to be used as an expedited type II annexation with a total perimeter of 5278 feet, a length of contiguity of 345 feet and a 6.5 percent contiguity with the existing City of Columbus corporation line.
2. The proposed annexation does not create any islands that would be surrounded on all sides by an existing corporation line while the location of said tract would remain in said township.
3. This exhibit was prepared from deed information of record of the Recorder's Office, Franklin County, Ohio, and represents only the territory to be annexed to the City of Columbus and not for transfer of real property.

**ANNEXATION CONTIGUITY:**

|                      |           |
|----------------------|-----------|
| TOTAL PERIMETER      | 5278 feet |
| LENGTH OF CONTIGUITY | 345 feet  |
| PERCENT CONTIGUITY   | 6.5 %     |

**RECEIVED**

APR 15 2016

Franklin County Engineer  
 Dean C. Ringle, P.E., P.S.

ANNEXATION  
 PLAT & DESCRIPTION  
 ACCEPTABLE  
 DEAN C. RINGLE, P.E., P.S.  
 FRANKLIN COUNTY ENGINEER  
 By FR Date 4/15/16

**LEGEND**

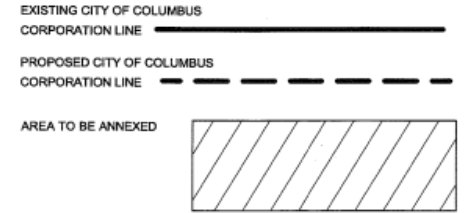

Prepared by:  
**Stantec**  
 1500 Lake Shore Drive  
 Columbus, Ohio 43204  
 Phone: (614) 488-4383  
 Fax: (614) 466-4387

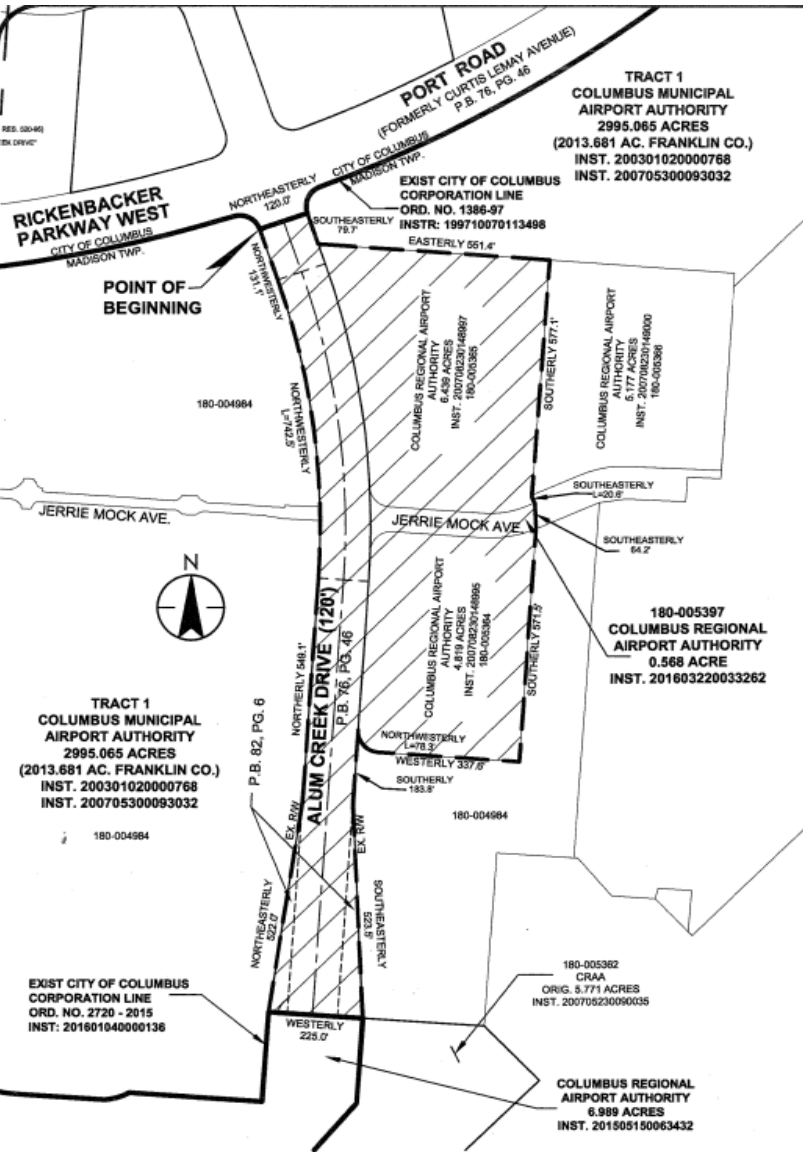
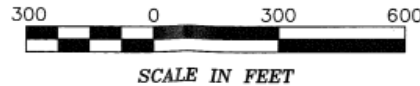

Copyright Reserved  
 The Contractor shall verify and be responsible for all dimensions. DO NOT scale the drawing - any errors or omissions shall be reported to Stantec without delay.  
 The Copyrights to all designs and drawings are the property of Stantec. Reproduction or use for any purposes other than that authorized by Stantec is forbidden.

U:\17240228\Task 1021 Jerry Mock Ave Split & Annexation\172410228 Annex.dwg Ames Alum ACT 1-2 Apr 15, 2016 - 10:31:27am mdellone