

ANNEXATION
PLAT & DESCRIPTION
ACCEPTABLE
CORNELL R. ROBERTSON, P.E., P.S.
FRANKLIN COUNTY ENGINEER
By JRH/GMA Date 10-20-2022

**Proposed 2.9 ± Acre Annexation
from Plain Township
to the City of Columbus**

Situated in the State of Ohio, County of Franklin, Township of Plain, being part of Section 6, Township 2, Range 16, United States Military Lands and being part of that 3.00 acre tract of land as conveyed to Steven L. Dunbar and Cindy L. Ward in Official Record 16550E06 & Official Record 16751C09, said 2.9± acres more particularly described as follows:

Beginning, at a point on the east line of said 3.00 acre tract, the west line of that 0.574 acre tract of land as conveyed to Lisa Wu Fate in Instrument Number 202108270153572, on the northerly right-of-way line of Central College Road as referenced in Road Record 8, Pg. 194, being in the northerly City of Columbus Corporation Line (Case No. 48-03, Ord. No. 0006-2004, Instrument Number 200403110053675);

Thence **N 85°37'11" W**, across said 3.00 acre tract, with the northerly right of way of said Central College Road, with said northerly City of Columbus Corporation Line, **200.00±** to a point on the west line of said 3.00 acre tract, the east line of that 0.172 acre tract of land conveyed to the City of Columbus in Instrument Number 200712180215640, and being on a southwesterly corner of the City of Columbus Corporation Line (Case No. 23-02, Ord. No. 1880-02, Instrument Number 200303200030585);

Thence **N 03°27'42" E**, with the west line of said 3.00 acre tract, the east line of said 0.172 acre tract, the east line of that 1.984 acre tract of land conveyed to Christoff Land & Development in Instrument Number 201810250145804, the east line of Reserve "I" as dedicated in Plat Book 105, Pg. 86 of the Upper Albany West Section 1 subdivision, and an easterly City of Columbus Corporation Line (Case No. 23-02, Ord. No. 1880-02, Instrument Number 200303200030585), **623.0 feet±** to the northwest corner of said 3.00 acre tract, an angle point of that 21.705 acre tract of land as conveyed to Andrew Reserve, LLC in Instrument Number 202011200185588, on the east line of said Reserve "I", being an angle point of said City of Columbus Corporation Line (Case No. 28-96, Ord. No. 2647-96, Official Record 34003G15);

Thence **S 85°19'11" E**, with the north line of said 3.00 acre tract, a south line of said 21.705 acre tract, with said southerly City of Columbus Corporation Line, **200.00 feet±** to the northeast corner of said 3.00 acre tract, an angle point of said 21.705 acre tract, and an angle point of said City of Columbus Corporation Line;

Thence **S 03°27'49" W**, with the east line of said 3.00 acre tract, a west line of said 21.705 acre tract, the west line of said 0.574 acre tract, with said westerly City of Columbus Corporation Line, **622.0 feet±** to the **Point of Beginning**. Containing **2.9± acres**.

The above description was prepared by Advanced Civil Design Inc. on October 18, 2022 and is based on existing Franklin County Auditor records and Franklin County Recorder's records.

The total length of the annexation perimeter is 1,645± feet, of which 1,425.5± feet are contiguous with existing City of Columbus Corporation lines, being 87±% contiguous.

All references used in this description can be found at the Recorder's Office, Franklin County, Ohio.

This is not to be used for the transfer of land and is for annexation purposes only.

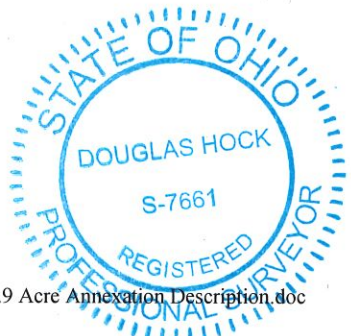

ADVANCED CIVIL DESIGN, INC.

[Signature] 10/18/22
Douglas R. Hock, P.S. 7661 Date: