

TEMPORARY CONSTRUCTION EASEMENT
0.0004 Acre Tract (16.0 S.F.)
EXHIBIT "A"

Situated in the State of Ohio, County of Franklin, City of Columbus, being part of Lot 832 of Wicklow Extension Addition of record in Plat Book 7, Page 65 conveyed to Jessica B. Schibley by deed of record in Instrument Number 200503110044989 of the Recorders office, Franklin County, Ohio and being more particularly described as follows:

Commencing for reference at the northwest corner of the said Lot 832 and in the easterly right of way of Hague Avenue (70' RW);

Thence along the said easterly right of way of Hague Avenue, S 2°46'07" E a distance of 14.02 feet to the **True Point of Beginning**;

Thence easterly, crossing the said Lot 832, N 87°13'53" E a distance of 2.00 feet to a point;

Thence southerly, crossing the said Lot 832, S 2°46'07" E a distance of 8.00 feet to a point;

Thence westerly, crossing the said Lot 832, S 87°13'53" W a distance of 2.00 feet to the said easterly right of way of Hague Avenue;

Thence northerly, along the said easterly right of way of Hague Avenue, N 2°46'07" W a distance of 8.00 feet to the **True Point of Beginning**, containing 0.0004 Acres (16.0 S.F.) more or less.

Subject to all legal rights-of-way and/or easements, if any, of previous record.

The above described area is entirely within Franklin County Auditor's Parcel Number 010-008944, according to the Franklin County Auditor's Office.

Bearings are based on the Ohio State Plane Coordinate System, South Zone, NAD83(CORS96) by VRS/GNSS ODOT observations with the Centerline of Hague Avenue having a bearing of N 2°46'07" W.

This description and survey was prepared and reviewed on June 18, 2015 by Robert A. Bosworth, Registered Surveyor #7750 of Dynotec, Inc.

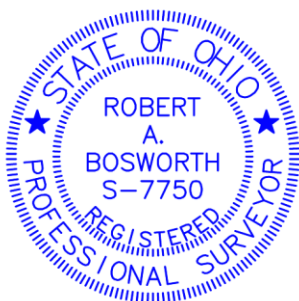

Robert A. Bosworth, P.S.
Reg. Surveyor No. 7750

Date