

ANNEXATION  
PLAT & DESCRIPTION  
ACCEPTABLE  
CORNELL R. ROBERTSON, P.E., P.S.  
FRANKLIN COUNTY ENGINEER

RECEIVED

APR 11 2023

By JRH Date 04/11/2023

Proposed 22.3+/- Acre Annexation  
from Madison Township  
to the City of Columbus

Franklin County Engineer  
Cornell R. Robertson, P.E., P.S.

-1-

Situated in the State of Ohio, County of Franklin, Township of Madison, being part of Section 14, Township 11, Range 21, Congress Lands and containing 22.3+/- acres of land, more or less, said 22.3+/- acres being part of 33.32 acre tract of land conveyed to Michael P. Barr of record in Instrument Number 201609060119019, said 22.3+/- acres more particularly described as follows:

**Beginning for Reference**, at a Franklin County Monument found, "FCGS 9944", being the southwesterly corner of said 33.32 acre tract, being at the southwesterly corner of Section 14, being the northwesterly corner of Section 23, being the northeasterly corner of Section 22, being the southeasterly corner of Section 15 and being in the right-of-way Bixby Road and U.S. Rt. 33 (Columbus-Lancaster Road) as shown on the O.D.O.T. plans FRA-33-(26.21-30.13);

Thence N 04° 24' 22" E, along the westerly line of said 33.32 acre tract and said Section 14, along the easterly line of said Section 15 and across the right-of-way of said U.S. Route 33 (Columbus-Lancaster Road), 384.7 feet+/- to a monument found at an angle point in the northeasterly LA/RW line of said U.S. Rt. 33 (Columbus-Lancaster Road) and at an angle point in a City of Columbus Corporation Line (Case No. 8-00, Ord. No. 1509-00, Instr. No. 200009130184750), the **True Point of Beginning**;

Thence along the common lines of said 33.32 acre tract, Original 3 acre tract and said City of Columbus Corporation Line (Case No. 8-00, Ord. No. 1509-00, Instr. No. 200009130184750), the following three (3) courses;

N 04° 24' 22" E, 725.3 feet+/- to an angle point;

S 85° 35' 38" E, 1308.0 feet+/- to an angle point;

S 04° 24' 22" W, 892.3 feet+/- to a point in a future relocation of Bixby Road;

Thence across said 33.32 acre tract and along said future relocation of Bixby Road the following seven (7) courses;

N 62° 15' 37" W, 9.9 feet+/- to an angle point;

N 63° 47' 14" W, 472.3 feet+/- to an angle point;

N 64° 01' 42" W, 110.3 feet+/- to an angle point;

N 84° 04' 53" W, 224.5 feet+/- to an angle point;

S 70° 37' 50" W, 112.2 feet+/- to an angle point;

S 85° 43' 43" W, 385.7 feet+/- to an angle point;

N 43° 29' 05" W, 66.6 feet+/- to the **True Point of Beginning**. Containing 22.3+/- acres.

The above description was prepared by Advanced Civil Design Inc. on January 3, 2023 and is based on information obtained from the Franklin County Auditor's and Franklin County Recorder's Office and information from an actual field survey performed by Advanced Civil Design, Inc. in December of 2022.

The total length of the annexation perimeter is 4,307.1± feet, of which 2,925.6± feet are contiguous with existing City of Columbus Corporation lines, being 67.9±% contiguous.

All references used in this description can be found at the Recorder's Office, Franklin County, Ohio.

This is not to be used for the transfer of land and is for annexation purposes only.

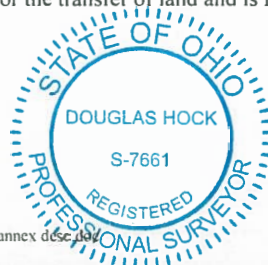

ADVANCED CIVIL DESIGN, INC.

*WmH* 4/5/23  
Douglas R. Hock, P.S. 7661 Date:

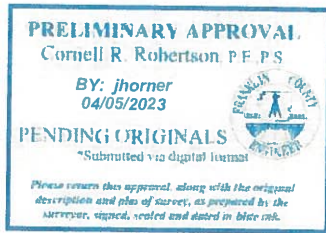

**Proposed 22.3+/- Acre Annexation  
from Madison Township  
to the City of Columbus**

-1-

Situated in the State of Ohio, County of Franklin, Township of Madison, being part of Section 14, Township 11, Range 21, Congress Lands and containing 22.3+/- acres of land, more or less, said 22.3+/- acres being part of 33.32 acre tract of land conveyed to Michael P. Barr of record in Instrument Number 201609060119019, said 22.3+/- acres more particularly described as follows:

**Beginning for Reference**, at a Franklin County Monument found, "FCGS 9944", being the southwesterly corner of said 33.32 acre tract, being at the southwesterly corner of Section 14, being the northwesterly corner of Section 23, being the northeasterly corner of Section 22, being the southeasterly corner of Section 15 and being in the right-of-way Bixby Road and U.S. Rt. 33 (Columbus-Lancaster Road) as shown on the O.D.O.T. plans FRA-33-(26.21-30.13);

Thence **N 04° 24' 22" E**, along the westerly line of said 33.32 acre tract and said Section 14, along the easterly line of said Section 15 and across the right-of-way of said U.S. Route 33 (Columbus-Lancaster Road), **384.7 feet+/-** to a monument found at an angle point in the northeasterly LA/RW line of said U.S. Rt. 33 (Columbus-Lancaster Road) and at an angle point in a City of Columbus Corporation Line (Case No. 8-00, Ord. No. 1509-00, Instr. No. 200009130184750), the **True Point of Beginning**;

Thence along the common lines of said 33.32 acre tract, Original 3 acre tract and said City of Columbus Corporation Line (Case No. 8-00, Ord. No. 1509-00, Instr. No. 200009130184750), the following three (3) courses;

**N 04° 24' 22" E, 725.3 feet+/-** to an angle point;

**S 85° 35' 38" E, 1308.0 feet+/-** to an angle point;

**S 04° 24' 22" W, 892.3 feet+/-** to a point in a future relocation of Bixby Road;

Thence across said 33.32 acre tract and along said future relocation of Bixby Road the following seven (7) courses;

**N 62° 15' 37" W, 9.9 feet+/-** to an angle point;

**N 63° 47' 14" W, 472.3 feet+/-** to an angle point;

**N 64° 01' 42" W, 110.3 feet+/-** to an angle point;

**N 84° 04' 53" W, 224.5 feet+/-** to an angle point;

**S 70° 37' 50" W, 112.2 feet+/-** to an angle point;

**S 85° 43' 43" W, 385.7 feet+/-** to an angle point;

**N 43° 29' 05" W, 66.6 feet+/-** to the **True Point of Beginning**. Containing **22.3+/- acres**.

The above description was prepared by Advanced Civil Design Inc. on January 3, 2023 and is based on information obtained from the Franklin County Auditor's and Franklin County Recorder's Office and information from an actual field survey performed by Advanced Civil Design, Inc. in December of 2022.

The total length of the annexation perimeter is 4,307.1± feet, of which 2,925.6± feet are contiguous with existing City of Columbus Corporation lines, being 67.9±% contiguous.

All references used in this description can be found at the Recorder's Office, Franklin County, Ohio.

This is not to be used for the transfer of land and is for annexation purposes only.

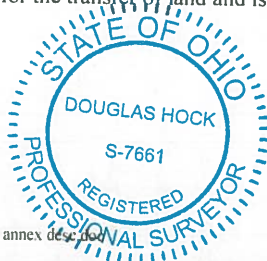

ADVANCED CIVIL DESIGN, INC.

*Wm H* 4/5/23  
Douglas R. Hock, P.S. 7661 Date: