

MAP ANNEXATION AN03-043 86.0 Acres in Madison Township Homewood Corporation

PLAT OF ANNEXATION
SECTION 19, TOWNSHIP 15, RANGE 20
UNITED STATES MILITARY LANDS
TOWNSHIP OF MADISON, FRANKLIN COUNTY, OHIO

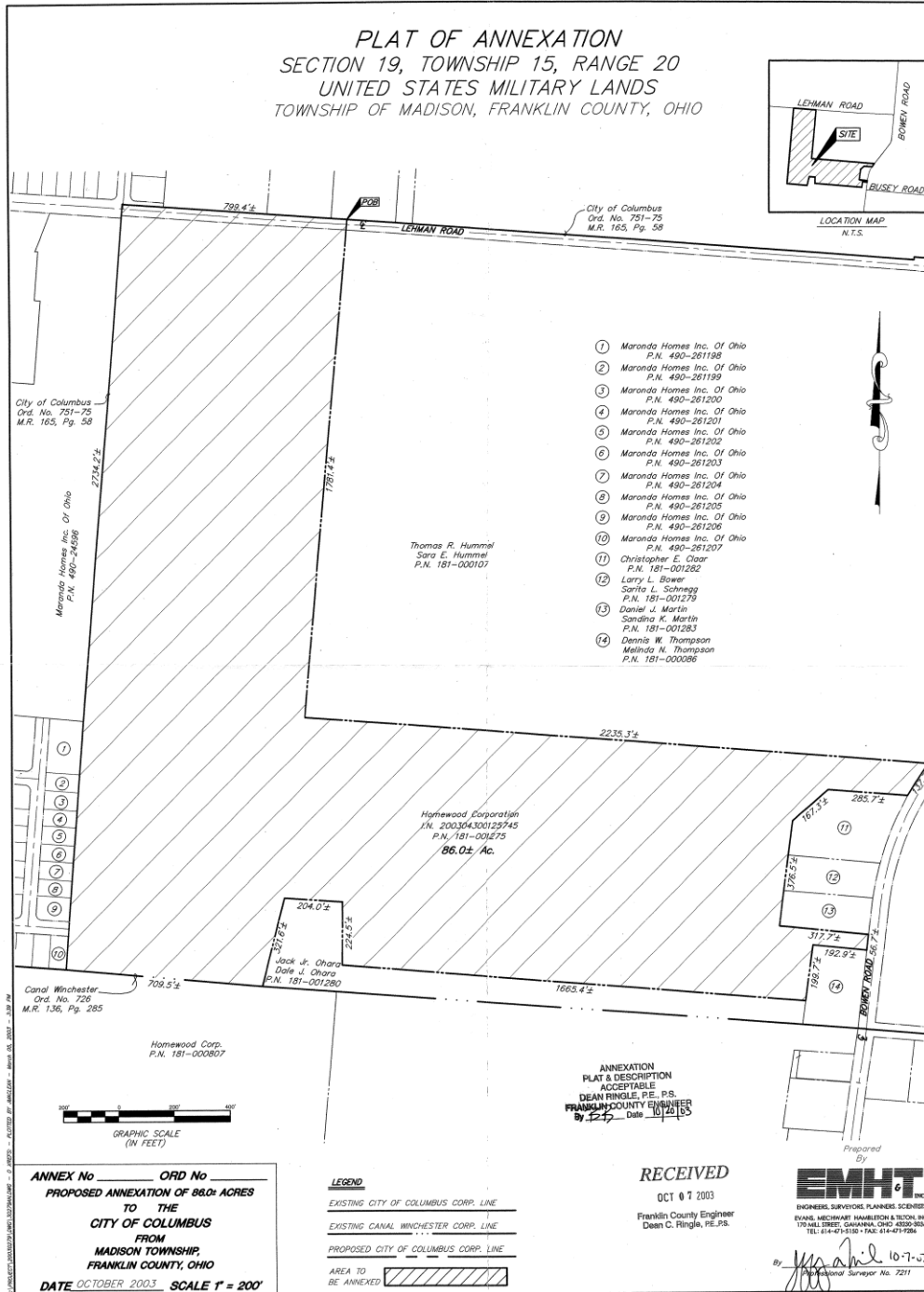
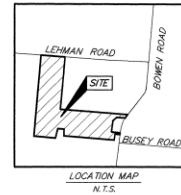

ANNEX No _____ **ORD No** _____
**PROPOSED ANNEXATION OF 86.0± ACRES
TO THE
CITY OF COLUMBUS
FROM
MADISON TOWNSHIP,
FRANKLIN COUNTY, OHIO**
DATE OCTOBER 2003 SCALE 1" = 200'

LEGEND
EXISTING CITY OF COLUMBUS CORP. LINE
EXISTING CANAL WINCHESTER CORP. LINE
PROPOSED CITY OF COLUMBUS CORP. LINE
AREA TO BE ANNEXED

FRANKLIN COUNTY ENGINEER DEAN C. RINGLE, P.E., P.S. 10/1/03
HOMECORP CORPORATION/EASTSIDE NURSERY ANNEXATION/2003/02/27

