

PROPOSED ANNEXATION OF 279.5 ACRES

FROM THE TOWNSHIPS OF BROWN AND NORWICH TO THE CITY OF COLUMBUS
 VIRGINIA MILITARY SURVEY NUMBERS 5273, 6542, 6635, 6637 AND 6616
 TOWNSHIPS OF BROWN AND NORWICH, COUNTY OF FRANKLIN, STATE OF OHIO

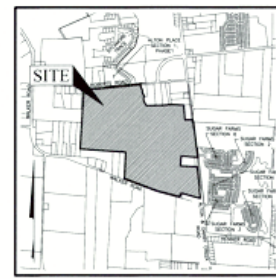
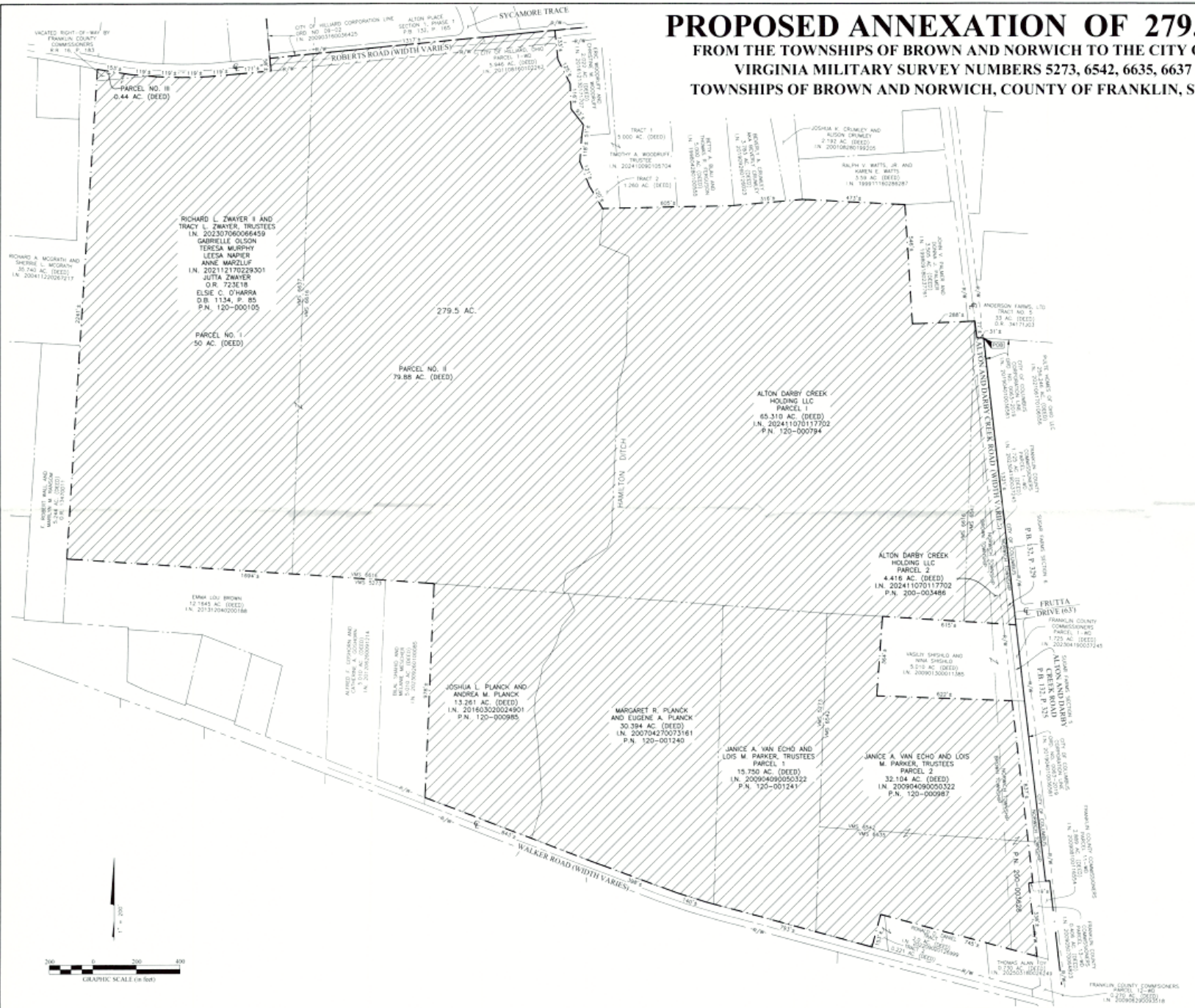

LOCATION MAP AND BACKGROUND DRAWING
NOT TO SCALE

RECEIVED

DEC 04 2025

FRANKLIN COUNTY ENGINEER
Adam W. Fowler, P.E., P.S.

ANNEXATION
PLAT & DESCRIPTION
ACCEPTABLE
ADAM W. FOWLER, P.E., P.S.
FRANKLIN COUNTY ENGINEER
DATE: 12/04/25

- Existing City of Hilliard Corporation Line
- Existing City of Columbus Corporation Line
- - - Proposed City of Columbus Corporation Line
- ▨ Area of Annexation

Norwich Township = 4.8 Acres
 Brown Township = 274.7 Acres

Contiguity Note:
 Total perimeter of annexation area is 17489 ± feet, of which 1321 ± feet is contiguous with the City of Columbus by Ordinance Numbers 0863-2018, giving 7.6% ± perimeter contiguity. This annexation does not create islands of unincorporated areas within the limits of the area to be annexed.

This exhibit was prepared using record information from the Franklin County Engineer, Recorder and Auditor, and is not intended to be used for the transfer of real property.



Matthew A. Kirk
 Professional Surveyor No. 7865
 mkirk@emht.com



EMHT	Date: December 1, 2025
Engineering - Surveying - Planning - Landmarks 8800 West Albany Road, Columbus, OH 43244 Phone 614.778.8800 Fax 614.778.3448 emht.com	Scale: 1" = 200'
	Job No: 2025-0176
	Sheet: 1 of 1
REVISIONS	
NO.	DATE DESCRIPTION