

ANNEXATION AN15-005
± 13.87 Acres / Plain Township
Warren and Carolyn Roberts
(5440 Morse Road)



Evans, Machwart, Hambleton & Thon, Inc.
 Engineers • Surveyors • Planners • Scientists
 5500 New Albany Road, Columbus, OH 43204
 Phone: 614.775.4520 Toll Free: 888.775.3348
 emht.com

PROPOSED ANNEXATION OF 13.87± ACRES
TO CITY OF COLUMBUS FROM PLAIN TOWNSHIP
QUARTER TOWNSHIP 3, TOWNSHIP 2, RANGE 16, UNITED STATES MILITARY LANDS
TOWNSHIP OF PLAIN, COUNTY OF FRANKLIN, STATE OF OHIO

Date: December 9, 2014

Job No. 2014-1560

Scale: 1" = 200'

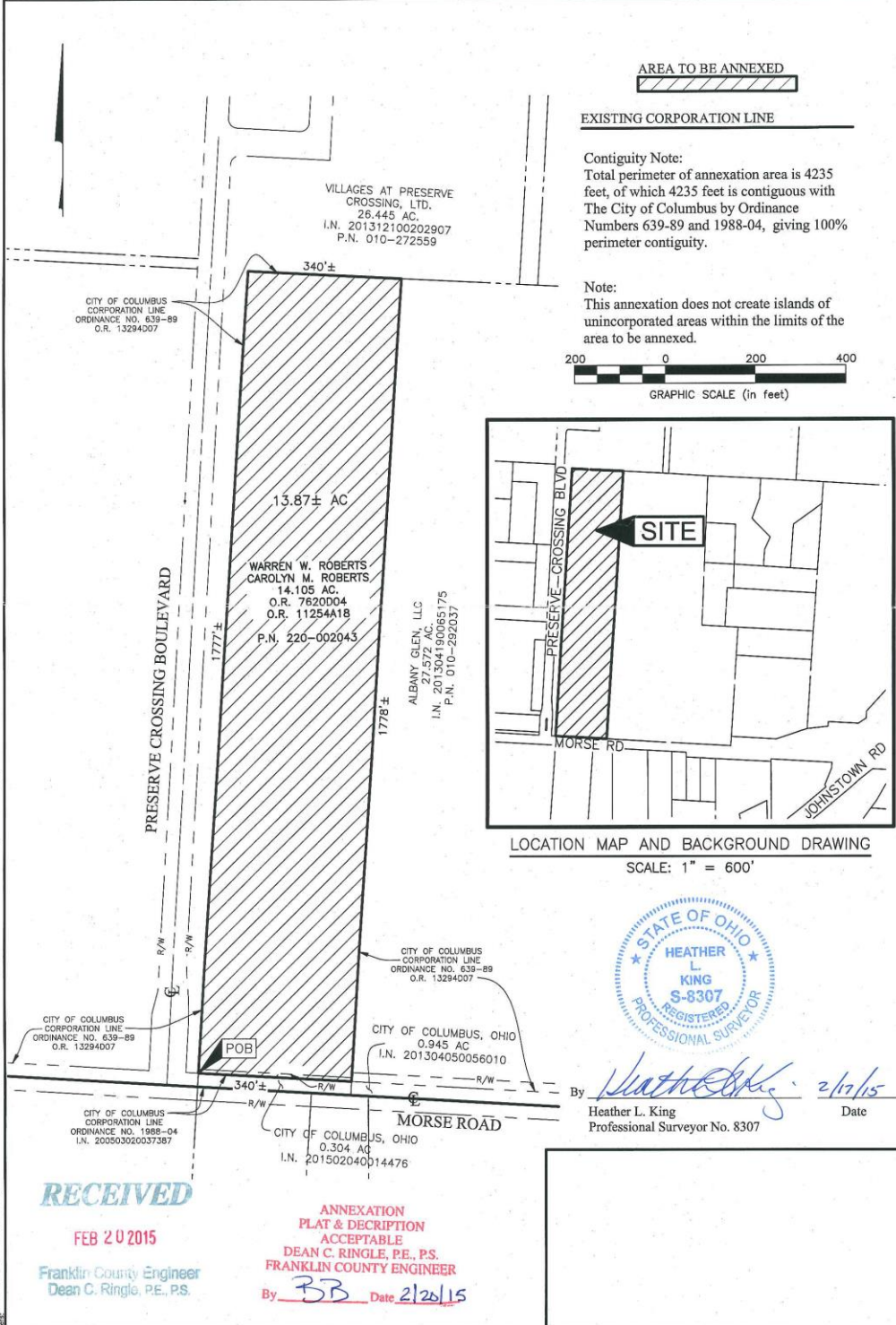

J:\2014\1560\DWG\CAD\HEATHER\20141560-VS-ANNX-01.DWG plotted by KING on 2/17/2015 9:53:13 AM last saved by KING on 2/17/2015 9:51:48 AM