

**WATERLINE EASEMENT
0.045 ACRE**

Situated in the State of Ohio, County of Delaware, Township of Liberty, lying in Farm Lot 14, Quarter Township 3, Township 3, Range 19, United States Military District, being on, over, and across that tract conveyed to City of Columbus by deed of record in Deed Book 248, Page 110 (all references are to the records of the Recorder's Office, Delaware County, Ohio) and being more particularly described as follows:

Beginning, for reference, at the northwesterly corner of that 5.010 acre tract conveyed as Parcel Two to Franklin County Commissioners, Franklin County, Ohio and City of Columbus, Ohio by deed of record in Official Record 336, Page 2538, the southwesterly corner of that 129.467 acre tract conveyed to Franklin County Commissioners, Franklin County, Ohio and City of Columbus, Ohio by deed of record in Deed Book 668, Page 236, and being in the easterly line of said City of Columbus tract, the line common to said Farm Lot 14 and Farm Lot 13, and in the centerline of that portion of vacated State Route 750, of record in Journal Entry 06-DEL-2008-01;

Thence North 86° 50' 22" West, with said vacated centerline and crossing said City of Columbus tract, a distance of 704.47 feet to the TRUE POINT OF BEGINNING;

Thence continuing across said City of Columbus tract, the following course and distances:

South 03° 00' 13" West, a distance of 65.12 feet to a point;

South 86° 59' 47" East, a distance of 3.96 feet to a point;

South 03° 00' 13" West, a distance of 20.42 feet to a point;

North 86° 59' 47" West, a distance of 2.70 feet to a point;

South 03° 00' 13" West, a distance of 25.59 feet to a point;

North 86° 59' 47" West, a distance of 17.33 feet to a point;

North 03° 00' 13" East, a distance of 25.59 feet to a point;

North 86° 59' 47" West, a distance of 2.89 feet to a point;

North 03° 00' 13" East, a distance of 20.42 feet to a point;

South 86° 59' 47" East, a distance of 6.96 feet to a point;

North 03° 00' 13" East, a distance of 86.44 feet to a point;

South 86° 59' 47" East, a distance of 12.00 feet to a point; and

South 03° 00' 13" West, a distance of 21.32 feet to the TRUE POINT OF BEGINNING, containing 0.045 acre, more or less.



EVANS, MECHWART, HAMBLETON & TILTON, INC.

Feb. 9, 2024

Brandon R. King
Professional Surveyor No. 8772

Date



Evans, Meecham, Hambleton & Tilton, Inc.
Engineers - Surveyors - Planners - Scientists
5900 New Albany Road, Columbus, OH 43054
Phone: 614.775.4500 Fax: 614.775.3648
emht.com

WATERLINE EASEMENT

FARM LOT 14, QUARTER TOWNSHIP 3, TOWNSHIP 3, RANGE 19
UNITED STATES MILITARY DISTRICT
TOWNSHIP OF LIBERTY, COUNTY OF DELAWARE, STATE OF OHIO

Date: February 9, 2024 Scale: 1" = 20' Job No: 2024-0081 Sheet No: 1 of 1

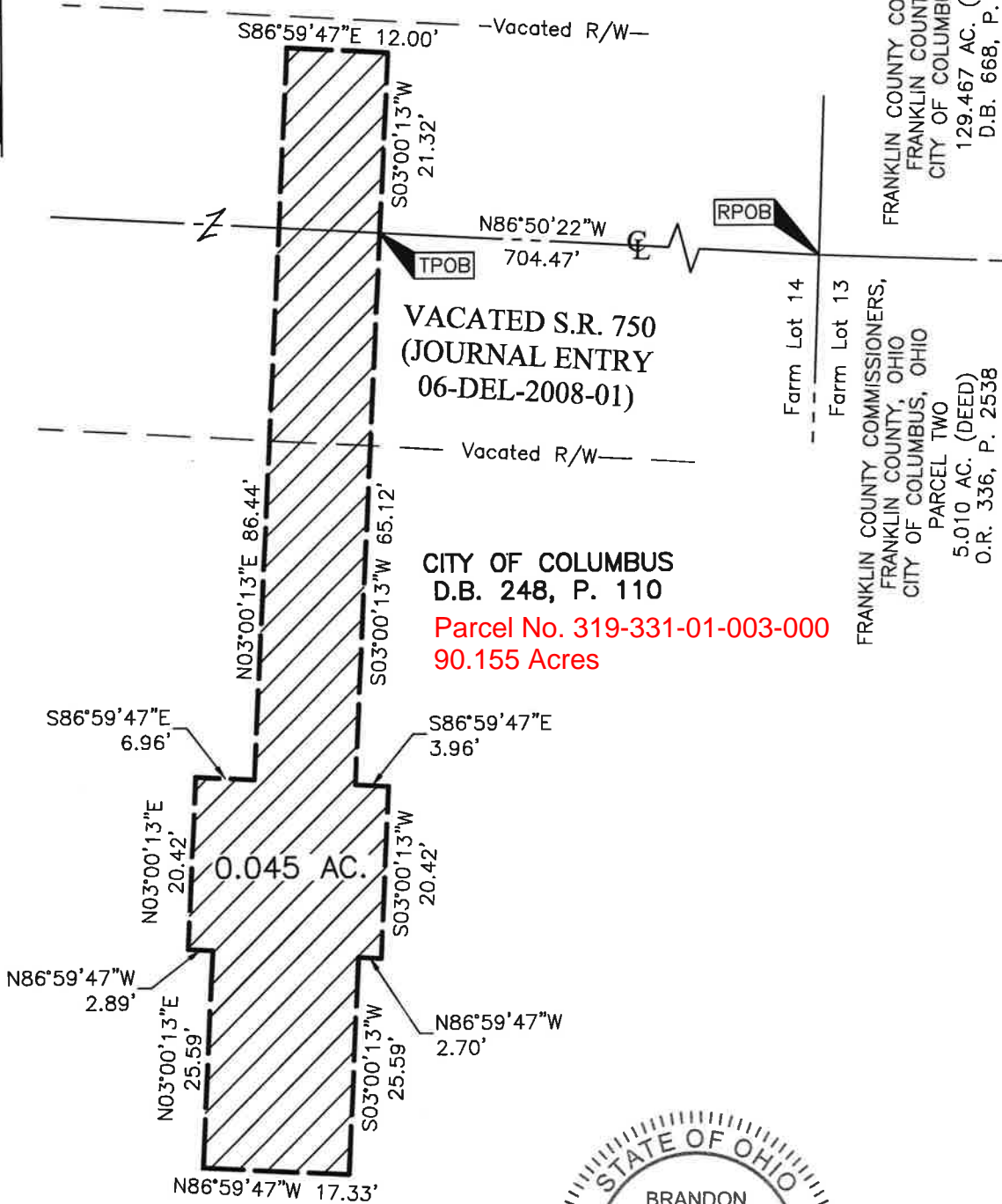
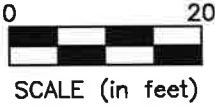

FRANKLIN COUNTY COMMISSIONERS,
FRANKLIN COUNTY, OHIO
CITY OF COLUMBUS, OHIO
129.467 AC. (DEED)
D.B. 668, P. 236

FRANKLIN COUNTY COMMISSIONERS,
FRANKLIN COUNTY, OHIO
CITY OF COLUMBUS, OHIO
PARCEL TWO
5.010 AC. (DEED)
O.R. 336, P. 2538

VACATED S.R. 750
(JOURNAL ENTRY
06-DEL-2008-01)

CITY OF COLUMBUS
D.B. 248, P. 110
Parcel No. 319-331-01-003-000
90.155 Acres



By Brandon R. King
Professional Surveyor No. 8772
bking@emht.com

2-9-2024
Date

J:\20240081\DWG\CASHEETS\EASEMENTS\20240081-VS-ESMT-WATR-01.DWG plotted by KING, BRANDON on 2/9/2024 3:38:32 PM last saved by BKING on 2/9/2024 2:56:38 PM