

LINE TABLE:

LINE	BEARING	DISTANCE
L1	N 23°21'37" W	12.96'
L2	N 81°56'58" E	109.84'
L3	S 13°46'49" W	13.47'
L4	S 81°56'58" W	101.41'

GRAPHIC SCALE

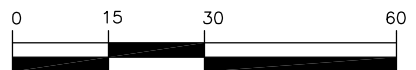

(IN FEET)
1 inch = 30 ft.

BASIS OF BEARINGS:

THE BEARINGS ARE BASED ON THE OHIO STATE PLANE COORDINATE SYSTEM, SOUTH ZONE, NAD83 (CORS). SAID BEARINGS ORIGINATED FROM A FIELD TRAVERSE WHICH WAS REFERENCED TO SAID COORDINATE SYSTEM BY GPS OBSERVATIONS AND OBSERVATIONS OF SELECTED STATIONS IN THE OHIO DEPARTMENT OF TRANSPORTATION VIRTUAL REFERENCE STATION NETWORK. THE PORTION OF THE WESTERLY LINE OF LOT 138, HAVING A BEARING OF N 23°21'37" W AND MONUMENTED AS SHOWN HEREON, IS DESIGNATED THE "BASIS OF BEARING" FOR THIS PLAT.

EXHIBIT OF
**12.5 FEET WIDE
EASEMENT VACATION**

LYING IN
PART OF LOT 183
FOREST HILLS EAST NO. 2
PLAT BOOK 49, PAGE 89
CITY OF COLUMBUS,
COUNTY OF FRANKLIN
STATE OF OHIO

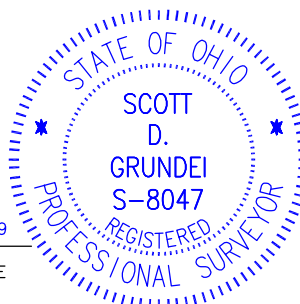

LS LANDMARK SURVEY
GI GROUP, INCORPORATED

2099 WEST FIFTH AVENUE, COLUMBUS, OHIO 43212
PHONE: (614) 485-9000 FAX: (614) 485-9003

DATE: 10/24/19 FILE NO. 1906.6701-01

DRAWN BY: DJH

Scott D. Grundeil

10/24/19

SCOTT D. GRUNDEIL, P.S.
REGISTERED SURVEYOR NO. 8047

DATE