

**PARCEL 110A-WD
JOYCE AVENUE IMPROVEMENTS
IN THE NAME AND FOR THE USE OF THE CITY OF COLUMBUS**

Situated in the State of Ohio, County of Franklin, City of Columbus and being in Quarter Township 4, Township 1, Range 18 of the United States Military Lands and being part of a tract of land conveyed to Columbus City Employees Local 1632 by deed of record in Deed Book 3370, Page 488, all references to the Recorder's Office, Franklin County, Ohio, also containing part of lot C of Windsor Atcheson Partition of record in Plat Book 3, Page 268 and being a parcel of land located on the left side of the centerline of construction for Joyce Avenue, made for the City of Columbus by Dynotec, Inc., and recorded in Plat Book _____, Page _____, and being further bounded and described as follows:

Beginning at an iron pin set in a proposed monument box at the northeasterly corner of a tract conveyed to the City of Columbus by deed of record in Deed Book 3738, Page 782 and being at centerline station 90+48.12 on Joyce Avenue;

Thence along the northerly line of the said City of Columbus tract, N 86°38'20" W a distance of 40.65 feet to an iron pin set, being 40.01 feet left of station 90+40.93;

Thence crossing the said Columbus City Employees Local 1632 tract, N 13°35'41" E a distance of 167.73 feet to an iron pin set on the southerly line of a tract conveyed to Joy Enterprises, Inc. by deed of record in Official Record 22022F16 and being 40.00 feet left of station 92+08.63;

Thence along the said southerly line, S 86°38'20" E a distance of 40.65 feet to a railroad spike set at centerline station 92+15.85 on Joyce Avenue;

Thence along the centerline of Joyce Avenue, S 13°35'41" W a distance of 167.73 feet to the point of beginning.

The above described area is contained within the Franklin County Auditor's Parcel Number 010-098890. Within said boundary is 0.154 acres, more or less, of which 0.116 acres is in the present road occupied, for a net take of 0.038 acres, more or less.

This description and survey was prepared from field observations made in March 2009 and reviewed on June 18, 2014 by Robert A. Bosworth, Registered Surveyor #7750.

All iron pins set are 5/8" rebar (30" long) with a yellow plastic cap stamped "R/W DYNOTEC, INC" and are to be placed at the completion of construction.

The basis of bearings in this description is based on GPS observations using the Ohio CORS Network (Ohio South Zone) to determine a grid bearing in the NAD83 (96CORS adjustment) state plane coordinate system. The Columbus, Mount Vernon, and McConnelsville CORS stations were used in determining the grid bearing, and establishing a bearing along the centerline of Joyce Avenue to be N 13°32'54"E (north of 17th Avenue).

All stations and offsets are referenced to the centerline of right-of-way and construction as filed with the City of Columbus and designated as "2906- E".

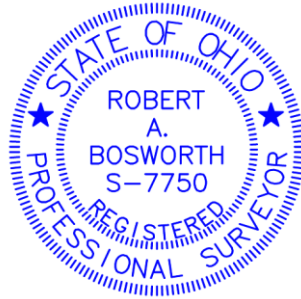

Robert A. Bosworth, P.S.
Reg. Surveyor No. 7750

Date