

**PROPOSED ANNEXATION OF 34.9 +/- ACRES
FROM MADISON TOWNSHIP TO THE CITY OF COLUMBUS**

Located in State of Ohio, County of Franklin, Township of Madison,
Section 15, Township 11, Range 21, Congress Lands

- (A) SHIRLEY A ADKINS
O.R.V. 10613 PG. G02
PAR. 180-000859-00
1.05 AC. (D)
- (B) SHIRLEY A ADKINS
O.R.V. 17292 PG. C03
PAR. 180-000859-00
0.66 AC. (D)
- (C) WILLIAM R &
ANGELA G LUTZ
INST. 201301090004938
PAR. 180-005101-00
4.954 AC. (D)

Ex. City of Columbus
Corporation Line
Ord. No. 1351-02
Inst. No. 200212260331534

Ex. City of Groveport
Corporation Line
Ord. No. 532
Misc. Record 137-404

- (D) ROBERT C &
JUDITH A JOHNSON
INST. 201305080076169
PAR. 180-000002-00
REMAINDER OF 9.954 AC. (D)
- (E) BRENT E &
JODIE S CONRAD
O.R.V. 34394 PG. G15
PAR. 180-005242-00
5.00 AC. (D)
- (F) PAULA S SMITH
INST. 199902030027902
PAR. 180-000190-00
13.00 AC. (D)
- (G) CVETA NASTEV TR
INST. 200601130009208
PAR. 010-264986-00
19 AC. (D) (TRACT 1)
28 AC. (D) (TRACT 2)

- (H) AMERI-STOR CANAL
WINCHESTER LLC
INST. 201504170049672
PAR. 180-000271-00
9.84 AC. (D)
EXCEPTING
0.185 AC. (D)
- (I) THOMAS M DIXON
INST. 200807250114217
PAR. 535-300435-00
0.75 AC. (D)
- (J) RONALD T. HILL &
MARGARET J. SPURLOCK
D.B. 3363 PG. 495
O.R.V. 12628 PG. G18
PAR. 180-000015-00
REMAINDER OF 32.36 AC. (D)
REMAINDER OF 28 AC. (D)

- (K) COLUMBUS AND
FRANKLIN COUNTY
METRO PARKS
INST. 200803060034647
PAR. 010-286561-00
0.346 AC. (D)
- (L) STATE OF OHIO
DIRECTOR OF
ADMINISTRATIVE
SERVICES
NO DEED RECORD FOUND.
PAR. 185-000904-00
154.5265 AC.
(FRANKLIN CO. AUDITOR)

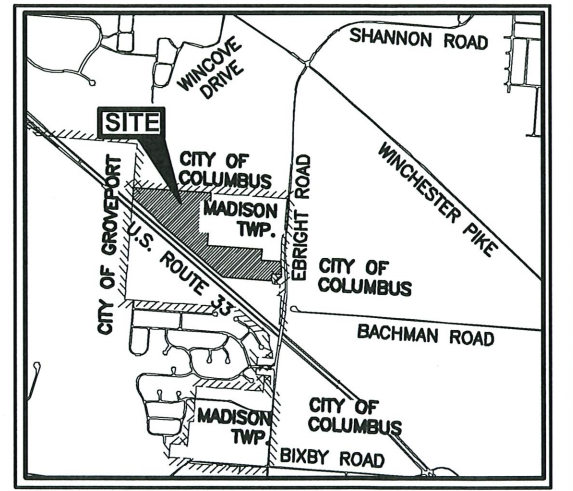

VICINITY MAP
N.T.S.

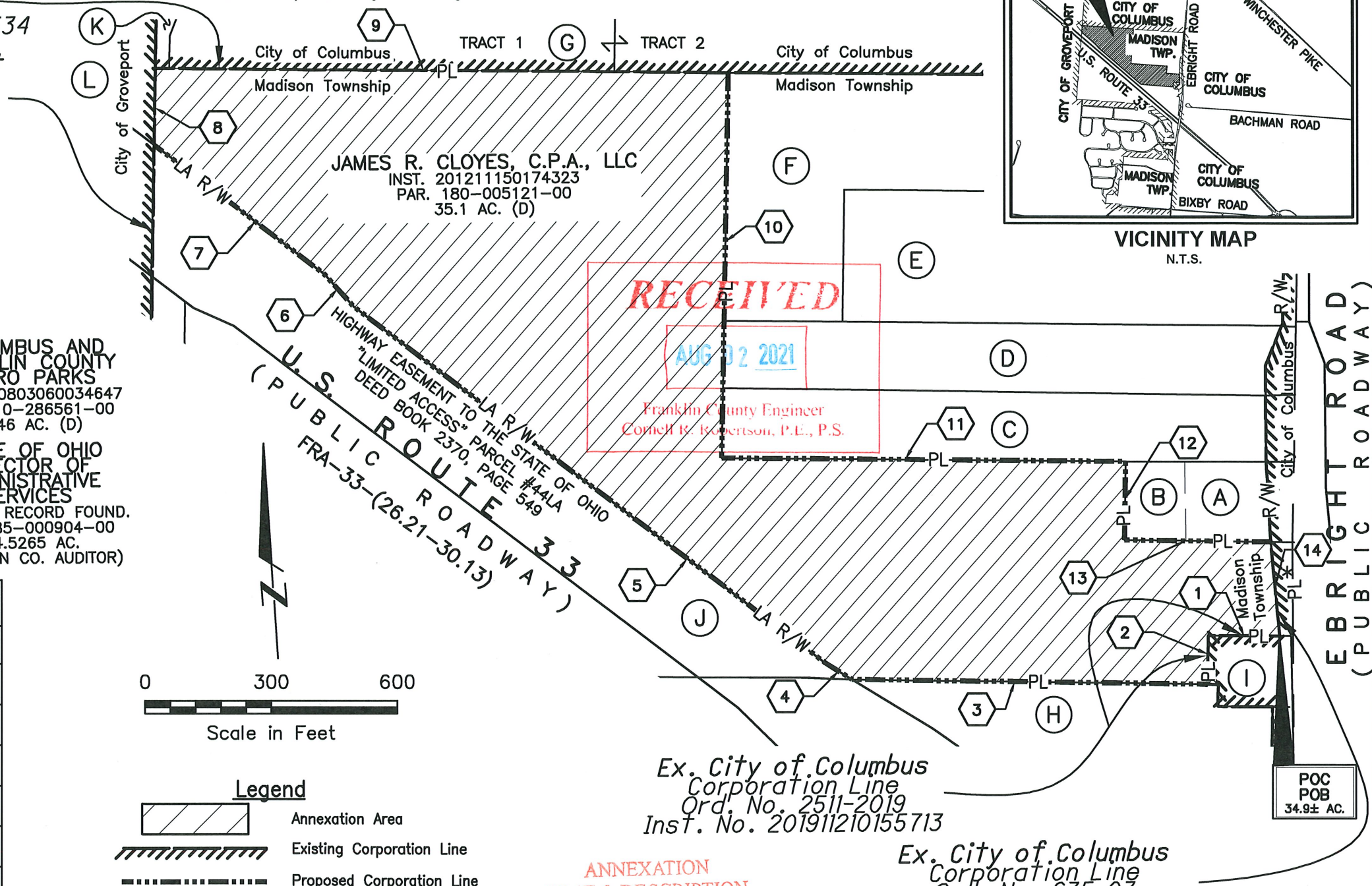

LINE TABLE					
LINE	LENGTH	BEARING	LINE	LENGTH	BEARING
1	167.6±'	N86°07'34"W	8	181.5±'	N04°39'10"E
2	115.3±'	S04°36'26"W	9	1360.3±'	S86°01'03"E
3	844.6±'	N85°42'38"W	10	911.0±'	S04°39'06"W
4	74.5±'	N54°57'02"W	11	959.2±'	S85°59'44"E
5	1400.0±'	N49°25'50"W	12	185.8±'	S04°23'05"W
6	101.8±'	N38°40'21"W	13	345.4±'	S85°44'49"E
7	507.5±'	N49°25'50"W	14	223.1±'	S01°51'48"E

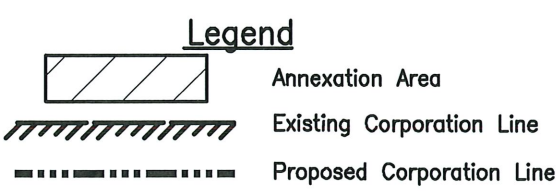
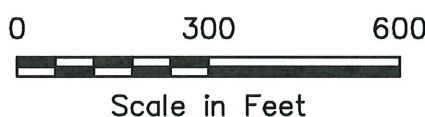

*STATE HIGHWAY EASEMENT PER
DEED BOOK 2370, PAGE 547

BASIS OF BEARINGS

The bearings shown on this plat are based on a survey of record in Instrument Number 20121150174323. The northerly property line of the proposed annexation area, having a bearing of S86°01'03"E as described in said survey, serves as the designated "basis of bearing" for this plat.

CONTIGUITY NOTE

Total Perimeter of Annexation is 7377.8 feet of which 1866.3 feet is contiguous with the City of Columbus by Ordinance Number 1351-02, 2511-2019, and 635-03, giving 25% Perimeter Contiguity.

NOTE
This annexation creates an island of unincorporated areas within the limits of the area to be annexed.

This exhibit is for Annexation purposes only and is not to be used for transfer.



ANNEXATION
PLAT & DESCRIPTION
ACCEPTABLE
CORNELL R. ROBERTSON, P.E., P.S.
FRANKLIN COUNTY ENGINEER
By: MS Date 08/03/2021

BY: Matthew Lee Sloat 8/3/21
Matthew Lee Sloat, P.E., P.S.
Registered Surveyor No. 8342

DRWN BY TKC CHK BY CK DATE 07-22-2021

E. P. FERRIS
AND
ASSOCIATES
INC.
Consulting Civil Engineers and Surveyors

880 KING AVENUE
COLUMBUS, OHIO 43212
(614) 299-2999
(614) 299-2992 (Fax)
www.EPFERRIS.com