

ANNEXATION  
PLAT & DESCRIPTION  
ACCEPTABLE  
CORNELL R. ROBERTSON, P.E., P.S.  
FRANKLIN COUNTY ENGINEER

By *CR* Date 3/8/21

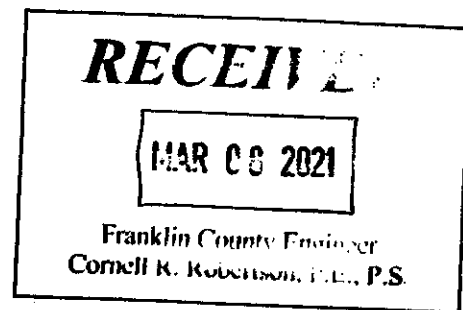

**PROPOSED ANNEXATION OF 80.847 ACRES  
FROM PRAIRIE TOWNSHIP TO CITY OF COLUMBUS  
OF HILLARD & ROME ROAD NORTH OF MANOR PARK DRIVE**

Situated in the State of Ohio, County of Franklin, Township of Prairie, being part of Survey Number 1484 of the Virginia Military Lands also being part of a 65.459 acre tract (Parcel Number 240-003105) conveyed to Roy Lee, Ruth Ann Hoffman and LJKJ Rome Hilliard LLC as recorded in Instrument Number 201212190195037, a 5.016 acre tract (Parcel Number 240-006460) conveyed to Roy L. & Carol L. Hoffman as recorded in Instrument Number 200109270222194, a 5.242 acre tract (Parcel Number 240-006461) conveyed to Hoffman LJ Enterprises LLC as recorded in Instrument Number 200107310174200, a 2.870 acre tract (Parcel Number 240-000117) conveyed to Roy L. & Carol L. Hoffman as recorded in Instrument Number 200109270222196 and part of Hillard & Rome Road as recorded in D.B. 2990, Page 249 & D.B. 2856, Page 370 & Instrument Number 199902250048366 all references being those of record in the Recorder's Office, Franklin County, Ohio, said 80.847 acre proposed annexation being more particularly bounded and described as follows:

Commencing at point in the centerline of Hilliard & Rome Road (R/W Varies) and Fisher Road (R/W Varies), thence along the centerline of said Hilliard & Rome Road (R/W Varies), southerly, approximately 630 feet to a point, being the northwesterly corner of said 65.459 acre tract, thence crossing said Hilliard & Rome Road (R/W Varies), along the northerly line of said 65.459 acre tract also being the existing City of Columbus Corporation Line Ordinance # 0242-2016 as recorded in Instrument Number 201603300038199, Easterly, approximately 30 feet to a point in the easterly right of way of said Hillard & Rome Road (R/W Varies) and the southwesterly corner of a 22.034 acre tract (Parcel Number 470-296106) conveyed to Roy Lee, Ruth Ann Hoffman and LJKJ Rome Hilliard LLC as recorded in Instrument Number 201505270069265 also being the **POINT OF BEGINNING**.

Thence leaving the easterly right of way of said Hillard & Rome Road (R/W Varies), along the northerly line of said 65.459 acre tract and the southerly line of said 22.034 acre tract also being the existing City of Columbus Corporation Line Ordinance # 0242-2016 as recorded in Instrument Number 201603300038199, **Easterly, approximately 1589 feet** to a point in the easterly line of said 65.459 acre tract;

Thence leaving the northerly line of said 65.459 acre tract and the southerly line of said 22.034 acre tract, along the easterly line of said 65.459 acre tract and the easterly line of said 2.870 acre tract also being the existing City of Columbus Corporation Line Ordinance # 743-66 as recorded in Misc. Record Volume 140, Page 450, **Southerly, approximately 2469 feet** to a point in the northerly line of a 3.054 acre tract (Parcel Number 570-106002) conveyed to Roy L. & Carol L. Hoffman as recorded in Instrument 200109270222191;

Thence leaving the easterly line of said 2.870 acre tract, along the northerly line of said 3.054 acre tract also being the existing City of Columbus Corporation Line Ordinance # 1469-69 as recorded in Misc. Record Volume 149, Page 005, **Westerly, approximately 956 feet** to a point in the easterly right of way of said Hillard & Rome Road (R/W varies);

Thence leaving the northerly line of said 3.054 acre tract and existing City of Columbus Corporation Line Ordinance # 1469-69 as recorded in Misc. Record Volume 149, Page 005, along the westerly lines of said 2.870 acre tract, said 65.459 acre tract and the easterly right of way of said Hillard & Rome Road (R/W Varies), **Northerly, approximately 299 feet** to a point;

Thence leaving said easterly right of way, and the westerly lines of said 2.870 acre tract and said 65.459 acre tract, crossing said Hillard & Rome Road (R/W Varies), **Westerly, approximately 63 feet** to a point in the westerly right of way of said Hillard & Rome Road and existing City of Columbus Corporation Line Ordinance # 775-98 as recorded in Instrument Number 199805120115788;

Thence along said westerly right of way of Hillard & Rome Road (R/W Varies) and existing City of Columbus Corporation Line Ordinance # 775-98 as recorded in Instrument Number 199805120115788 the following seven (7) courses and distances;

**Northerly, approximately 686 feet** to a point;

**Westerly, approximately 6 feet** to a point;

**Northerly, approximately 152 feet** to a point;

**Northerly, approximately 187 feet** to a point;

**Northerly, approximately 112 feet** to a point;

**Northerly, approximately 89 feet** to a point;

**Northerly, approximately 120 feet** to a point;

Thence leaving the existing City of Columbus Corporation Line Ordinance # 775-98 as recorded in Instrument Number 199805120115788, continuing along said westerly right of way of Hillard & Rome Road (R/W Varies) and the existing City of Columbus Corporation Line Ordinance # 1337-2016 as recorded in Instrument Number 201607010084924, **Northerly, approximately 177 feet** to a point;

Thence leaving said westerly right of way and said existing City of Columbus Corporation Line Ordinance # 1337-2016, crossing said Hillard & Rome Road (R/W varies) along existing City of Columbus Corporation Line Ordinance # 2530-2020 as recorded in Instrument Number 202102180031222, **Easterly, approximately 116 feet** to a point in the westerly right of way of Rome & Hilliard Road East (R/W varies);

Thence along said westerly right of way of Rome & Hilliard Road East (R/W varies) and the existing City of Columbus Corporation Line Ordinance # 2530-2020 as recorded in Instrument Number 202102180031222 the following five (5) courses and distances;

**Northerly, approximately 40 feet to a point;**

**Northerly, approximately 25 feet to a point;**

**Northerly, approximately 100 feet to a point;**

**Northerly, along the arc of curve to the right, approximately having a Length of 266 feet and a Radius of 1176 feet to a point;**

**Northerly, approximately 88 feet to a point;**

Thence leaving said westerly right of way, crossing said Rome & Hilliard Road East (R/W varies) and continuing along the existing City of Columbus Corporation Line Ordinance # 2530-2020 as recorded in Instrument Number 202102180031222, **Northerly**, along the arc of curve to the left, **approximately** having a **Length of 194 feet** and a **Radius of 789 feet** to a point in the easterly right of way of said Rome & Hilliard Road East (R/W varies);

Thence continuing along said easterly right of way and the existing City of Columbus Corporation Line Ordinance # 2530-2020, **Northerly, approximately 59 feet** to the **POINT OF BEGINNING** containing **80.847 acres** more or less according to survey made by Hull & Associates in December of 2020.

Summary Statement of Contiguity

Total Length of Perimeter:	7806
Total Length of Contiguity:	7444
Percentage of Contiguity:	95%

The Above description was prepared in the Office of Hull & Associates LLC. (59 Grant Street, Newark Ohio 43055) by Jeremy L. Van Ostran P.S. in December of 2020, from the best available County Records. This information was not derived from an actual field survey. The above description is not valid of the transfer of real property and, is not to be utilized in place of a Boundary Survey as defined by the Ohio Administrative Code in Chapter 4733-37.

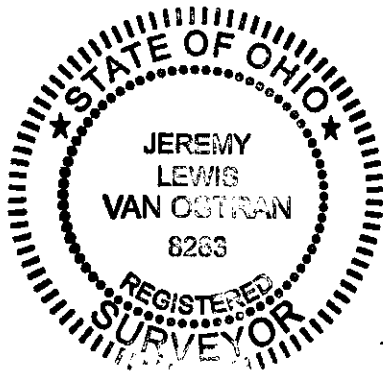

March 1, 2021

F:\Clients\Active\TGP\TGP005\survey\legals

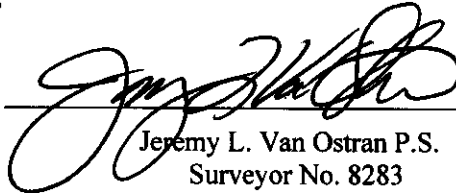
  
Jeremy L. Van Ostran P.S.  
Surveyor No. 8283