

ANNEXATION OF 25± ACRES AND 30± ACRES TO THE CITY OF COLUMBUS FROM BLENDON TOWNSHIP, FRANKLIN COUNTY, OHIO

STATE OF OHIO, COUNTY OF FRANKLIN, TOWNSHIP OF BLENDON,
SECTION 1, TOWNSHIP 2, RANGE 17, UNITED STATES MILITARY LANDS

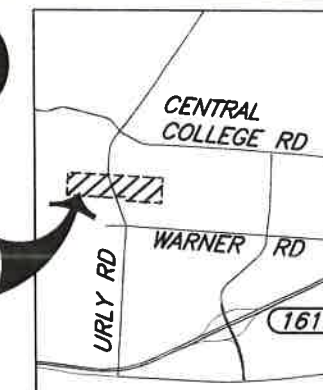

SITE

CONTIGUITY CALCULATION

AREA 1:
815 LINEAL FEET OF PERIMETER IS CONTIGUOUS WITH THE EX. CORPORATION LINE OF THE CITY OF COLUMBUS. A TOTAL OF 4,469 LINEAL FEET OF ANNEXED PERIMETER. 18.2% OF THE PERIMETER OF THE ANNEXED AREA IS CONTIGUOUS TO THE EX. CITY OF COLUMBUS CORPORATION LINE. NO ISLANDS ARE CREATED BY THIS ANNEXATION.

AREA 2:
4,561 LINEAL FEET OF PERIMETER IS CONTIGUOUS WITH THE EX. CORPORATION LINE OF THE CITY OF COLUMBUS. A TOTAL OF 5,014 LINEAL FEET OF ANNEXED PERIMETER. 90.9% OF THE PERIMETER OF THE ANNEXED AREA IS CONTIGUOUS TO THE EX. CITY OF COLUMBUS CORPORATION LINE. NO ISLANDS ARE CREATED BY THIS ANNEXATION.

PROPERTY TO BE ANNEXED

P.I.D.: 110-000023-00
55± ACRES
MCCORKLE SOARING EAGLES, LLC
IN. 200504220075702

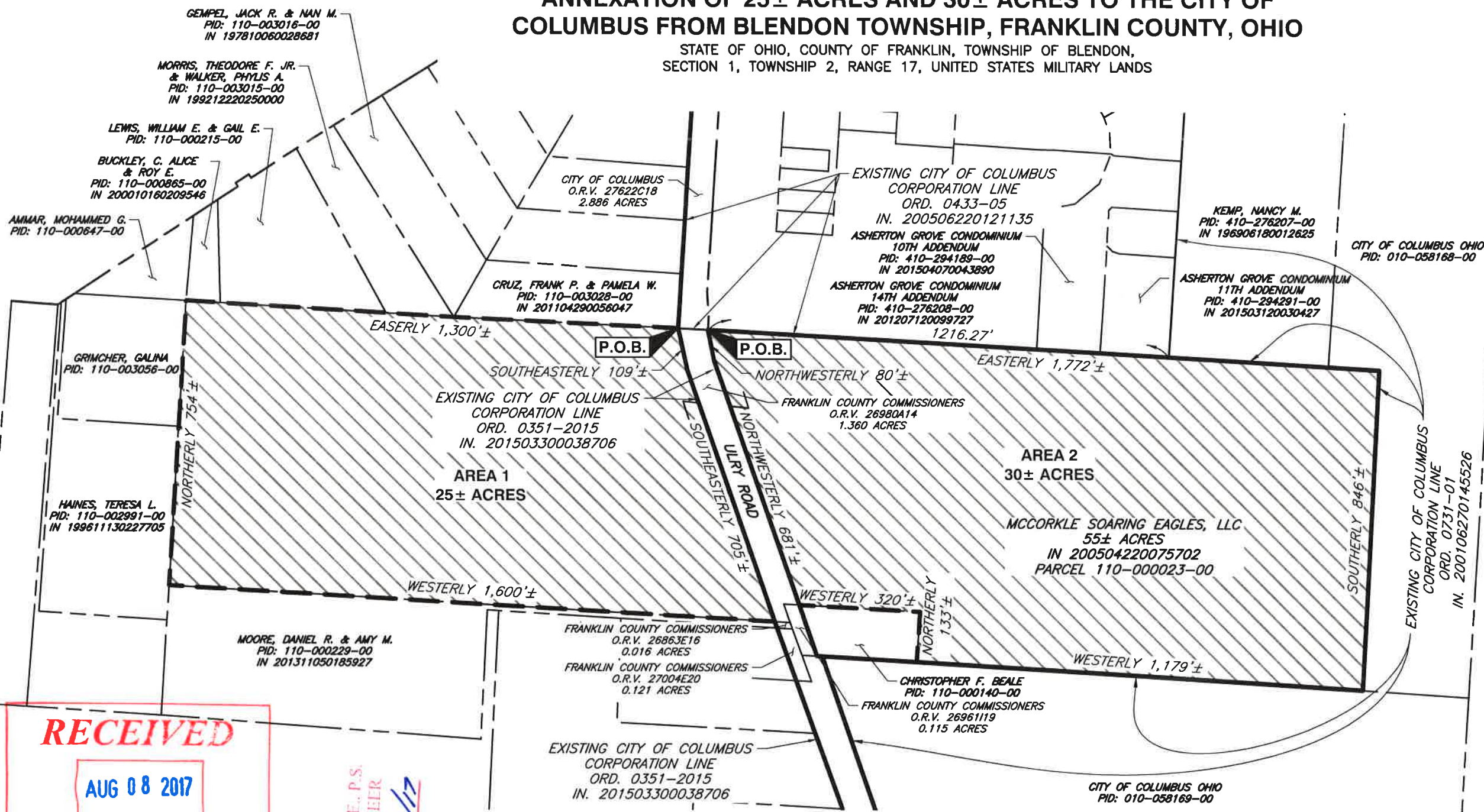

P:\2016\160-925-Survey\Draw\160925-SV01-ANNEXATION.dwg[ANNEX] LS:(8/8/2017 - abenson) - LP: 8/8/2017 1:01 PM

RECEIVED

AUG 08 2017

Franklin County Engineer
Cornell R. Robertson, P.E., P.S.

ANNEXATION
PLAT & DESCRIPTION
ACCEPTABLE
CORNELL R. ROBERTSON, P.E., P.S.
FRANKLIN COUNTY ENGINEER
By: *CR* Date: *8/8/17*



SCALE IN FEET

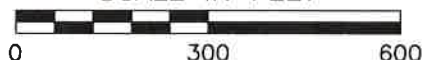

LEGEND

- EXISTING CORPORATION LINE
- PROPOSED CORPORATION LINE
- AREA TO BE ANNEXED FROM BLENDON TOWNSHIP TO THE CITY OF COLUMBUS

THIS ANNEXATION PLAT IS A GENERAL DESCRIPTION OF THE LOCATION OF PROPERTY TO BE ANNEXED AND IS NOT A BOUNDARY SURVEY AS DEFINED IN THE O.A.C. CHAPTER 4733-37.

JEFFREY A. MILLER, P.S.
PROFESSIONAL SURVEYOR 7211

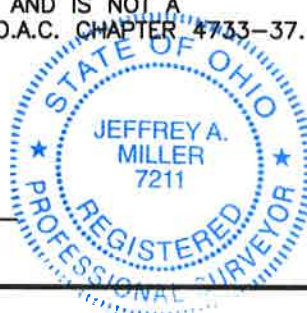

Civil & Environmental Consultants, Inc.

250 Old West Wilson Bridge Road, Ste 250 · Worthington, Ohio 43085
614-540-6633 · 888-598-6808
www.cecinc.com

DRAWN BY: DJR CHECKED BY: MAS
DATE: AUGUST 2017 DWG SCALE: 1"=300'

ANNEXATION OF 55± ACRES
URLY ROAD
BLENDON TOWNSHIP, OHIO

ANNEXATION PLAT

APPROVED BY: JAM DRAWING NO.:
PROJECT NO: 160-925 **1 OF 1**