

MAP ANNEXATION AN03-033 18.004 Acres in Hamilton Township Columbus Regional Airport Authority

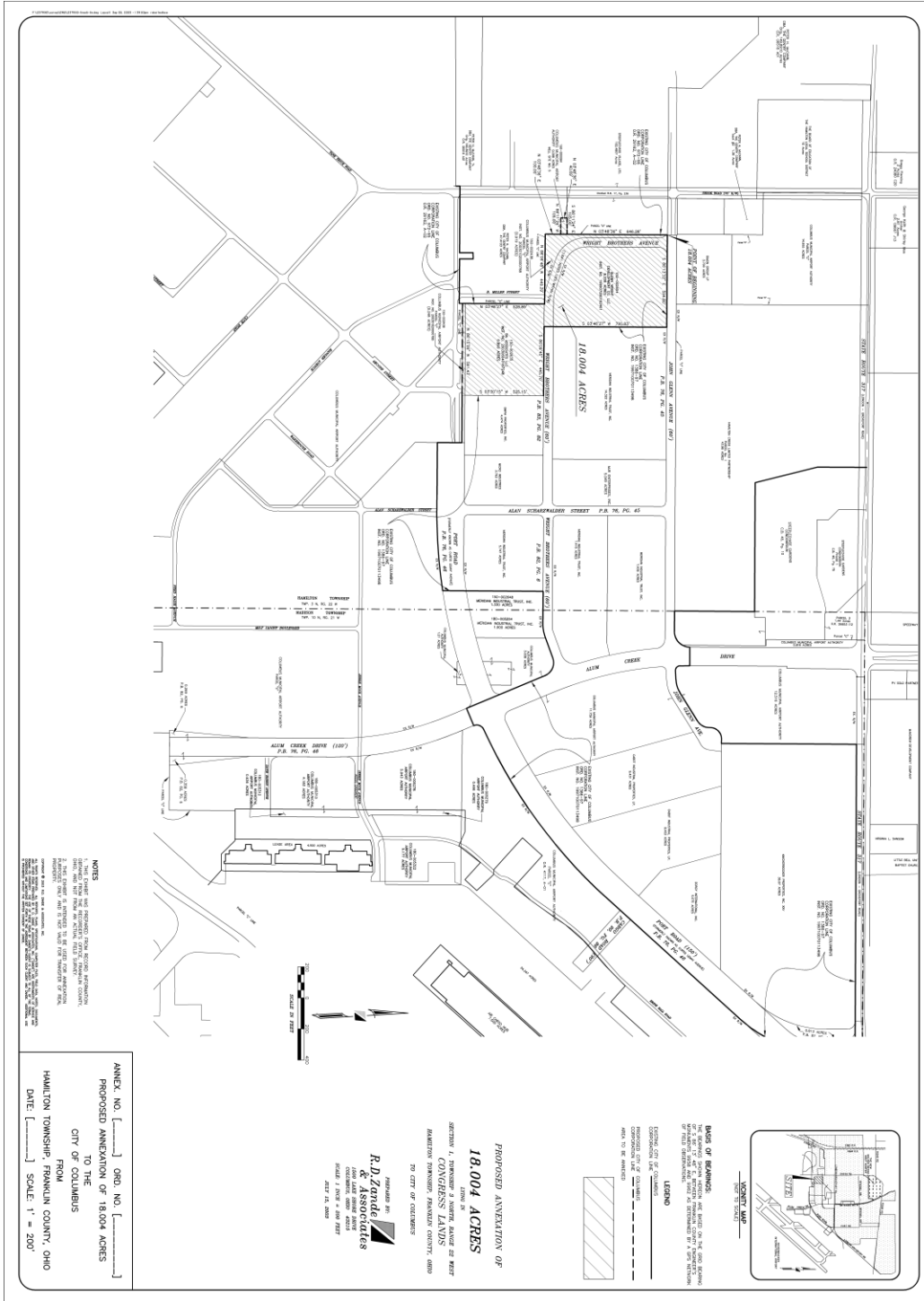

NOTES

1. THE CITY OF COLUMBUS HAS REVIEWED THIS MAP AND APPROVES THE ANNEXATION OF THE LANDS SHOWN HEREON TO THE CITY OF COLUMBUS.
2. THE CITY OF COLUMBUS HAS REVIEWED THE MAP AND APPROVES THE ANNEXATION OF THE LANDS SHOWN HEREON TO THE CITY OF COLUMBUS.
3. THE CITY OF COLUMBUS HAS REVIEWED THE MAP AND APPROVES THE ANNEXATION OF THE LANDS SHOWN HEREON TO THE CITY OF COLUMBUS.

ANNEX. NO. [] ORD. NO. []
 PROPOSED ANNEXATION OF 18.004 ACRES
 TO THE
 CITY OF COLUMBUS
 FROM
 HAMILTON TOWNSHIP, FRANKLIN COUNTY, OHIO
 DATE: [] SCALE: 1" = 200'

**PROPOSED ANNEXATION OF
18.004 ACRES**

SECTION 1, TOWNSHIP 2 NORTH, RANGE 22 WEST,
 CONGRESS LANDS
 HAMILTON TOWNSHIP, FRANKLIN COUNTY, OHIO
 TO CITY OF COLUMBUS

APPROVED BY
R.D. ZWITZ
 COUNTY ENGINEER
 FRANKLIN COUNTY, OHIO
 EXPIRES 3 MONTHS FROM DATE
 JUNE 1, 2008

BASIS OF MEASUREMENTS:
 THE SURVEY WAS MADE BY THE CITY ENGINEER OF COLUMBUS, OHIO, AND THE DISTANCES WERE MEASURED BY THE CITY ENGINEER OF COLUMBUS, OHIO, AND THE DISTANCES WERE MEASURED BY THE CITY ENGINEER OF COLUMBUS, OHIO.

LEGEND

PROPOSED CITY OF COLUMBUS
 CONGRESSIONAL LAND
 CITY OF COLUMBUS
 CITY OF COLUMBUS

