

DEVELOPMENT STATS:

Total Site: 73.8 Acres
 Neighborhood Center: 139
 Neighborhood General: 173
 Neighborhood Edge: 64
 Total Lots: 572 Dwelling Units
 Total Area: 10.4 Acres
 Green Space:

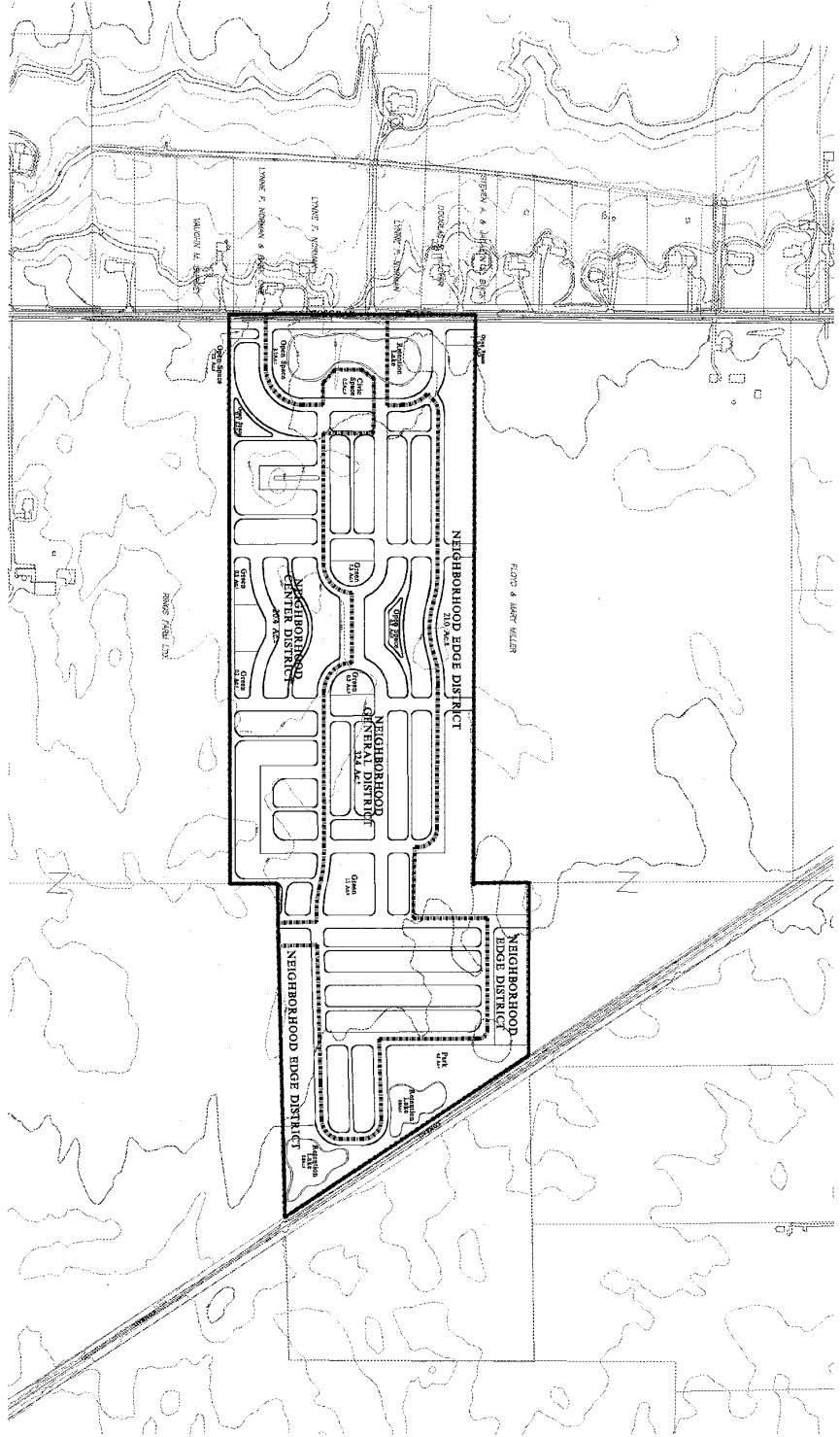

HAYDEN CROSSING - Zoning District Plan

Z02-097
 Final Copy
 Don Bley
 June 21, 2004

June 8, 2005 [Signature]

Development Plan for:
HAYDEN CROSSING
 City of Columbus
ZONING DISTRICT PLAN

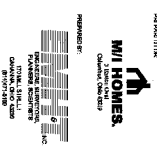
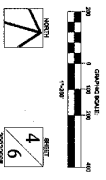

DATE:	06/21/04
BY:	DAVID L. BRYAN
FOR:	M/I HOMES
PROJECT:	HAYDEN CROSSING
LOCATION:	10.4 ACRES
SCALE:	1" = 100'
DATE:	06/21/04
BY:	DAVID L. BRYAN
FOR:	M/I HOMES
PROJECT:	HAYDEN CROSSING
LOCATION:	10.4 ACRES
SCALE:	1" = 100'