

RECEIVED

MAR 05 2021

Franklin County Engineer
Cornell R. Robertson, P.E., P.S.

ANNEXATION
PLAT & DESCRIPTION
ACCEPTABLE

CORNELL R. ROBERTSON, P.E., P.S.
FRANKLIN COUNTY ENGINEER

By FAR/ATS Date 05 Mar 21

**PROPOSED MUNICIPAL CORPORATION BOUNDARY ADJUSTMENT
0.8± ACRE**

FROM: CITY OF WORTHINGTON

TO: CITY OF COLUMBUS

Situated in the State of Ohio, County of Franklin, City of Worthington, in Quarter Township 2, Township 2, Range 18, United States Military Lands, being comprised of the existing right-of-way of McCampbell Road and a portion of McCampbell Road dedicated in the subdivision plat entitled Commercial Pointe-Worthington of record in Plat book 62, Page 71, said McCampbell Road now known as Sancus Boulevard (all references are to the records of the Recorder's Office, Franklin County, Ohio) and more particularly bounded and described as follows:

BEGINNING, at the northwesterly corner of that right-of-way dedicated as Sancus Boulevard (formerly McCampbell Road) and the northeasterly corner of Lot 8, both designated and delineated on said Commercial Pointe-Worthington, being in the southerly line of that 9.306 acre tract conveyed to Avistone Dearbone H., LLC and Avistone Dearbone S., LLC by deed of record in Instrument Number 201607080087664;

Thence easterly, with the northerly line of said Commercial Pointe-Worthington, with the existing City of Worthington corporation line established in Ordinance 102-60 and of record in Miscellaneous Volume 127, Page 449 and the existing City of Columbus corporation line established in Ordinance 1606-72 and of record in Miscellaneous Volume 139, Page 323, across said Sancus Boulevard, a distance of 40± feet, to a point in the centerline of said Sancus Boulevard (formerly the easterly line of McCampbell Road), being the westerly line of that 0.177 acre tract conveyed to City of Columbus by deed of record in Deed book 3538, Page 289, the line between said Quarter Township 2 and Quarter Township 1 of said Township 2, Range 18, also being the existing City of Columbus corporation line as established in Ordinance Number 1606-72 and recorded in Miscellaneous Volume 158, Page 63;

Thence southerly, with the centerline of said Sancus Boulevard, said Quarter Township line, with said existing City of Worthington corporation line, said existing City of Columbus corporation line, that existing City of Columbus corporation line as established in Ordinance 1019-72 of record in Miscellaneous Volume 156, Page 449, the existing City of Worthington corporation line established in Ordinance 12-67 and of record in Miscellaneous Volume 142, Page 579, the westerly line of said 0.177 acre tract, and the westerly line of those 0.191 and 0.179 acre tracts conveyed to City of Columbus, Ohio by deed or record in Official Record 17285E05, a distance of 826± feet to a point;

Thence Westerly, across said right-of-way, a distance of 40± feet to a point on the westerly right-of-way of said Sancus Boulevard, the easterly line of Lot 8 of said Commercial Pointe-Worthington;

Thence northerly, with said westerly right-of-way line, a distance of 826'± feet to POINT OF BEGINNING, containing 0.8± acre of land, more or less.

This description is for annexation purposes only and is not to be used for transfer.

EVANS, MECHWART, HAMBLETON & TILTON, INC.

[Handwritten Signature]
Edward J. Miller
Professional Surveyor No. 8250

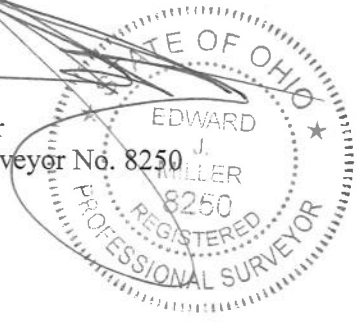

3/4/2021

Date