

# 0.972 ACRE PROPOSED ANNEXATION FROM PRAIRIE TOWNSHIP TO THE CITY OF COLUMBUS.

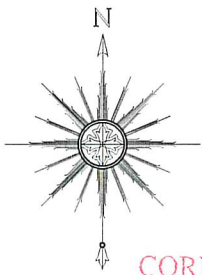

ANNEXATION  
PLAT & DESCRIPTION  
ACCEPTABLE

CORNELL R. ROBERTSON, P.E., P.S.  
FRANKLIN COUNTY ENGINEER

By *YH* Date 10/22/2019

LEGEND:

EXISTING COLUMBUS CORP. LINE:

PARCEL LINE:

AREA TO BE ANNEXED:

SCALE: 1" = 100'

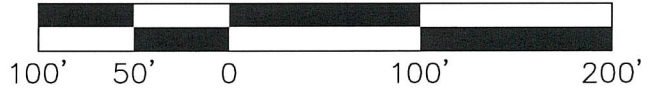

FEDER ROAD

FISHER ROAD

I-70 & ROME HILLIARD  
DUCHESS, LLC.  
PARCEL # 010-234593-00  
INSTRUMENT #  
201603040026287  
0.980 ACRES

EXISTING COLUMBUS  
CORPORATION LINE  
CASE #49-95  
ORDINANCE #39-95  
OFFICIAL RECORD  
31700 C03

POINT OF  
BEGINNING

EXISTING COLUMBUS  
CORPORATION LINE  
CASE #47-97  
ORDINANCE #775-98  
INSTRUMENT #  
199805120115788  
1.629 ACRES

HILLIARD ROME ROAD

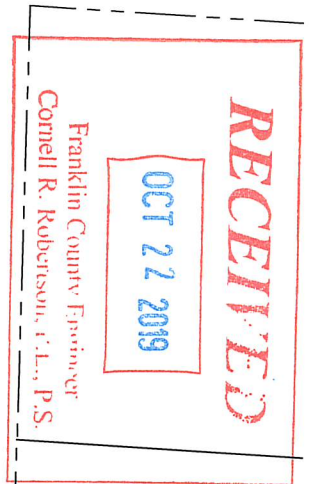

ZEEBOT LLC.  
PARCEL # 240-000003  
INSTRUMENT #  
201812210172415  
0.972 ACRES

197'  
194'  
109'  
16'

EXISTING COLUMBUS  
CORPORATION LINE  
CASE #76-95  
ORDINANCE # 991-96  
OFFICIAL RECORD  
32248 B10

IMAGE HOSPITALITY, LLC.  
PARCEL # 010-249539  
INSTRUMENT #  
201010010129017  
1.629 ACRES

SUMMARY STATEMENT  
OF CONTIGUITY:

TOTAL LENGTH OF  
PERIMETER: 838'  
TOTAL LENGTH OF  
CONTIGUITY: 838'  
PERCENTAGE OF  
CONTIGUITY: 100%

EXISTING COLUMBUS  
CORPORATION LINE  
CASE #01-16  
ORDINANCE #337-2016  
INSTRUMENT #  
201607010084924

MENARD, INC.  
PARCEL # 470-296199  
INSTRUMENT #  
201712130175358  
6.510 ACRES

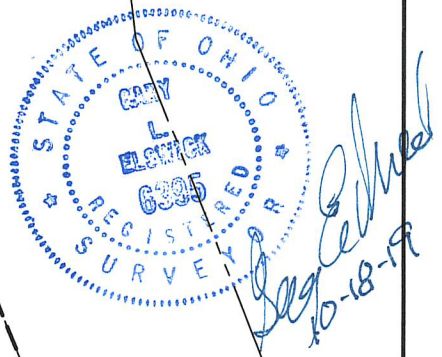

PROPOSED ANNEXATION OF 0.972 ACRES TO THE  
CITY OF COLUMBUS  
FROM VIRGINIA MILITARY SURVEY 7326,  
PRAIRIE TOWNSHIP, FRANKLIN COUNTY, OHIO  
7/15/19  
PREPARED BY: GARY L. ELSWICK, P.S. 6395  
RW SURVEY, LLC