

ANNEXATION AN15-012
+ 1.7 Acres / Mifflin Township
Gebeyehu Mamay
(1776 and 1882 Stelzer Rd)

PROPOSED ANNEXATION OF 1.7± ACRES
TO THE CITY OF COLUMBUS FROM THE TOWNSHIP OF MIFFLIN
QUARTER TOWNSHIP 4, TOWNSHIP 1, RANGE 17
UNITED STATES MILITARY LANDS
TOWNSHIP OF MIFFLIN, COUNTY OF FRANKLIN, STATE OF OHIO

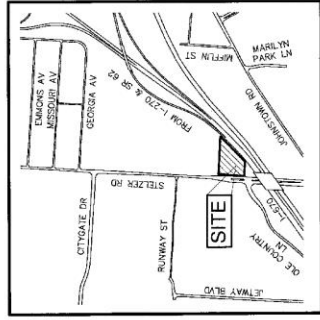

LOCATION MAP AND BACKGROUND DRAWING
 Not To Scale

ANNEXATION
 PLAT & DESCRIPTION
 ACCEPTABLE
 DEAN ACCREDITED P.E.
 FRANKLIN COUNTY ENGINEER
 BY: *[Signature]* Date: 4/24/15

EMHT	Date: December 8, 2014
Earth, Michael, Holladay & Brown, Inc. 200 West Albany Road, Columbus, Ohio 43204 Phone: 614/778-2222 www.emht.com	Scale: 1" = 30'
Job No: 2014-1939	Sheet: 1 of 1
REVISIONS	
NO. DATE DESCRIPTION	
1-1 4/22/15 Revised to reference ROW transfer, adjust per LA R/W error	

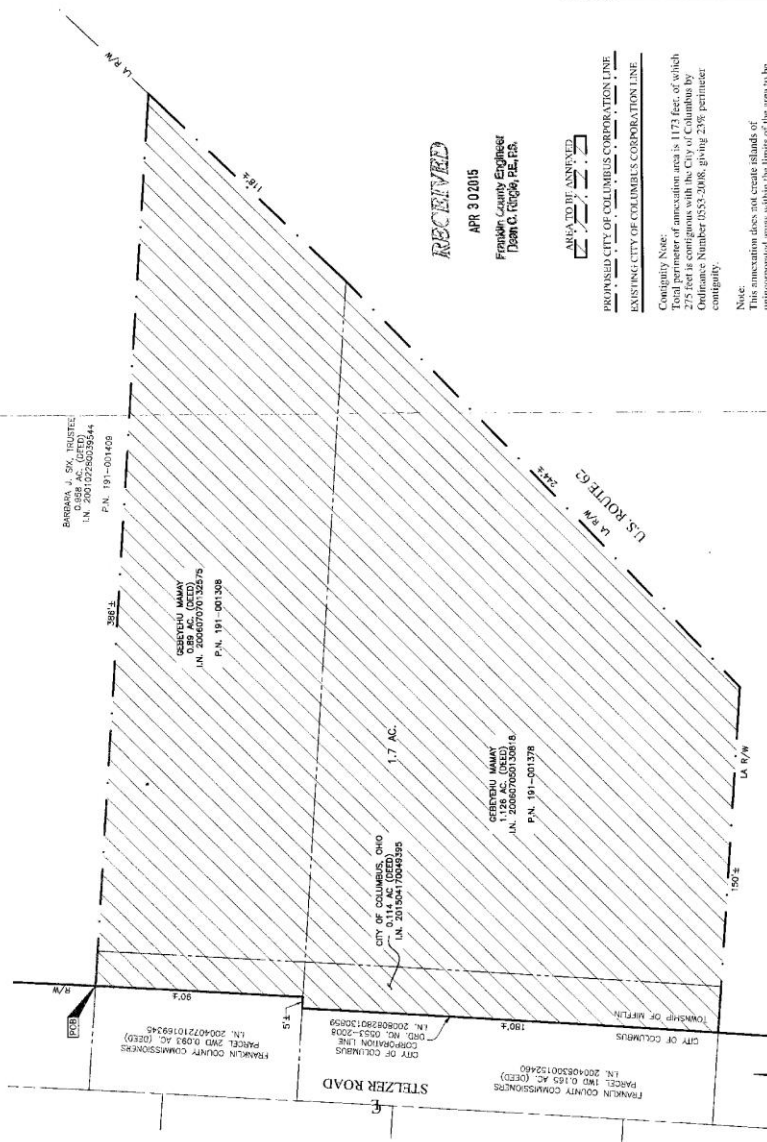

RECEIVED
 APR 30 2015
 Franklin County Engineer
 DARRYL K. PETERSON

APPROVED BY
[Signature]
 DEAN ACCREDITED P.E.
 FRANKLIN COUNTY ENGINEER

PROXIMITY TO CITY OF COLUMBUS CORPORATION LINE
 EXISTING CITY OF COLUMBUS CORPORATION LINE
 Contiguity Note:
 Total perimeter of annexation area is 1173 feet, of which
 1173 feet is contiguous to the City of Columbus
 Ordinance Number 0583-2008, giving 24% perimeter
 contiguity.
 Note:
 This annexation does not create islands of
 unincorporated land within the limits of the area to be
 annexed.



By: *[Signature]*
 Darryl K. Peterson
 Professional Surveyor No. 8307
 Date: 4/24/15

