

# ANNEXATION PLAT OF 1.463 ACRES FROM MADISON TOWNSHIP TO THE CITY OF COLUMBUS

STATE OF OHIO, COUNTY OF FRANKLIN, TOWNSHIP OF MADISON,  
NORTHWEST QUARTER OF SECTION 15, TOWNSHIP 11, RANGE 21,  
CONGRESS LANDS EAST OF THE SCIOTO RIVER

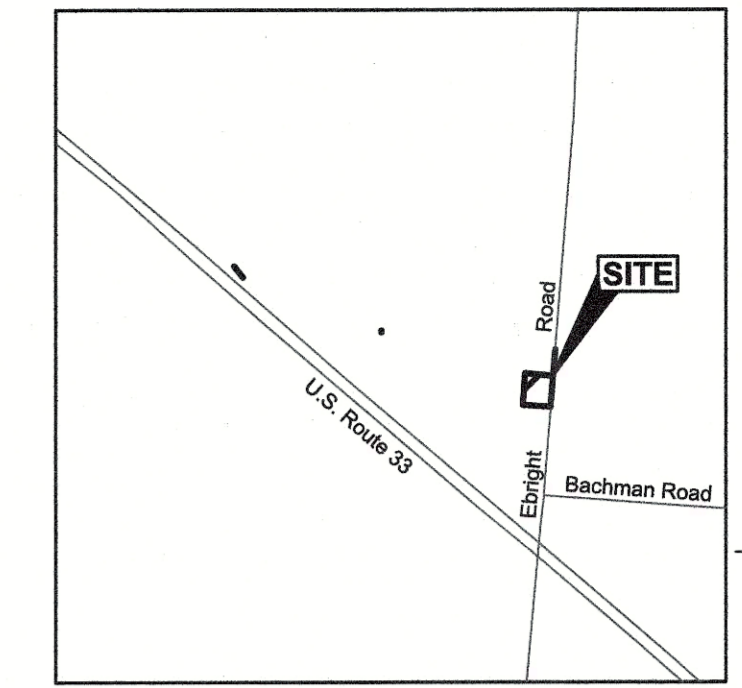

PREPARED FOR:  
**JBM DEVELOPMENT, LLC**

**AMERICAN STRUCTUREPOINT INC.**  
2550 Corporate Exchange Dr., Ste. 300 | Columbus, Ohio 43231  
TEL 614.901.2235 | FAX 614.901.2236  
www.structurepoint.com

ANNEXATION PLAT  
FOR  
**JBM - EBRIGHT ROAD**  
CITY OF COLUMBUS, FRANKLIN COUNTY, OHIO

REVISIONS	DATE	SHEET NO.	DESCRIPTION	APPROVED	DATE

DATE:	7/10/2023
DRAWN BY:	DGL
CHECKED BY:	MJW
JOB NUMBER:	2022.00164

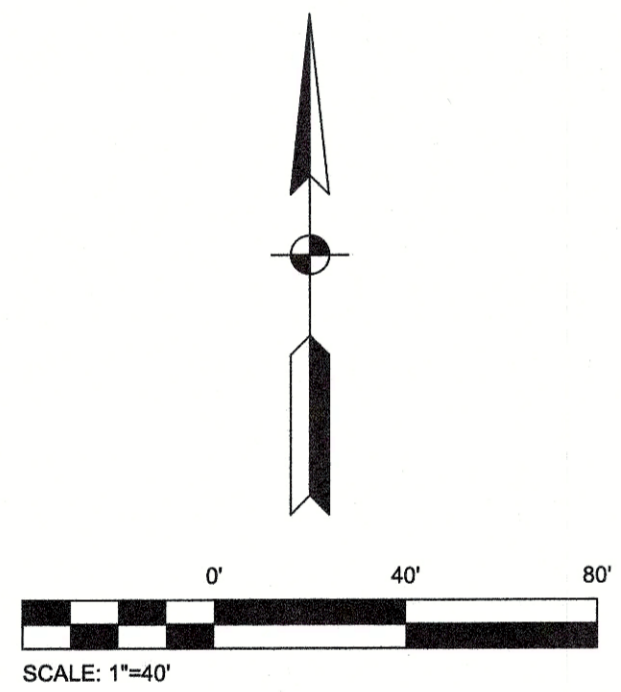

**CONTIGUITY DETAILS**

- Total Perimeter of Annexation: 1056.33'
- Length of Contiguous Existing Corporation Line: 719.82' (68% of Total Perimeter)

**LEGEND**

- Existing Corporation Line
- Proposed Corporation Line
- Proposed Annexation Area

ANNEXATION  
PLAT & DESCRIPTION  
ACCEPTABLE  
CORNELL R. ROBERTSON, P.E., P.S.  
FRANKLIN COUNTY ENGINEER  
By: CR Date: 07/11/2023

RECEIVED

JUL 11 2023

Franklin County Engineer  
Cornell R. Robertson, P.E., P.S.



This annexation plat was prepared based on an actual field survey of the premises performed by American Structurepoint, Inc. in July 2022, and is true and correct to the best of my knowledge and belief.

Michael J. Ward      Date: 7/10/23

Michael J. Ward  
Professional Land Surveyor 8808

**BASIS OF BEARINGS**

Bearings described hereon are based on North 49 degrees 26 minutes 29 seconds West for the centerline of right-of-way for U.S. Route 23, as measured from Grid North, referenced to the Ohio State Plan Coordinate System (South Zone) and the North American Datum of 1983 (2011 Adjustment), as established utilizing a GPS survey and a NGS OPUS solution.

PLOT SCALE: 1"=40' DATE: 7/10/23 11:29 AM EDITED BY: JYUMANS DRAWING FILE: C:\2022\00164\0 DRAWINGS\SURVEY\202200164.SV.2023-06-09 1.463 ACRE ANNEX.PLAT.DWG