

**ANNEXATION AN15-012**  
**+ 1.7 Acres / Mifflin Township**  
**Gebeyehu Mamay**  
**(1776 and 1882 Stelzer Rd)**

**PROPOSED ANNEXATION OF 1.7± ACRES**  
**TO THE CITY OF COLUMBUS FROM THE TOWNSHIP OF MIFFLIN**  
**QUARTER TOWNSHIP 4, TOWNSHIP 1, RANGE 17**  
**UNITED STATES MILITARY LANDS**  
**TOWNSHIP OF MIFFLIN, COUNTY OF FRANKLIN, STATE OF OHIO**

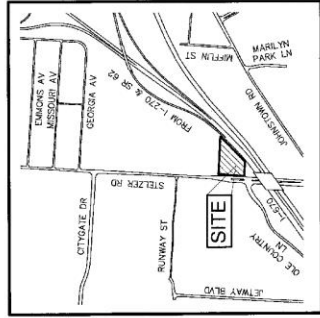

LOCATION MAP AND BACKGROUND DRAWING  
 Not To Scale

ANNEXATION  
 PLAT & DESCRIPTION  
 ACCEPTABLE  
 DEAN ACCREDITED P.E.  
 FRANKLIN COUNTY ENGINEER  
 BY: *[Signature]* Date: 4/23/15

<b>EMHT</b> Everts, MacFay, Hornsblom & Brown, Inc. 200 West Albany Street, Columbus, Ohio 43204 Phone: 614/778-2222 www.emht.com	Date: December 8, 2014 Scale: 1" = 30' Job No: 2014-1939 Sheet: 1 of 1
REVISIONS	
NO. DATE DESCRIPTION	
1. 4/22/15	Revised to reference ROW transfer, substitute per LA R/W, correct

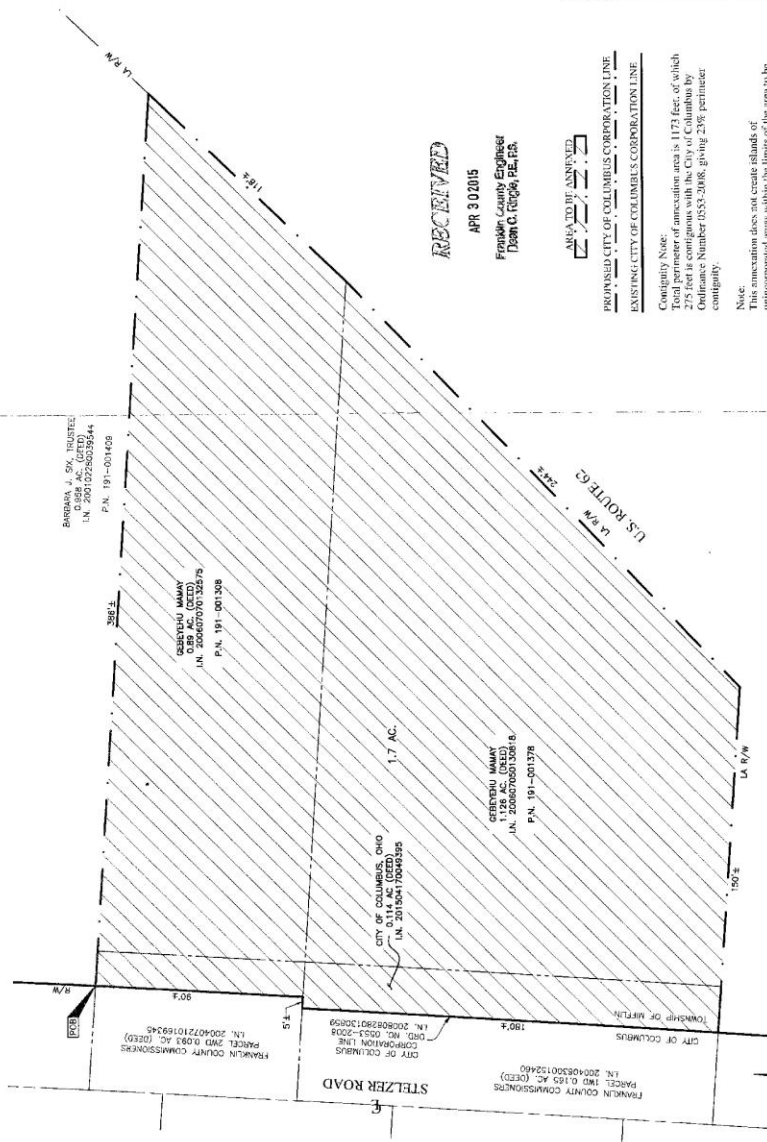

**RECEIVED**  
 APR 30 2015  
 Franklin County Engineer  
 DARRYL C. YOUNG, P.E., P.S.

AREA TO BE ANNEXED  
 1.7± AC

PROVISED CITY OF COLUMBUS CORPORATION LINE  
 EXISTING CITY OF COLUMBUS CORPORATION LINE

Contiguity Note:  
 Total perimeter of annexation area is 1173 feet, of which  
 1000 feet is contiguous to the City of Columbus.  
 Contiguity Number US53-2048, giving 24% perimeter  
 contiguity.

Note:  
 This annexation does not create islands of  
 unincorporated land within the limits of the area to be  
 annexed.



By: *[Signature]* Date: 4/23/15  
 Heather L. King  
 Professional Surveyor No. 8307

