

# CEDAR RUN SECTION 4 PART 3

Situated in the State of Ohio, County of Franklin, City of Columbus and in Quarter Township 4, Township 1, Range 16, United States Military Lands, containing 11.146 acres of land more or less, said 11.146 acres being all of that tract of land conveyed to M/I HOMES OF CENTRAL OHIO, LLC by deed of record in Instrument Number 201609080120607, Recorder's Office, Franklin County, Ohio

The undersigned, M/I HOMES OF CENTRAL OHIO, LLC, an Ohio limited liability company, by TIMOTHY C. HALL, JR., Area President, owner of the land platted herein, duly authorized in the premises, does hereby certify that this plat correctly represents its "CEDAR RUN SECTION 4 PART 3", a subdivision containing Lots numbered 423 to 434, Lots numbered 468 to 507, all inclusive, and an area designated as Reserve "I", does hereby accept this plat of same and dedicates to public use, as such, all of the Drives shown hereon and not heretofore dedicated.

Easements are hereby reserved in, over and under areas designated on this plat as "Easement". Each of the aforementioned designated easements permit the construction, operation and maintenance of all public and quasi public utilities, above, beneath and on the surface of the ground, and where necessary, for the construction, operation and maintenance of service connections to all adjacent lots and lands and for storm water drainage. Easement areas shown hereon outside of the platted area are within lands owned by the undersigned and easements are hereby reserved therein for the uses and purposes as expressed herein.

In Witness Whereof, TIMOTHY C. HALL, JR., Area President of M/I HOMES OF CENTRAL OHIO, LLC, has hereunto set his hand this 15 day of Sep, 2016.

Signed and Acknowledged  
In the presence of:

M/I HOMES OF CENTRAL  
OHIO, LLC

*Darlene W. Smith*

By *[Signature]*  
TIMOTHY C. HALL, JR.,  
Area President

*Ja [Signature]*

STATE OF OHIO  
COUNTY OF FRANKLIN ss:

Before me, a Notary Public in and for said State, personally appeared TIMOTHY C. HALL, JR., Area President of said M/I HOMES OF CENTRAL OHIO, LLC, who acknowledged the signing of the foregoing instrument to be his voluntary act and deed and the voluntary act and deed of said M/I HOMES OF CENTRAL OHIO, LLC for the uses and purposes expressed herein.

In Witness Thereof, I have hereunto set my hand and affixed my official seal this 15 day of September, 2016.

My commission expires 6/29/19

*Darlene W. Smith*  
Notary Public, State of Ohio

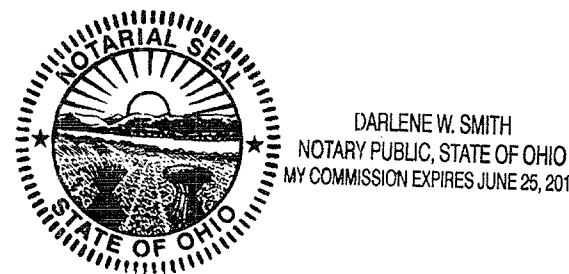

Approved this 28<sup>th</sup> day of September 2016.

*Scott J. Mason / ASB*  
Director, Department of Building  
and Zoning Services, Columbus, Ohio

Approved this 28<sup>th</sup> day of September 2016.

*James Young / ssu*  
City Engineer/Administrator, Division of  
Design and Construction, Columbus, Ohio

Approved this 29<sup>th</sup> day of September 2016.

*[Signature]*  
Director, Department of Public Service,  
Columbus, Ohio

Approved and accepted this \_\_\_\_\_ day of \_\_\_\_\_, 20\_\_\_\_, by Ordinance No. \_\_\_\_\_ wherein all of the Drives shown dedicated hereon are accepted as such by the Council for the City of Columbus, Ohio.

In witness thereof, I have hereunto set my hand and affixed my seal the \_\_\_\_\_ day of \_\_\_\_\_ 20\_\_\_\_.

City Clerk, Columbus, Ohio

Transferred this \_\_\_\_\_ day of \_\_\_\_\_, 20\_\_\_\_.

Auditor, Franklin County, Ohio

Deputy Auditor, Franklin County, Ohio

Filed for record this \_\_\_\_\_ day of \_\_\_\_\_, 20\_\_\_\_ at \_\_\_\_\_ M. Fee \$ \_\_\_\_\_

Recorder, Franklin County, Ohio

File No. \_\_\_\_\_

Recorded this \_\_\_\_\_ day of \_\_\_\_\_, 20\_\_\_\_.

Deputy Recorder, Franklin County, Ohio

Plat Book \_\_\_\_\_, Pages \_\_\_\_\_

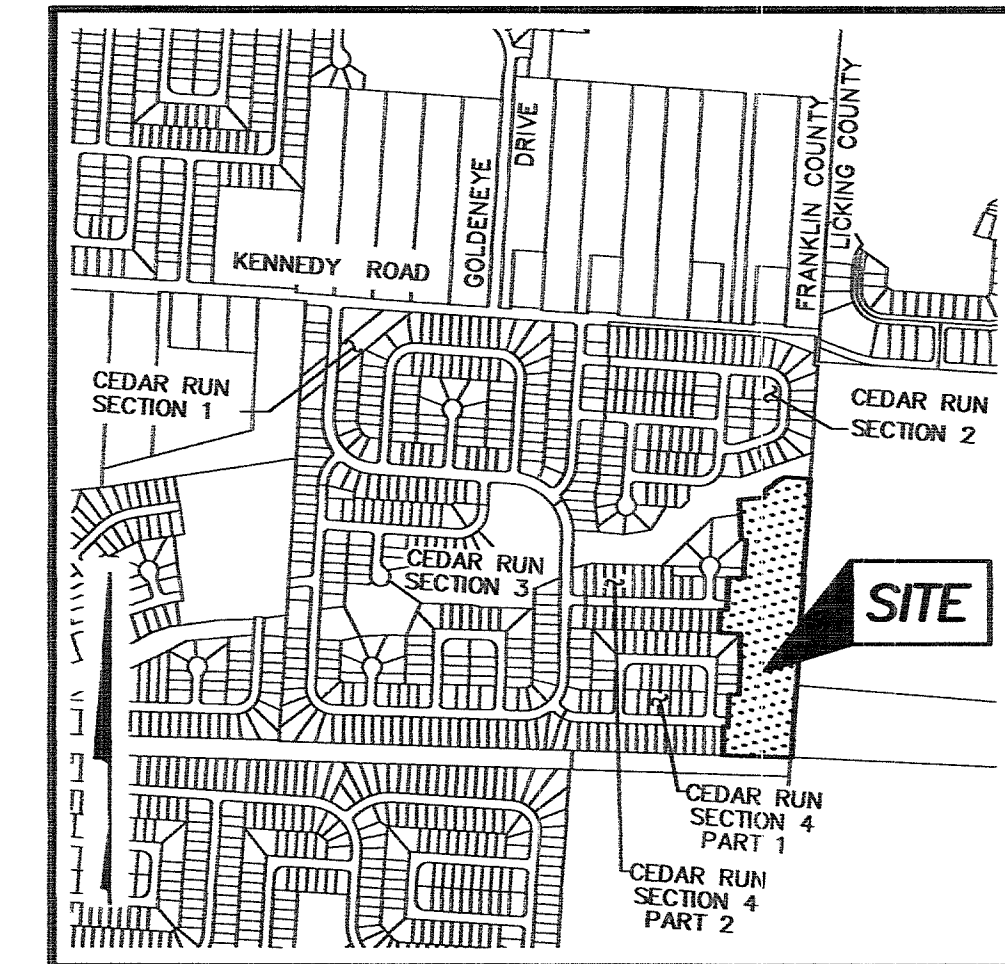

LOCATION MAP AND BACKGROUND DRAWING

NOT TO SCALE

**SURVEY DATA:**

**BASIS OF BEARINGS:** The bearings shown on this plat were transferred from a field traverse originating from and tying to Franklin County Survey Control Monuments, including F.C.G.S. 1515 and F.C.G.S. 1572 and are based on the Ohio State Plane Coordinate System, South Zone as per NAD 83, 1986 adjustment, having a calculated bearing of South 86°06'15" East between said monuments.

**SOURCE OF DATA:** The sources of recorded survey data referenced in the plan and text of this plat, are the records of the Recorder's Office, Franklin County and Licking County, Ohio.

**IRON PINS:** Iron pins, where indicated hereon, unless otherwise noted, are to be set and are iron pipes thirteen sixteenths inch inside diameter, thirty inches long with a plastic plug placed in the top end bearing the initials EMHT INC.

**PERMANENT MARKERS:** Permanent markers, where indicated hereon in the public street centerline, are to be one-inch diameter, thirty-inch long, solid iron pins. Pins are to be set to monument the points indicated, are to be set after the construction/installation of the street pavement and are to be set with the top end one-fourth inch below the top of the pavement. Once installed, the top of the pin shall be marked (punched) to record the actual location of the point.

Permanent markers, where indicated hereon in positions other than in the public street centerline, are to be one-inch diameter, thirty-inch long, solid iron pins. Pins are to be set to monument the points indicated, and set with the top end flush with the surface of the ground and then capped with an aluminum cap stamped EMHT INC. Once installed, the top of the cap shall be marked (punched) to record the actual location of the point.

SURVEYED & PLATTED  
By

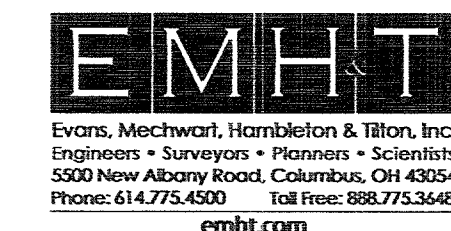

We do hereby certify that we have surveyed the above premises, prepared the attached plat, and that said plat is correct. All dimensions are in feet and decimal parts thereof.

- o = Iron Pin (See Survey Data)
- = MAG Nail to be set
- ⊙ = Permanent Marker (See Survey Data)

By *Matthew A. [Signature]*  
Professional Surveyor No. 7865

12 SEP 16  
Date