

LOCATION MAP

NOT TO SCALE

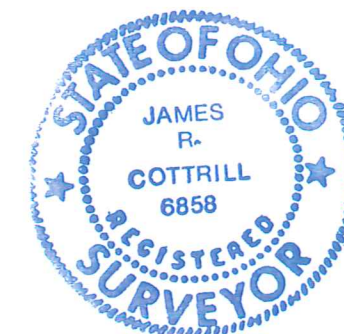
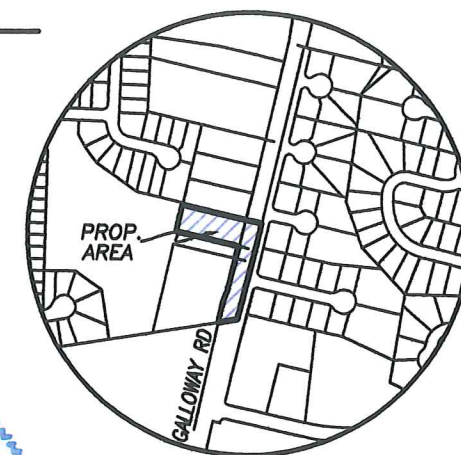

THIS EXHIBIT WAS PREPARED FROM RECORD INFORMATION FROM THE FRANKLIN COUNTY ENGINEER, RECORDED AND AUDITOR, AND IS NOT INTENDED FOR THE TRANSFER OF REAL PROPERTY.

James R. Cottrill

DATE: 01/10/19

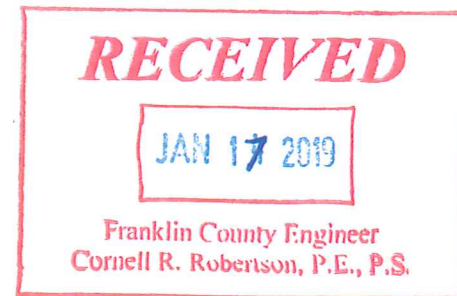

ANNEXATION
PLAT & DESCRIPTION
ACCEPTABLE
CORNELL R. ROBERTSON, P.E., P.S.
FRANKLIN COUNTY ENGINEER

By *FRW* Date *1/17/19*

EXISTING CORP. LINE
CASE No. 21-95
ORDINANCE: 2095-95
RECORDED IN: 30484B-14

CITY OF COLUMBUS
120.00'(D)
N 11°03'00" E 115'(D)
PRAIRIE TOWNSHIP

PRAIRIE TOWNSHIP
CITY OF COLUMBUS

N 78°57'00" W 275'(D)

263.70'(D)

DEED REFERENCE
SHERRY J REED
INSTR No.
201608090103666
0.725 ACRES AS RECORDED
0.83 ORIGINAL ACRES
PARCEL 240-002333-00

JOHN BOYD JR & CAROLE M PAIZ
INSTR No. 200109100209197
0.724 ACRES

S 78°57'00" E 275'(D)

PROPOSED CORP. LINE

W. LINE OF GALLOWAY RD

115'(D)
W. LINE OF GALLOWAY RD

114.86'(D)

FRANKLIN COUNTY COMM.
OR 25622J13
0.105 ACRE

FRANKLIN COUNTY COMM.
OR 25572I03
0.105 ACRE

VMS 5243

VMS 1474

POB

ROTATION IS BASED ON
CENTERLINE OF GALLOWAY RD.
AS DESCRIBED IN OR 25622J13

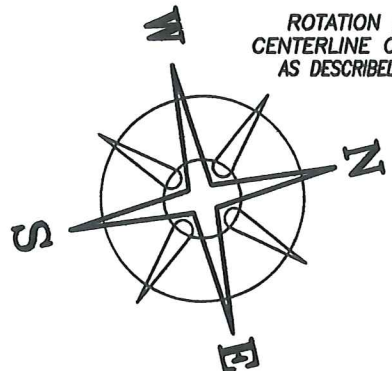

GLEN F & MARIAN L HYMER
OR 13912B13
1.273 ORG. ACRES

GLEN F & MARIAN L HYMER
OR 10592H16
1.00 ORG. ACRES

VMS 5243
VMS 5242

S 81°07'04" W
S 13°08'47" E
CITY OF COLUMBUS
ORD: 0689-200011

N 13°08'47" E
W. LINE OF GALLOWAY RD
N 18°51'25" E
PROPOSED CORP. LINE

VMS 5243

VMS 1474

GALLOWAY ROAD (WIDTH VARIES)

PORTION OF STREET DEDICATED TO FRANKLIN COUNTY COMMISSIONERS BY GREENE COUTRIE SUB'D RECORDED IN PB 49 PG 31
434.19'(D)

EXISTING CORP LINE, ORDINANCE: 282-68, RECORDED IN: VOL 145 PG 6

E. LINE OF GALLOWAY RD AS DEDICATED BY GREENE COUTRIE SUB'D

LEGEND

EXISTING CITY OF COLUMBUS CORP. LINE
PROPOSED CITY OF COLUMBUS CORP. LINE
AREA TO BE ANNEXED

ANNEXATION INFORMATION

TOTAL PERIMETER OF ANNEXATION AREA IS 1,584.7± FEET, OF WHICH 962.5± FEET IS CONTIGUOUS WITH THE CITY OF COLUMBUS, HAVING 61% CONTIGUITY.

COTTRILL SURVEYING, INC

8256 State Route 207 NE, Mt. Sterling, Ohio 43143
Office: (740) 869-3811 Fax: (740) 869-3846
www.cottrillsurveying.com

**ANNEXATION TO CITY OF COLUMBUS,
VMS 1474 & 5243, PRAIRIE TWP,
FRANKLIN COUNTY, STATE OF OHIO.**

SURVEYED FOR: **SHERRY J REED**

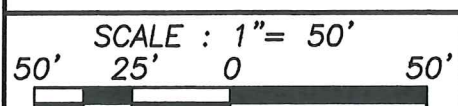

SCALE : 1" = 50'
DATES: 12/2018, 01/2019
JOB No. S181205
CREW: N/A
DWN BY: NC