

**EXHIBIT 'D'**

**PUMP STATION ELECTRIC EASEMENT**

Situated in within part of Farm Lot No. 4 of the First Quarter of Township 3 North, Range 20 West, of the United States Military District and being located in the Township of Concord, County of Delaware, and State of Ohio and known as being a 20 feet wide Electric Easement within the lands conveyed to the City of Columbus by instrument of record in Deed Vol. 160/160/159 at Page 494/15/406 of the Delaware County Recorder's Office, said Electric Easement being more fully described as follows:

Commencing at the intersection of the centerline of South Section Line Road (R/W Varies) with the centerline of Home Road (R/W Varies), said intersection being the northeasterly corner of Farm Lot No. 4 and the southeasterly corner of Farm Lot No. 3;

Thence N87°23'58"W along the line between Farm Lot No. 4 and Farm Lot No. 3, for a distance of 487.26 feet to a point, said point being the intersection of the centerline of Home Road with the centerline of State Route 257;

Thence S44°59'21"W for a distance of 207.71 feet to a point on the westerly right of way line of said State Route 257, said point being on the Proposed Electric Easement Line, said point also being the **TRUE PLACE OF BEGINNING** for the tract of land described herein;

Thence S61°14'32"E along the westerly right of way line of said State Route 257 and along the Proposed Electric Easement Line, for a distance of 22.43 feet to a point;

Thence S55°41'07"W and leaving the westerly right of way line of said State Route 257, and proceeding through the Grantor's land along the Proposed Electric Easement Line, for a distance of 244.89 feet to a point on the Proposed Pump Station Easement Line;

Thence N12°00'00"W continuing through the Grantor's land along the Proposed Electric Easement Line and Pump Station Easement Line, for a distance of 21.62 feet to a point;

Thence N55°41'07"E, continuing through the Grantor's land along the Proposed Electric Easement Line, for a distance of 226.52 feet to the **TRUE PLACE OF BEGINNING** and containing within said bounds 4,714.2 square feet or 0.108 acres of land more or less, and being within Auditor's Parcel No. 500-310-01-002-000.

'NORTH' for this description is based on the Ohio State Plane Co-ordinate System, North Zone NAD83/2011.

The above description was prepared by Richard John Swan, Registered Professional Surveyor No. 6574 of ms consultants, inc., in November 2015, and is based on a survey made by **ms consultants, inc.** In April 2014.

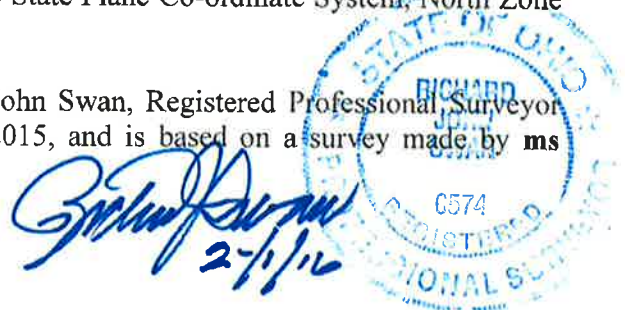





# ELECTRIC EASEMENT EXHIB

PART OF FARM LOT 4  
 1ST QUARTER - TWP. 3 NORTH - RANGE 20 WEST  
 UNITED STATES MILITARY DISTRICT  
 CONCORD TOWNSHIP, COUNTY OF DELAWARE, STATE OF OHIO



I HEREBY CERTIFY THAT, TO THE BEST OF MY KNOWLEDGE AND BELIEF, THIS PLAT IS A TRUE DELINEATION OF A SURVEY MADE BY ms consultants, inc. IN MAY 2014.

*Richard John Swan*  
 RICHARD JOHN SWAN  
 REGISTERED PROFESSIONAL SURVEYOR No. 6574

4/16/15  
 DATE

PREPARED BY  
 ms consultants, inc.  
 ENGINEERS, ARCHITECTS, PLANNERS  
 300 EAST FEDERAL STREET  
 YOUNGSTOWN, OHIO 44603  
 PH (937) 744-5941 FAX (937) 744-5946



# Parcel Map Check Report

<b>Client:</b>	<b>Prepared by:</b>
Client	Preparer
Client Company	Your Company Name
Address 1	123 Main Street
Date: 11/11/2015 11:55:40 AM	

---

Parcel Name: Site 1 - Parcel: ELECTRICAL EASEMENT 11-11-15

Description:

Process segment order counterclockwise: False

Enable mapcheck across chord: False

North: 193,857.01' East: 1,790,694.84'

Segment# 1: Line

Course: S 61°14'32.06" E Length: 22.43'

North: 193,846.22' East: 1,790,714.50'

Segment# 2: Line

Course: S 55°41'07.06" W Length: 244.89'

North: 193,708.16' East: 1,790,512.23'

Segment# 3: Line

Course: N 12°00'00.00" W Length: 21.62'

North: 193,729.31' East: 1,790,507.74'

Segment# 4: Line

Course: N 55°41'07.06" E Length: 226.52'

North: 193,857.01' East: 1,790,694.83'

Perimeter: 515.47'

Area: 4,714.16Sq.Ft. or 0.108 AC

Error Closure: 0.00

Course: N 84°08'23.77" W

Error North : 0.000

East: -0.004

Precision 1: 515,460,000.00