

ANNEXATION
PLAT & DESCRIPTION
ACCEPTABLE
CORNELL R. ROBERTSON, P.E., P.S.
FRANKLIN COUNTY ENGINEER

By FARLON Date 07/13/2018

PROPOSED ANNEXATION OF 369.2 ACRES
FROM: NORWICH TOWNSHIP AND BROWN TOWNSHIP
TO: CITY OF COLUMBUS
SITUATED IN THE STATE OF OHIO, COUNTY OF FRANKLIN, TOWNSHIPS OF NORWICH AND BROWN,
BEING LOCATED IN THE VIRGINIA MILITARY SURVEY NO. 6635 AND 6636

RECEIVED

7/13/2018

Franklin County Engineer
Cornell R. Robertson, P.E., P.S.

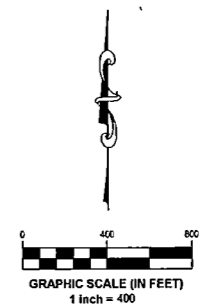

NO.	DATE	REVISION DESCRIPTION

- A) RAYMOND THOMAS RUGGIERO AND MARY M. RUGGIERO
IN: 201205186070251
0.717 ACRES
PID: 200-001825-00
- B) RENNER RD REALTY, LLC
IN: 201805100058117
0.717 ACRES
PID: 200-003188-00
- C) SAMANTHA K. FITZSIMMONS
IN: 201511060158381
1.225 ACRES
PID: 200-001819-00
- D) NORRIS E. JEFFERS
D B 3263 PG. 266
1.224 ACRES
PID: 200-001823-00
- E) RYAN MATHEW SIMON AND JESSICA ELAINE SHEPHARD
IN: 201710110141612
1.002 ACRES
PID: 200-001122-00
- F) KATHRYN E. DAVIS AND GAYMON M. DAVIS
IN: 200604070065259
1.100 ACRES
P.I.D. 200-002716-00
- G) TONY A. KLOSS
IN: 200105140105573
IN: 200404060075158
0.159 ACRES
P.I.D. 200-002878-00
- H) LAWRENCE P. FINNERAN TR
IN: 201711130158706
LOT 15
GREEN MEADOW EXTENSION NO. 1
P.B. 42, PG. 38
P.I.D. 200-002733-00
- I) JANE E. RAUSCH AND SCOTT E. BORDNER
O.R. 35061 PG. A05
0.551 ACRES
PID: 200-003462-00
- J) KELLY CALLAND
IN: 200412080279200
0.551 ACRES
PID: 200-003460-00
- K) ALEX C. ANDERSON AND MARY W. ANDERSON
O.R. 04303 PG. C11
0.551 ACRES
PID: 200-003461-00
- L) CRAIG K. TUTHILL
IN: 201705110063661
0.551 ACRES
PID: 200-003464-00
- M) AARON L. DEYARMON AND CECELIA H. DEYARMON
IN: 201507150095791
0.567 ACRES
PID: 200-002706-00
- N) TRAVIS W. SMITH
IN: 200803110037256
0.564 ACRES
PID: 200-002695-00
- O) JEFFREY B. LARSON
IN: 20121030000629
0.527 ACRES
PID: 200-002696-00
- P) MARCIA S. HOLLMEYER TR ET AL
O.R. 2227F05
RESERVE A
GREEN MEADOW EXTENSION NO. 1
P.B. 42, PG. 38
P.I.D. 200-002734-00
- Q) STATE OF OHIO
D.B. 2905, PG. 585
- R) FRANKLIN COUNTY COMMISSIONERS
PARCEL 11-WD
IN: 200908100116554
- S) FRANKLIN COUNTY COMMISSIONERS
IN: 200905100083910

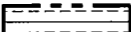

LEGEND

—————	EXIST. CORP. LINE
—————	EXIST. PARCEL LINE
—————	EXIST. ROAD CENTER LINE
- - - - -	PROP. ANNEXATION CORP. LINE
	PROP. AREA TO BE ANNEXED FROM NORWICH TWP. (344.5 ACRES)
	PROP. AREA TO BE ANNEXED FROM BROWN TWP. (24.7 ACRES)

THIS EXHIBIT WAS PREPARED FROM RECORD INFORMATION FROM THE FRANKLIN COUNTY ENGINEER, RECORDER, AND AUDITOR'S OFFICE, AND IS NOT INTENDED FOR THE TRANSFER OF REAL PROPERTY

CONTIGUITY NOTE:
TOTAL PERIMETER OF ANNEXATION AREA IS 26,696-FT. OF WHICH 2923-FT ARE CONTIGUOUS WITH THE CITY OF COLUMBUS AND BY ORDINANCE NUMBER 880-01 AND ORDINANCE NUMBER 1687-2013, GIVING 11% CONTIGUITY

SURVEYOR:
CESO, INC.
2800 CORPORATE EXCHANGE DR, STE 160
COLUMBUS, OH 43231
PHONE: 614.794.7080
CONTACT: JEFFREY A. MILLER, PS



JEFFREY A. MILLER
OHIO S. #7211

Jeffrey A. Miller

RENNER ROAD ANNEXATION

DATE: JUNE 2018
JOB NO.: 755257
DESIGN: N/A
DRAWN: ALB
CHECKED: JAM
SHEET NO. 1