

MAP ANNEXATION AN03-044 22.8 Acres in Plain Township Robert D. Patrella

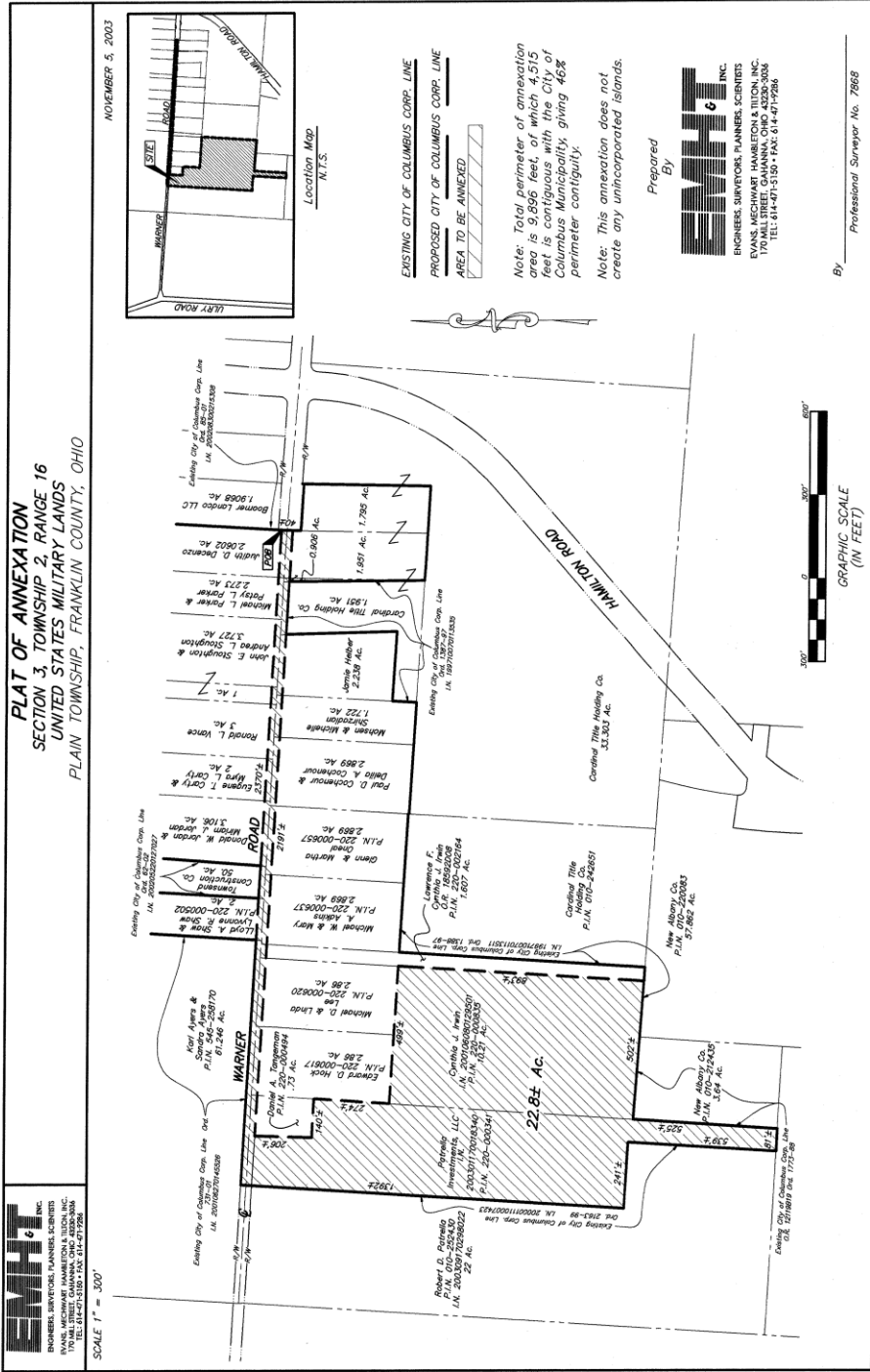

PLAT OF ANNEXATION
SECTION 3, TOWNSHIP 2, RANGE 16
UNITED STATES MILITARY LANDS
PLAIN TOWNSHIP, FRANKLIN COUNTY, OHIO

SCALE 1" = 300'
 NOVEMBER 5, 2003

EMMT
 ENGINEERS, SURVEYORS, PLANNERS, SCIENTISTS
 170 WALL STREET, COLUMBUS, OHIO 43201-3004
 TEL: 614-471-5150 • FAX: 614-471-9286

Prepared By
EMMT
 ENGINEERS, SURVEYORS, PLANNERS, SCIENTISTS
 170 WALL STREET, COLUMBUS, OHIO 43201-3004
 TEL: 614-471-5150 • FAX: 614-471-9286

By _____
 Professional Surveyor No. 7868

Note: Total perimeter of annexation area is 9.86 miles. The 22.88 feet is contiguous with the City of Columbus Municipality, giving 46% perimeter contiguity.
 Note: This annexation does not create any unincorporated islands.

Existing City of Columbus Corp. Line
 Proposed City of Columbus Corp. Line
 Area to be Annexed

Robert D. Patrella
 P.L.N. 070-228240
 I.N. 2002/06/08/028240
 I.N. 2002/06/08/028240
 P.L.N. 070-228240
 I.N. 2002/06/08/028240

Dominion Homes / Patrella Investment Annexation / 20031009/31009amx5

D:\PROJECT\20031009\DWG\31009AMX5.DWG - PLOTTED BY JBUSBY - NOVEMBER 05, 2003 - 7:19 AM