

CITY OF DEPART PUBLIC TRANSPORT BROUGHTON A IMPRC OUTERBELT ST.

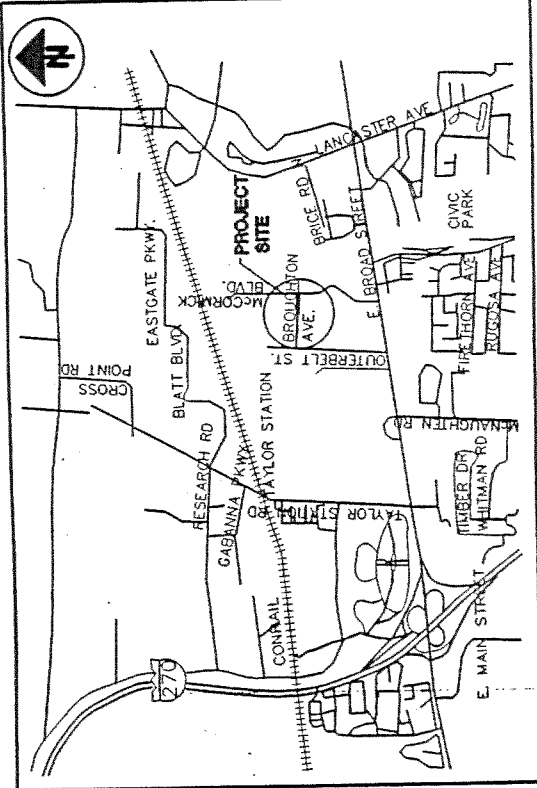

LOCATION MAP
(NOT TO SCALE)

PORTION TO BE IMPROVED
INTERSTATE & DIVIDED HIGHWAY
OTHER ROADS

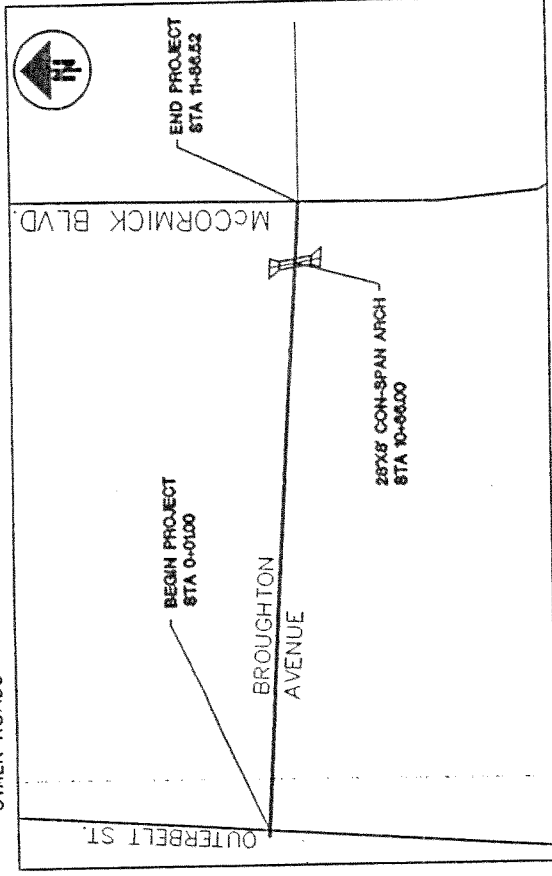

VICINITY MAP
GRAPHIC SCALE



LATITUDE 39°59'12" N
LONGITUDE 82°49'34" W

DATA

AVERAGE DAILY TRAFFIC - UNKNOWN
LENGTH OF IMPROVEMENT - 1174.52 FT.

LEGEND

SEE SHEET NO 14

PLANS PREPARED BY:



Woolpert, Inc.
2760 Airport Drive
Suite 140
Columbus, Ohio 43219-2284
TEL: 614.476.6000
FAX: 614.476.6625
www.woolpert.com

Michael W. Pugh
REGISTERED ENGINEER

DATE
10/11/05



- TITLE.....
- SCHEMATIC PLAN.....
- TYPICAL SECTIONS.....
- GENERAL NOTES.....
- MAINTENANCE OF TRAFFIC.....
- MAINTENANCE OF TRAFFIC.....
- STORMWATER POLLUTION P.....
- GENERAL SUMMARY.....
- RESURFACING PLAN WITH S.....
- PLAN AND PROFILES WITH.....
- CULVERT PROFILE.....
- CROSS SECTIONS.....
- INTERSECTION DETAILS/RAI.....
- STORM PROFILES.....
- SIGNING AND PAVEMENT M.....
- CULVERT DETAILS.....
- LIGHTING PLANS.....

ODOT STANDARD CONSTR

CITY OF COLUMBUS	
1441 DR. A	AA-S101
2135 DR. A	AA-S112
2180 DR. A	AA-S133
2300 DR. A	AA-S139
2319 DR. A	AA-S150