

GALLOWAY RIDGE

SECTION 8 PART 2

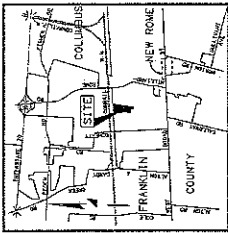

VICINITY MAP
NOT TO SCALE

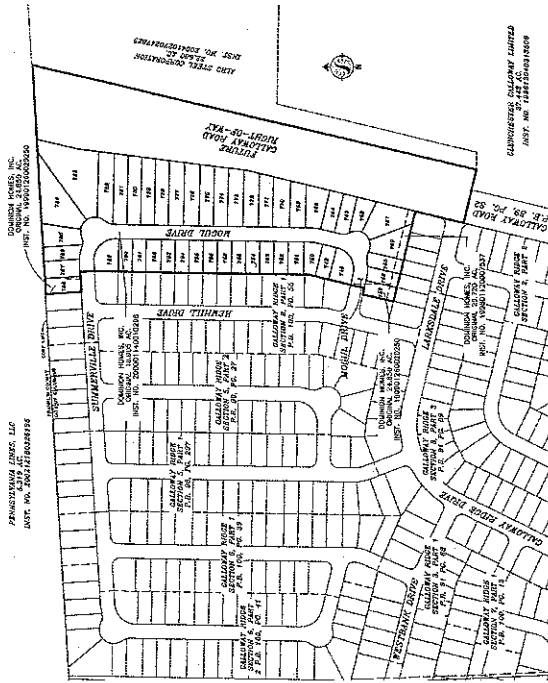

BACKGROUND MAP
SCALE: 1"=200'

STATE IN THE STATE OF OHIO, COUNTY OF FRANKLIN, CITY OF COLUMBUS, LYING IN VICTORIA PLANT SURVEY 7536 AND 7630, CONTAINING 19.235 ACRES OUT OF THE 26.868 ACRES OF THE SAID AREA TRACT CONNECTED TO COMMON HOMES, INC. AN OHIO CORPORATION, AND COMMON HOMES, INC. AN OHIO CORPORATION, BY INSTRUMENTS RECORDED IN COMMON HOMES, INC. AN OHIO CORPORATION RECORDS, RESPECTIVELY, AND BEING IN ALL, 19.235 ACRES, INCLUDING 0.010 ACRES OF COMMON HOMES, INC. AN OHIO CORPORATION, BEING THE SECTION 8 OF TOWN OF FRANKLIN COUNTY, OHIO. HEREBY CERTIFY THAT THIS PLAT CORRECTLY REPRESENTS ITS GALLOWAY RIDGE SECTION 8 PART 2, AND THAT THE SAID PLAT IS A TRUE AND CORRECT REPRESENTATION OF THE SAID LAND AS SHOWN BY THE SURVEY SHOWN HEREON AND NOT HERETOFORE DEBATED.

AS SHOWN BY THE SURVEY SHOWN HEREON, THE SAID PLAT IS THE CONTINUATION OF THE SURFACE OF THE GROUND AND WHERE NECESSARY FOR THE CONSTRUCTION, OPERATION, AND MAINTENANCE OF THE SAID PLAT, THE SAID PLAT IS SUBJECT TO ALL RIGHTS AND INTERESTS OF SERVICE CONNECTIONS TO ALL ADJACENT LOTS AND LANDS, AND FOR STORM WATER DRAINAGE.

THE EASEMENTS SHOWN HEREON OVERSIE THE PLATTED AREA ARE WITHIN THOSE TRACTS OF LAND OWNED BY SAID COMMON HOMES, INC. AND ARE DESIGNATED FOR THE USES AND PURPOSES SHOWN HEREON AND ARE SUBJECT TO ALL RIGHTS AND INTERESTS OF SERVICE CONNECTIONS TO ALL ADJACENT LOTS AND LANDS, AND FOR STORM WATER DRAINAGE.

IN ACCORDANCE WITH THE TERMS AND REGULATIONS OF SECTION 163.02(C) OF THE COLUMBIAN CITY CODES, THERE IS HEREBY OFFERED AN EASEMENT TO THE CABLE TELEVISION COMPANY, BEING THE ONLY AUTHORIZED REPRESENTATIVE OF THE DEVELOPER DESIGNATING THE PROPERTY DESCRIBED IN THIS PLAT, HEREBY AGREES THAT GRANITOR WILL RELOCATE THE CABLE TELEVISION SERVICE TO THE SAID PLAT AND SHALL BE RESPONSIBLE FOR THE COST OF THE RELOCATION AND/OR LEASING IN THE FUTURE AGAINST THE PROPERTY DESIGNATED HEREON WHICH RESULT FROM GRANITOR'S CONVERSION OF THE PROPERTY FROM AGRICULTURAL USE TO BE DESIGNATED BY ITS ONLY AUTHORIZED REPRESENTATIVE.

OWNER/DEVELOPER
COMMON HOMES, INC.
5000 LITTLE CHERRY BLVD.
DELEA, OHIO 43081-2525
BY *[Signature]*
MATTIE L. CALAWAN
VICE PRESIDENT OF LAND DEVELOPMENT

STATE OF OHIO 33
THE FOREGOING PLAT WAS ACKNOWLEDGED BEFORE ME THIS 25th DAY OF MAY 2003 BY SAID COMMON HOMES, INC. AN OHIO CORPORATION, AND COMMON HOMES, INC. AN OHIO CORPORATION, ON BEHALF OF THE COMMON OWNERS OF THE SAID PLAT OF _____ ACRES.
IN WITNESS WHEREOF, I HAVE HEREUNTO SET MY HAND AND AFFIXED MY SEAL
THIS 25th DAY OF _____ 2003.

MY COMMISSION EXPIRES May 4, 2003
APPROVED THIS 1st DAY OF July 2003
BY *[Signature]*
LARRY DUNN, JR.
CHAIRMAN AND JOINTLY SEWERAGES
COMMISSIONER, FRANKLIN COUNTY, OHIO

APPROVED THIS _____ DAY OF _____ 2003
CITY ENGINEER, COLUMBIAN, OHIO
APPROVED THIS _____ DAY OF _____ 2003
DIRECTOR OF PUBLIC SERVICE
COLUMBUS, OHIO

NO. _____ DAY OF _____ 2003 BY ORDINANCE
ARE ACCEPTED AS SHOWN BY THE COUNCIL OF THE CITY OF COLUMBUS, OHIO.
IN WITNESS WHEREOF, I HAVE HEREUNTO SET MY HAND AND AFFIXED MY SEAL
THIS _____ DAY OF _____ 2003.

CITY CLERK, COLUMBUS, OHIO
TRANSFERRED THIS _____ DAY OF _____ 2003
AUDITOR, FRANKLIN COUNTY, OHIO
DEPUTY AUDITOR, FRANKLIN COUNTY, OHIO

FILED FOR RECORD THIS _____ DAY OF _____ 2003 AT _____ OHIO
FILE NO. _____
RECORDED FRANKLIN COUNTY, OHIO

RECORDED THIS _____ DAY OF _____ 2003 PLAY BOOK _____ PAGE _____
DEPUTY RECORDER, FRANKLIN COUNTY, OHIO

NOTES:
ALL OF GALLOWAY RIDGE SECTION 8 PART 2 IS WITHIN ZONE 2, AREAS UNDESIGNED TO BE OUTSIDE THE ZONE FLOODPLAIN AS DETERMINED ON FEMA FLOOD INSURANCE RATE JOMAG0204K WITH EFFECTIVE DATE OF JUNE 17, 2008.

NO DETERMINATION HAS BEEN MADE BY THE DEPARTMENT OF BUILDING AND ZONING SERVICES, CITY OF COLUMBUS, AS TO WHETHER THE AREA PROPOSED TO BE PLATTED CONFORMS WITH THE CITY OF COLUMBUS ZONING ORDINANCES AND THE ZONING CODES OR ENDS ON THIS SITE. THE CITY OF COLUMBUS APPROVAL OF THIS PLAT OF GALLOWAY RIDGE SECTION 8 PART 2 DOES NOT IMPLY ANY APPROVAL FOR THE DEVELOPMENT OF THE SITE AS IT MAY PERTAIN TO WETLANDS.

THE EASEMENT AND STORM SEWER PLAN TOGETHER WITH THE MASTER DRAINAGE PLAN FOR GALLOWAY RIDGE SECTION 8 SHOW A DESIGN THAT WOULD PROTECT LOTS 745-752, 753-754, 755-756, 757-758, 759-760, 761-762, 763-764, 765-766, 767-768, 769-770, 771-772, 773-774, 775-776, 777-778, 779-780, 781-782, 783-784, 785-786, 787-788, 789-790, 791-792, 793-794, 795-796, 797-798, 799-800, 801-802, 803-804, 805-806, 807-808, 809-810, 811-812, 813-814, 815-816, 817-818, 819-820, 821-822, 823-824, 825-826, 827-828, 829-830, 831-832, 833-834, 835-836, 837-838, 839-840, 841-842, 843-844, 845-846, 847-848, 849-850, 851-852, 853-854, 855-856, 857-858, 859-860, 861-862, 863-864, 865-866, 867-868, 869-870, 871-872, 873-874, 875-876, 877-878, 879-880, 881-882, 883-884, 885-886, 887-888, 889-890, 891-892, 893-894, 895-896, 897-898, 899-900, 901-902, 903-904, 905-906, 907-908, 909-910, 911-912, 913-914, 915-916, 917-918, 919-920, 921-922, 923-924, 925-926, 927-928, 929-930, 931-932, 933-934, 935-936, 937-938, 939-940, 941-942, 943-944, 945-946, 947-948, 949-950, 951-952, 953-954, 955-956, 957-958, 959-960, 961-962, 963-964, 965-966, 967-968, 969-970, 971-972, 973-974, 975-976, 977-978, 979-980, 981-982, 983-984, 985-986, 987-988, 989-990, 991-992, 993-994, 995-996, 997-998, 999-1000.

AT THE TIME OF PLATTING, THE LAND INDICATED HEREON IS SUBJECT TO REQUIREMENTS OF THE CITY OF COLUMBUS ZONING ORDINANCE NO. 291-021A.

BASES OF BEARINGS:
THE BEARINGS SHOWN ON THE ATTACHED PLAT ARE BASED ON THE BEARING OF THE MERIDIAN AS DETERMINED BETWEEN FRANKLIN COUNTY ENGINEER'S MONUMENTS THROUGH AND THROUGHOUT BY THE FRANKLIN COUNTY ENGINEER'S OFFICE.

CERTIFICATION:
WE DO HEREBY CERTIFY THAT WE HAVE SURVEYED THE ATTACHED PREMISES, AND THAT THE SAID SURVEY IS A TRUE AND CORRECT REPRESENTATION OF THE SAID PREMISES. WE SHOW ON THE PLAT THE BEARINGS AND DISTANCES OF ALL PERMANENT MONUMENTS AND CURVES ALONG CURVES ARE CHORD BEARINGS. PERMANENT MONUMENTS ARE SHOWN AT THE CORNERS OF THE SAID PLAT AND ARE INDICATED BY THE FOLLOWING SYMBOLS:
PERMANENT MONUMENTS (PREVIOUSLY SET)
PERMANENT MONUMENTS



STATNEC CONSULTING SERVICES INC.

PREPARED BY: *[Signature]*
PROFESSIONAL SURVEYOR NO. S-8063

1600 LAKE SHORE DRIVE
COLUMBUS, OHIO 43204
(614) 461-1999 FAX 614-461-4857



Stattec

Copyright © 2003 Stattec, Inc. All rights reserved. Stattec, Inc. is a registered trademark of Stattec, Inc. in the United States and other countries. Stattec, Inc. is a registered trademark of Stattec, Inc. in the United States and other countries. Stattec, Inc. is a registered trademark of Stattec, Inc. in the United States and other countries.

FORWARDED BY:

Skantec
 1600 LAKE SHORE DRIVE
 COLUMBUS, OHIO 43264
 (614) 464-4000 FAX: (614) 464-4000

Checked, Approved and sealed as per the provisions of the applicable laws and regulations of the State of Ohio.
 Notary Public for the State of Ohio, Commission Expires 06/30/2010
 Authority by Notary to Notarize:

LEGEND:
 PERMANENT MONUMENTS
 PERMANENT MONUMENTS



ALDO STEEL CORPORATION
 INST. NO. 200410270247929

CLEVERIDGE GALLOWAY LIMITED
 INST. NO. 198312404918606

NOTE - TEMPORARY VEHICLE TURNAROUND FACILITY LOCATED WITHIN THE CITY OF COLUMBUS, OHIO IS HEREBY GRANTED AN INDETERMINATE EASEMENT FOR VEHICULAR TURNAROUND USE BY THE PUBLIC IN AND OVER THE AREA OF LAND SHOWN HEREON. THE EASEMENT SHALL BE GRANTED TO THE CITY OF COLUMBUS, OHIO FOR THE PERIOD OF FIVE (5) YEARS FROM THE DATE OF THE RECORDING OF THIS INSTRUMENT. THE EASEMENT SHALL BE EXTENDED FOR AN ADDITIONAL FIVE (5) YEARS IF THE EXISTING FACILITY OF SUMMITVILLE DRIVE, NO. 200410270247929 SHALL BE EXTENDED FOR AN ADDITIONAL FIVE (5) YEARS. THE EASEMENT SHALL BE EXTENDED FOR THE TEMPORARY TURNAROUND IS REMOVED AND THE PAVEMENT FOR THE TURNAROUND IS REPAVED AND APPROVED BY THE CITY OF COLUMBUS, OHIO FOR PUBLIC ROADWAY USE.

FRANKLIN COUNTY
 26094
 0039 LINE

PENNSYLVANIA LINES, LLC
 INST. NO. 200218180262188

FUTURE GALLOWAY ROAD RIGHT-OF-WAY
 7,685 AC.

S70°39'W 187.82'

N86°26'42"E 808.00'

GALLOWAY ROAD
 (50' R/W)
 P.B. 88, PG. 32
 N76°07'59"W 192.70'

MOULDER DRIVE (60' R/W)
 60' R/W

HEMHILL DRIVE (50' R/W)

LARKSDALE DRIVE

GALLOWAY RIDGE
 SECTION 8, PART 3
 STREET 2 OF 2

