

# HILLIARD WOODS PART 1

Situated in the State of Ohio, County of Franklin, City of Columbus, and in Virginia Military Survey Number 544, containing 13.489 acres of land, more or less, said 13.489 acres being part of those tracts of land conveyed to **WILSON ROAD DEVELOPERS, LLC**, by deed of record in Instrument Number 201206210088885, Recorder's Office, Franklin County, Ohio.

The undersigned, **WILSON ROAD DEVELOPERS, LLC**, an Ohio limited liability company, by **NATIONWIDE REALTY INVESTORS, LTD**, its sole member and manager, by **JAMES ROST**, Vice President, owner of the lands platted herein, duly authorized in the premises, does hereby certify that this plat correctly represents its **"HILLIARD WOODS PART 1"**, a subdivision containing Lots numbered 1 to 46, both inclusive, and an area designated as Reserve "A", does hereby accept this plat of same and dedicates to public use, as such, all of the Court, Drives, Road and Way shown hereon and not heretofore dedicated.

Easements are hereby reserved in, over and under areas designated on this plat as "Easement" or "Drainage Easement". Each of the aforementioned designated easements permit the construction, operation and maintenance of all public and quasi public utilities, above, beneath and on the surface of the ground, and where necessary, for the construction, operation and maintenance of service connections to all adjacent lots and lands and for storm water drainage. Within those areas designated "Drainage Easement" on this plat, an additional easement is hereby reserved for the purpose of constructing, operating and maintaining major storm water drainage swales and/or other above ground storm water drainage facilities. No above grade structures, dams or other obstructions to the flow of storm water runoff are permitted within Drainage Easement areas as delineated on this plat unless approved by the City of Columbus, Division of Sewerage and Drainage.

In Witness Whereof, **JAMES ROST**, Vice President of said **NATIONWIDE REALTY INVESTORS, LTD**, as sole member and manager of said **WILSON ROAD DEVELOPERS, LLC**, has hereunto set his hand this 19 day of April, 2013.

Signed and Acknowledged  
In the presence of:

*[Signature]*  
*[Signature]*

**WILSON ROAD DEVELOPERS, LLC**  
By: **NATIONWIDE REALTY INVESTORS, LTD**, its sole member and manager

By *[Signature]*  
**JAMES ROST** Vice President

STATE OF OHIO  
COUNTY OF FRANKLIN ss:

Before me, a Notary Public in and for said State, personally appeared **JAMES ROST**, Vice President of said **NATIONWIDE REALTY INVESTORS, LTD**, as sole member and manager of said **WILSON ROAD DEVELOPERS, LLC**, who acknowledged the signing of the foregoing instrument to be his voluntary act and deed and the voluntary act and deed of said **WILSON ROAD DEVELOPERS, LLC**, for the uses and purposes expressed herein.

In Witness Thereof, I have hereunto set my hand and affixed my official seal this day of April, 2013.

My commission expires \_\_\_\_\_  
Notary Public, State of Ohio

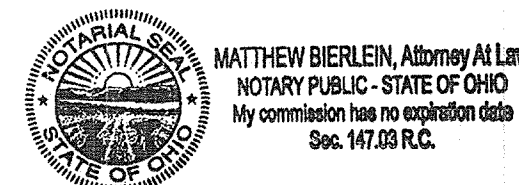

Approved this 22<sup>nd</sup> day of APRIL, 2013.

*[Signature]*  
**Tracie A. Davis** ASBC  
Director, Department of Building and Zoning Services, Columbus, Ohio

Approved this 23<sup>rd</sup> day of April, 2013.

*[Signature]*  
**Hassan Y. Zahra** ASCE  
City Engineer/Administrator, Division of Design and Construction, Columbus, Ohio

Approved this 24<sup>th</sup> day of April, 2013.

*[Signature]*  
**Mark Belton**  
Director, Department of Public Service, Columbus, Ohio

Approved and accepted this \_\_\_\_\_ day of \_\_\_\_\_, 20\_\_\_\_, by Ordinance No. \_\_\_\_\_ wherein all of the Court, Drives, Road and Way shown dedicated hereon is accepted as such by the Council for the City of Columbus, Ohio.

In witness thereof, I have hereunto set my hand and affixed my seal the \_\_\_\_\_ day of \_\_\_\_\_, 20\_\_\_\_.

\_\_\_\_\_  
City Clerk, Columbus, Ohio

Transferred this \_\_\_\_\_ day of \_\_\_\_\_, 20\_\_\_\_.

\_\_\_\_\_  
Auditor, Franklin County, Ohio

\_\_\_\_\_  
Deputy Auditor, Franklin County, Ohio

Filed for record this \_\_\_\_\_ day of \_\_\_\_\_, 20\_\_\_\_ at \_\_\_\_\_ M. Fee \$\_\_\_\_\_.

\_\_\_\_\_  
Recorder, Franklin County, Ohio

File No. \_\_\_\_\_

Recorded this \_\_\_\_\_ day of \_\_\_\_\_, 20\_\_\_\_.

\_\_\_\_\_  
Deputy Recorder, Franklin County, Ohio

Plat Book \_\_\_\_\_, Pages \_\_\_\_\_

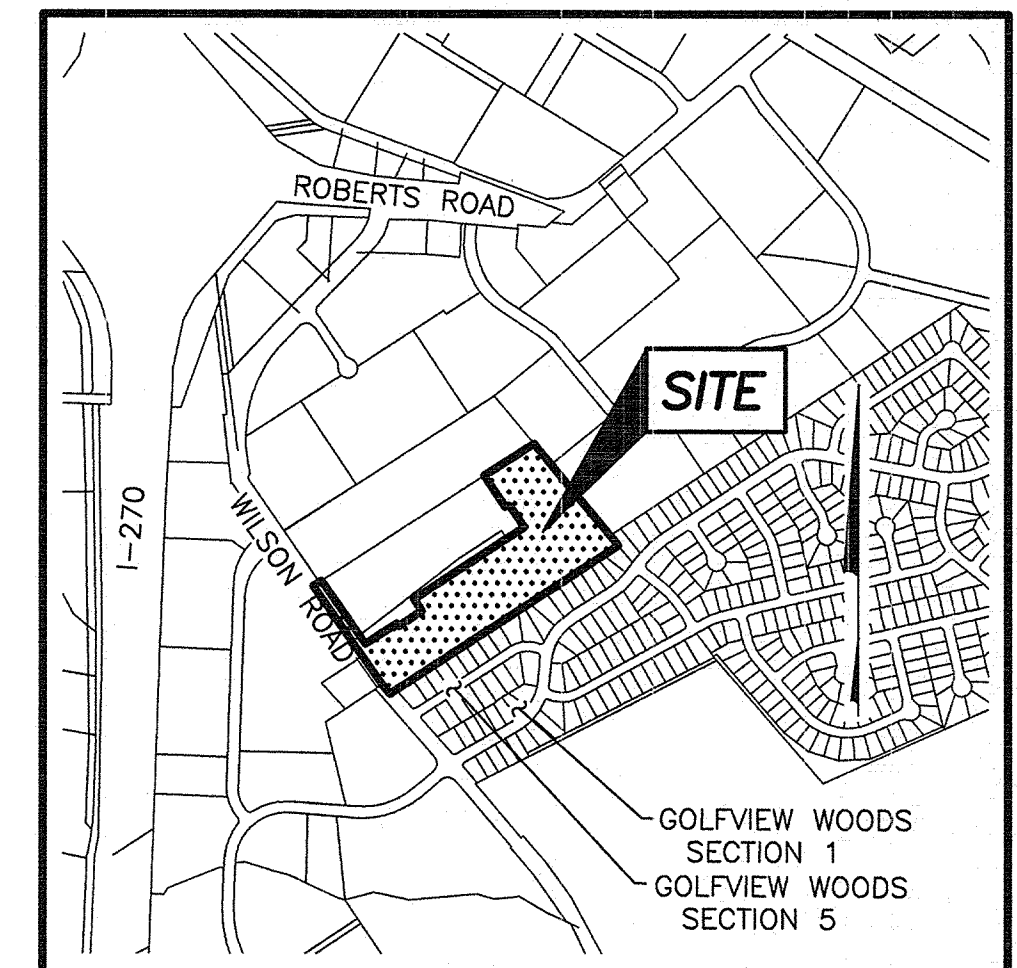

LOCATION MAP AND BACKGROUND DRAWING  
SCALE: 1" = 1000'

**SURVEY DATA:**

**BASIS OF BEARINGS:** The bearings shown hereon, are based on the Ohio State Plane Coordinate System, South Zone, NAD83 (NSRS2007). Said Bearings originated from a field traverse which was tied (referenced) to said coordinate system by GPS observations and observations of selected Franklin County Geodetic Survey Monuments FCGS 6654 RESET and FCGS 5407. The portion of the centerline of Wilson Road, having a bearing of North 34°37'08" West, is the designated "basis of bearing" for this plat.

**SOURCE OF DATA:** The sources of recorded survey data referenced in the plan and text of this plat, are the records of the Recorder's Office, Franklin County, Ohio.

**IRON PINS:** Iron pins, where indicated hereon, unless otherwise noted, are to be set and are iron pipes thirteen sixteenths inch inside diameter, thirty inches long with a plastic plug placed in the top end bearing the initials EMHT INC.

**PERMANENT MARKERS:** Permanent markers, where indicated hereon in the public street centerline, are to be one-inch diameter, thirty-inch long, solid iron pins. Pins are to be set to monument the points indicated, are to be set after the construction/installation of the street pavement and are to be set with the top end one-fourth inch below the top of the pavement. Once installed, the top of the pin shall be marked (punched) to record the actual location of the point.

Permanent markers, where indicated hereon in positions other than in the public street centerline, are to be one-inch diameter, thirty-inch long, solid iron pins. Pins are to be set to monument the points indicated, and set with the top end flush with the surface of the ground and then capped with an aluminum cap stamped "EMHT INC." Once installed, the top of the cap shall be marked (punched) to record the actual location of the point.

SURVEYED & PLATTED  
BY



We do hereby certify that we have surveyed the above premises, prepared the attached plat, and that said plat is correct. All dimensions are in feet and decimal parts thereof.

- = Iron Pin (See Survey Data)
- = MAG Nail to be set
- ⊙ = Permanent Marker (See Survey Data)

By *[Signature]*  
Professional Surveyor No. 8250

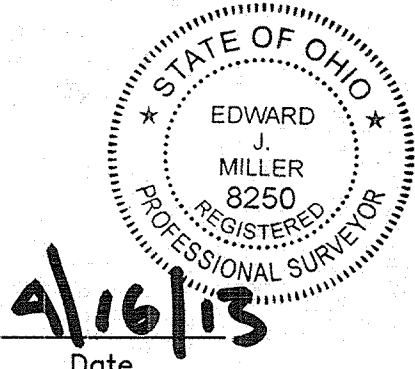

9/16/13  
Date