

MAP ANNEXATION AN04-009 55.9 Acres in Prairie Township Cypress Wesleyan Church

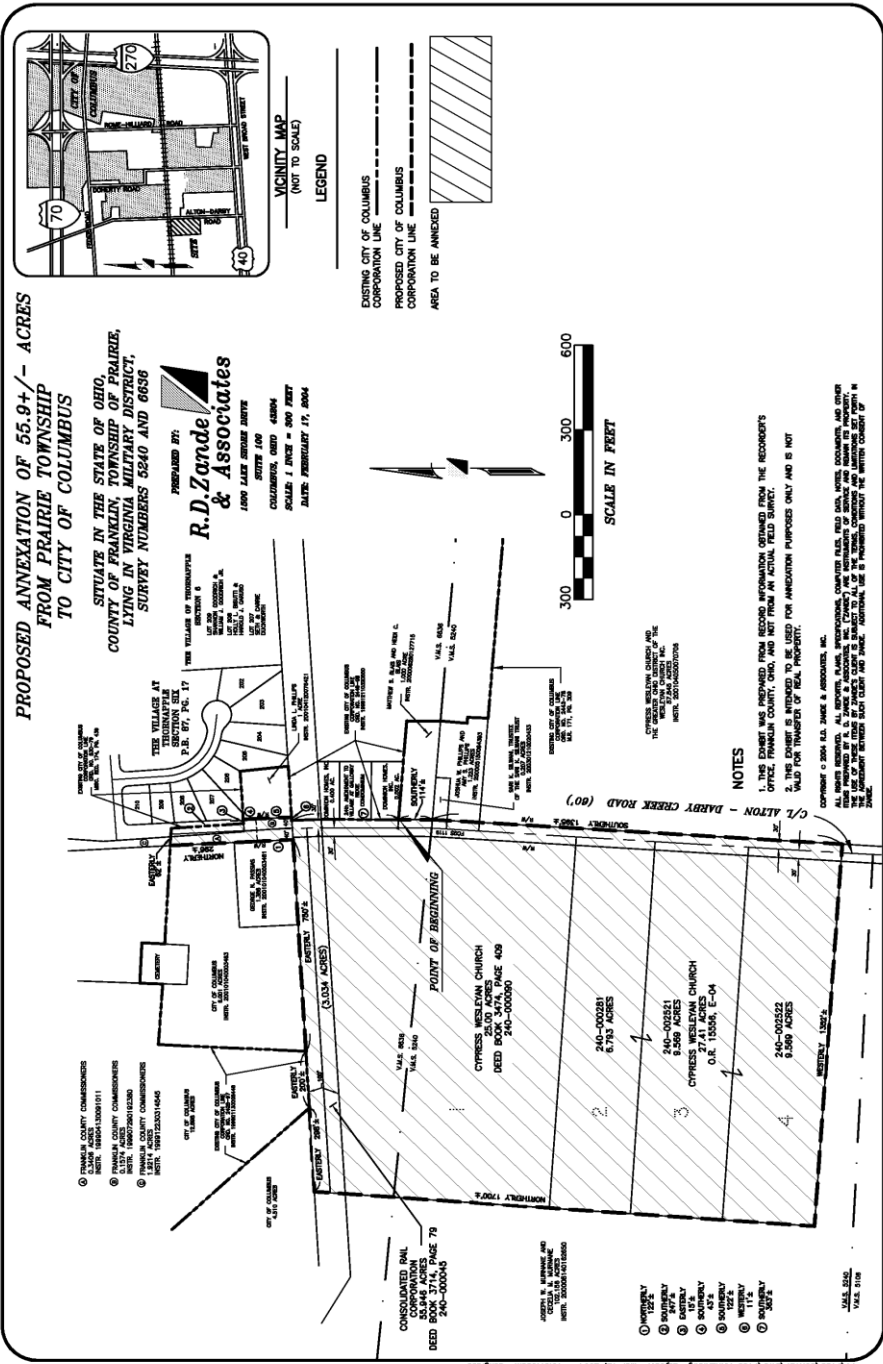

**PROPOSED ANNEXATION OF 55.9+/- ACRES
FROM PRAIRIE TOWNSHIP
TO CITY OF COLUMBUS**

SITUATE IN THE STATE OF OHIO,
 COUNTY OF FRANKLIN, TOWNSHIP OF PRAIRIE,
 LYING IN VIRGINIA MILITARY DISTRICT,
 SURVEY NUMBERS 6240 AND 6636

R.D.Zande & Associates
 PREPARED BY:
 1800 LAKE SHELBOURNE DRIVE
 SUITE 100
 COLUMBUS, OHIO 43240
 SCALE: 1 INCH = 200 FEET
 DATE: FEBRUARY 17, 2004



- NOTES**
1. THIS EXHIBIT WAS PREPARED FROM RECORD INFORMATION OBTAINED FROM THE RECORDER'S OFFICE, FRANKLIN COUNTY, OHIO, AND NOT FROM AN ACTUAL FIELD SURVEY.
 2. THIS EXHIBIT IS INTENDED TO BE USED FOR ANNEXATION PURPOSES ONLY AND IS NOT VALID FOR PURPOSES OF REAL PROPERTY.

COPYRIGHT © 2004 R.D. ZANDE & ASSOCIATES, INC.
 ALL RIGHTS RESERVED. ALL RIGHTS, PLANS, SPECIFICATIONS, COMPUTED PLANS, FIELD BOOKS, DOCUMENTS, AND OTHER INFORMATION ARE THE PROPERTY OF R.D. ZANDE & ASSOCIATES, INC. NO PART OF THIS EXHIBIT MAY BE REPRODUCED OR TRANSMITTED IN ANY FORM OR BY ANY MEANS, ELECTRONIC OR MECHANICAL, INCLUDING PHOTOCOPYING, RECORDING, OR BY ANY INFORMATION STORAGE AND RETRIEVAL SYSTEM, WITHOUT THE WRITTEN CONSENT OF R.D. ZANDE & ASSOCIATES, INC.

- ① FRANKLIN COUNTY COMMISSIONERS
METAL: 1089112320110445
- ② FRANKLIN COUNTY COMMISSIONERS
METAL: 1089112320110445
- ③ FRANKLIN COUNTY COMMISSIONERS
METAL: 1089112320110445

- ① UNDEVELOPED
- ② RESIDENTIAL
- ③ COMMERCIAL
- ④ INDUSTRIAL
- ⑤ AGRICULTURE
- ⑥ OPEN SPACE
- ⑦ WETLANDS
- ⑧ WATER
- ⑨ UTILITIES
- ⑩ TRANSPORTATION

SCALE: 1" = 200'
 DATE: 02/17/04