

Z:\20-0045-76\DWG\PRODUCTION DRAWINGS\SURVEY\20-0045-76 easement vacation exhibit.dwg Page 1 Feb 24, 2022 10:51:49am jurray

### GRAPHIC SCALE



1 inch = 40 feet



**Easement  
Vacation  
0.143 Acres**

City of Columbus, Franklin County, Ohio  
Between Inlot 325 and Inlot 324 and  
being the same portion of land  
described as Vacated Elm Street (Ord.  
1494-92) as recorded in Plat of the  
Town of Columbus as recorded in Deed  
Book "F", Pg. 332, destroyed by fire,  
replatted in Plat Book 3, Page 247,  
also represented in Plat Book 14, Page  
27, Franklin County Recorder's Office

This exhibit is based on information obtained  
from the Franklin County Auditor's and  
Recorder's Office and information obtained from  
an actual field survey conducted in March of  
2020.

The basis of bearings used for this exhibit are  
based on the NAD83 Ohio State Plane Coordinate  
System, South Zone (NSRS 2007) which  
determines the bearing for a portion of the  
easterly right-of-way line of N. High Street to  
be N08°09'37"W.

ADVANCED CIVIL DESIGN, INC.

  
Date: 2/24/22  
Douglas R. Hock, P.S. 7661

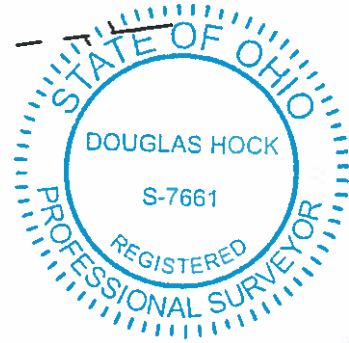

DRAWN BY: JRM	JOB NO.: 20-0045-76
DATE: 2/25/2022	CHECKED BY: DRB

  
**ADVANCED  
CIVIL DESIGN**  
ENGINEERS SURVEYORS

781 Science Boulevard ~ Suite 100  
Gahanna, Ohio 43230  
ph 614.428.7750  
fax 614.428.7755

